



# WLL12-B5281

PHOTOELECTRIC SENSORS

**SICK**  
Sensor Intelligence.



Illustration may differ

## Ordering information

Type	part no.
WLL12-B5281	1011687

Other models and accessories → [www.sick.com/](http://www.sick.com/)

## Detailed technical data

### Features

<b>Dimensions (W x H x D)</b>	15 mm x 49 mm x 53 mm
<b>Housing design (light emission)</b>	Rectangular
<b>Sensing range max.</b>	0 mm ... 280 mm <sup>1)</sup>
<b>Sensing range</b>	0 mm ... 280 mm <sup>1)</sup>
<b>Type of light</b>	Infrared light
<b>Light source</b>	LED
<b>Adjustment</b>	Potentiometer

<sup>1)</sup> Object with 90% remission (based on standard white, DIN 5033).

### Mechanics/electronics

<b>Supply voltage</b>	10 V DC ... 30 V DC
<b>Ripple</b>	< 5 V <sub>pp</sub>
<b>Current consumption</b>	35 mA <sup>1)</sup>
<b>Switching mode</b>	Light/dark switching
<b>Response time</b>	≤ 360 μs <sup>2)</sup>
<b>Connection type</b>	Male connector M12, 5-pin
<b>Housing material</b>	Metal, zinc diecast
<b>Optics material</b>	Plastic, PMMA
<b>Enclosure rating</b>	IP67
<b>Ambient operating temperature</b>	-25 °C ... +60 °C
<b>Ambient temperature, storage</b>	-25 °C ... +70 °C

<sup>1)</sup> Without load.

<sup>2)</sup> Signal transit time with resistive load.

## Connection type

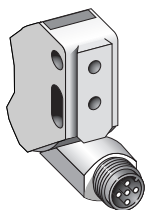

## Connection diagram

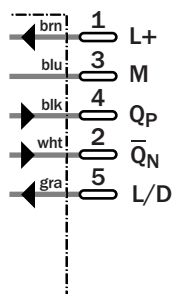

## Adjustments

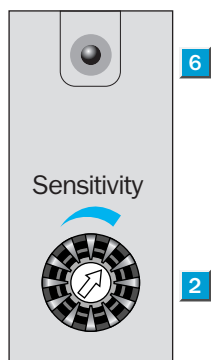

- ② sensitivity control
- ⑥ LED signal strength indicator

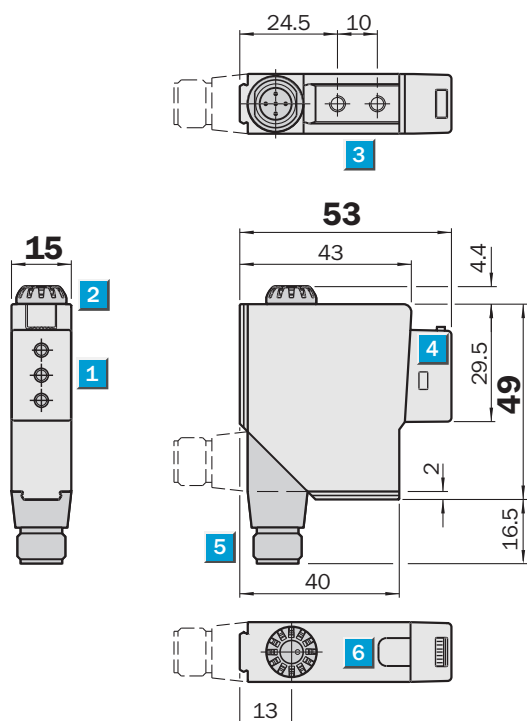

- ① Connector for fibre-optic cable
- ② sensitivity control
- ③ M4 threaded mounting hole – 4 mm depth
- ④ ADR
- ⑤ Connector not rotatable. Connector facing backwards on request
- ⑥ LED signal strength indicator

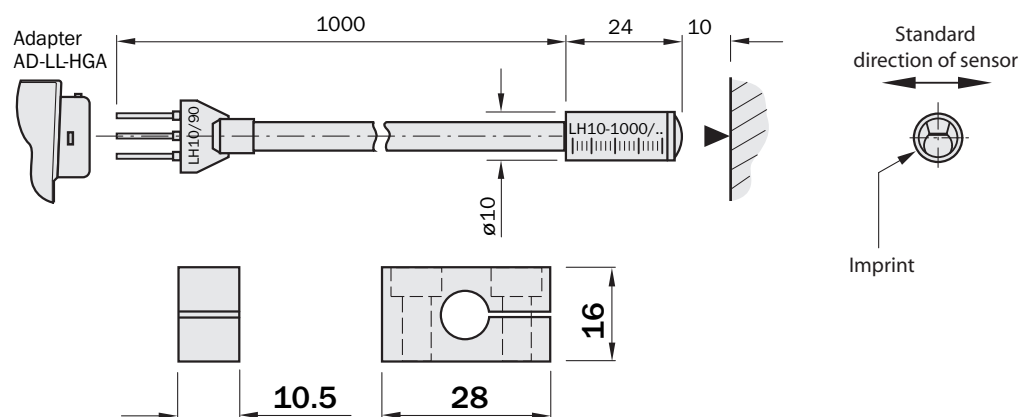

Scanning distance:	10 mm (- 1 mm), fixed
Light spot diameter:	approx. 2.5 x 3.5 mm
Switching hysteresis:	≤ 0.3 mm, based on standard white 90 % to standard black 6 %

## Dimensional drawing

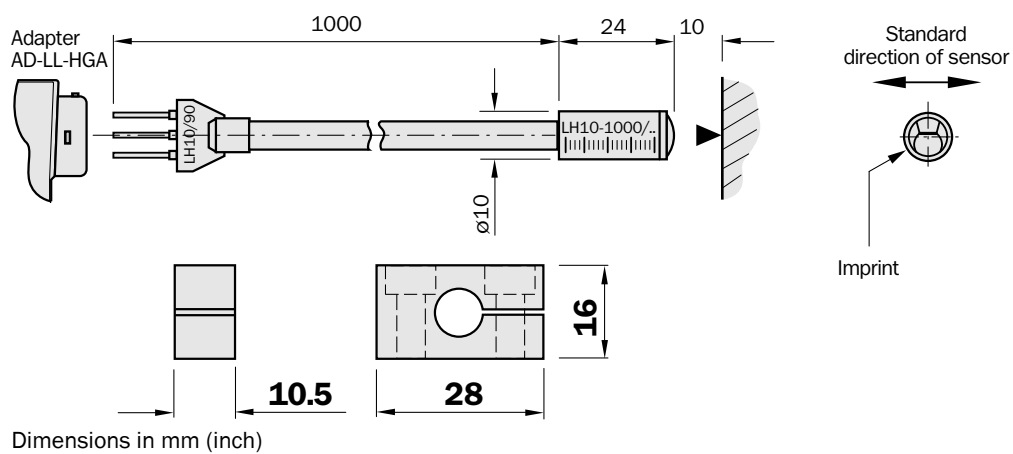

## SICK AT A GLANCE

SICK is one of the leading manufacturers of intelligent sensors and sensor solutions for industrial applications. A unique range of products and services creates the perfect basis for controlling processes securely and efficiently, protecting individuals from accidents and preventing damage to the environment.

We have extensive experience in a wide range of industries and understand their processes and requirements. With intelligent sensors, we can deliver exactly what our customers need. In application centers in Europe, Asia and North America, system solutions are tested and optimized in accordance with customer specifications. All this makes us a reliable supplier and development partner.

Comprehensive services complete our offering: SICK LifeTime Services provide support throughout the machine life cycle and ensure safety and productivity.

For us, that is “Sensor Intelligence.”

## WORLDWIDE PRESENCE:

Contacts and other locations –[www.sick.com](http://www.sick.com)