



# IDM241-411S

IDM

MOBILE HANDHELD SCANNERS

**SICK**  
Sensor Intelligence.



### Ordering information

| Type        | part no. |
|-------------|----------|
| IDM241-411S | 6080748  |

**Included in delivery:** Rechargeable battery (1)

Other models and accessories → [www.sick.com/IDM](http://www.sick.com/IDM)



### Detailed technical data

#### Features

|                           |  |
|---------------------------|--|
| <b>Application</b>        | Standard application                               |
| <b>Scanner design</b>     | Wireless variant                                   |
| <b>Sensor resolution</b>  | 1,280 px x 800 px                                  |
| <b>Light source</b>       | LED, Visible, Red, 660 nm                          |
| <b>Alignment aid</b>      | LED, green, 660 nm                                 |
| <b>Reading distance</b>   | 30 mm ... 400 mm                                   |
| <b>Scanning frequency</b> | 60 Hz  |
| <b>Code resolution</b>    | ≥ 0.07 mm <sup>1)</sup><br>≥ 0.13 mm <sup>2)</sup> |

<sup>1)</sup> Valid for Code 39.

<sup>2)</sup> Valid for Data Matrix code.

#### Mechanics/electronics

|                               |   |
|-------------------------------|---|
| <b>Supply voltage</b>         | 5 V DC, ± 5 %   |
| <b>Current consumption</b>    | Operation (charge status incl. base station): 750 mA<br>Standby: 175 mA |
| <b>Housing color</b>          | Black, Gray   |
| <b>Enclosure rating</b>       | IP52  |
| <b>Weight</b>                 | 230 g, without cable  |
| <b>Dimensions (L x W x H)</b> | 94 mm x 71 mm x 160 mm  |
| <b>MTBF</b>                   | 100,000 h   |

#### Performance

|                                 |  |
|---------------------------------|--|
| <b>Readable code structures</b> | 1D codes, 2D codes, Stacked  |
| <b>Bar code types</b>           | Code 39, Code 39 Full ASCII, Code 32, Code 128, GS1-128, Codabar, Code 11, Code 93, GS1 DataBar, Standard and Industrial 2 of 5, Interleaved & Matrix 2 of 5, IATA, UPC / EAN / JAN, UPC / EAN / JAN (with addition), Telepen, MSI/Plessey, UK/Plessey, Australian Post, China |

|                           |  |
|---------------------------|--|
|                           | Post, German Post, US Planet, US Postnet, British Post, Intelligent Mail, Japan Post, Korea Post, Dutch KIX Post, Posi LAPA 4 State Code |
| <b>2D code types</b>      | Data Matrix, MaxiCode, QR code, Aztec, MicroQR-Code, GS1 QR code, GS1 Data-Matrix  |
| <b>Stacked code types</b> | PDF417, MicroPDF417, Code 49, Code 16K, Composite, Codablock F   |
| <b>Battery power</b>      | Over 60,000 scans with full battery  |
| <b>Code buffer</b>        | 5,000 Codes (EAN, for scanning in batch mode), 100,000 Codes (EAN, for out of range scanning)  |

## Interfaces

|                               |   |
|-------------------------------|---|
| <b>Ethernet</b>               | ✓   |
| Type of fieldbus integration  | Optional, over external connection module CDF600-2  |
| <b>PROFINET</b>               | ✓   |
| Type of fieldbus integration  | Optional over external fieldbus module CDF600-2   |
| Function                      | PROFINET Single Port, PROFINET Dual Port  |
| <b>EtherCAT®</b>              | ✓   |
| Type of fieldbus integration  | Optional over external fieldbus module CDF600   |
| <b>Serial</b>                 | ✓ , RS-232  |
| <b>PROFIBUS DP</b>            | ✓   |
| Type of fieldbus integration  | Optional over external fieldbus module CDF600-2   |
| <b>USB</b>                    | ✓   |
| Function                      | Keyboard wedge, COM-Port emulation  |
| <b>Bluetooth</b>              | ✓   |
| Remark                        | Bluetooth™ V4.0, 2.402 ... 2.4830 GHz   |
| Function                      | Wireless operating range up to 100 m (free view), batch function for expansion of the wireless radius, up to seven scanners communicate with one base station |
| <b>Optical indicators</b>     | 2 LEDs (good read, charge of battery , radio connection status)   |
| <b>Acoustic indicators</b>    | Beeper, can be switched off   |
| <b>Vibration</b>              | No  |
| <b>Configuration software</b> | IDM Setup Tool  |

## Ambient data

|                                      |  |
|--------------------------------------|--|
| <b>Shock resistance</b>              | 25 drops from 1.8 m height on concrete |
| <b>Ambient operating temperature</b> | -10 °C ... +50 °C                      |
| <b>Storage temperature</b>           | -40 °C ... +70 °C                      |
| <b>Relative humidity</b>             | 95 %, Non-condensing                   |
| <b>Ambient light immunity</b>        | 100,000 lx                             |

## General notes

|                       |   |
|-----------------------|---|
| <b>Items supplied</b> | The rechargeable battery is included with delivery  |
| <b>Note</b>           | A base station, a connecting cable, and possibly also a power supply unit are required for commissioning.<br>Not free of paint wetting impairment substances. |

## Certificates

|                                       |   |
|---------------------------------------|---|
| <b>EU declaration of conformity</b>   | ✓ |
| <b>UK declaration of conformity</b>   | ✓ |
| <b>ACMA declaration of conformity</b> | ✓ |

|  |   |
|--|---|
| <b>China RoHS</b>  | ✓ |
| <b>Information according to Art. 3 of Data Act (Regulation EU 2023/2854)</b> | ✓ |
| <b>Bluetooth</b>   | ✓ |

## Classifications

|                       |          |
|-----------------------|----------|
| <b>ECLASS 5.0</b>     | 27280101 |
| <b>ECLASS 5.1.4</b>   | 27280101 |
| <b>ECLASS 6.0</b>     | 27280101 |
| <b>ECLASS 6.2</b>     | 27280101 |
| <b>ECLASS 7.0</b>     | 27280101 |
| <b>ECLASS 8.0</b>     | 27280101 |
| <b>ECLASS 8.1</b>     | 27280101 |
| <b>ECLASS 9.0</b>     | 27280101 |
| <b>ECLASS 10.0</b>    | 27280101 |
| <b>ECLASS 11.0</b>    | 27280101 |
| <b>ECLASS 12.0</b>    | 27280101 |
| <b>ETIM 5.0</b>       | EC002550 |
| <b>ETIM 6.0</b>       | EC002550 |
| <b>ETIM 7.0</b>       | EC002550 |
| <b>ETIM 8.0</b>       | EC002550 |
| <b>UNSPSC 16.0901</b> | 43211701 |

Connection diagram PROFINET IO/RT

PROFINET IO/RT

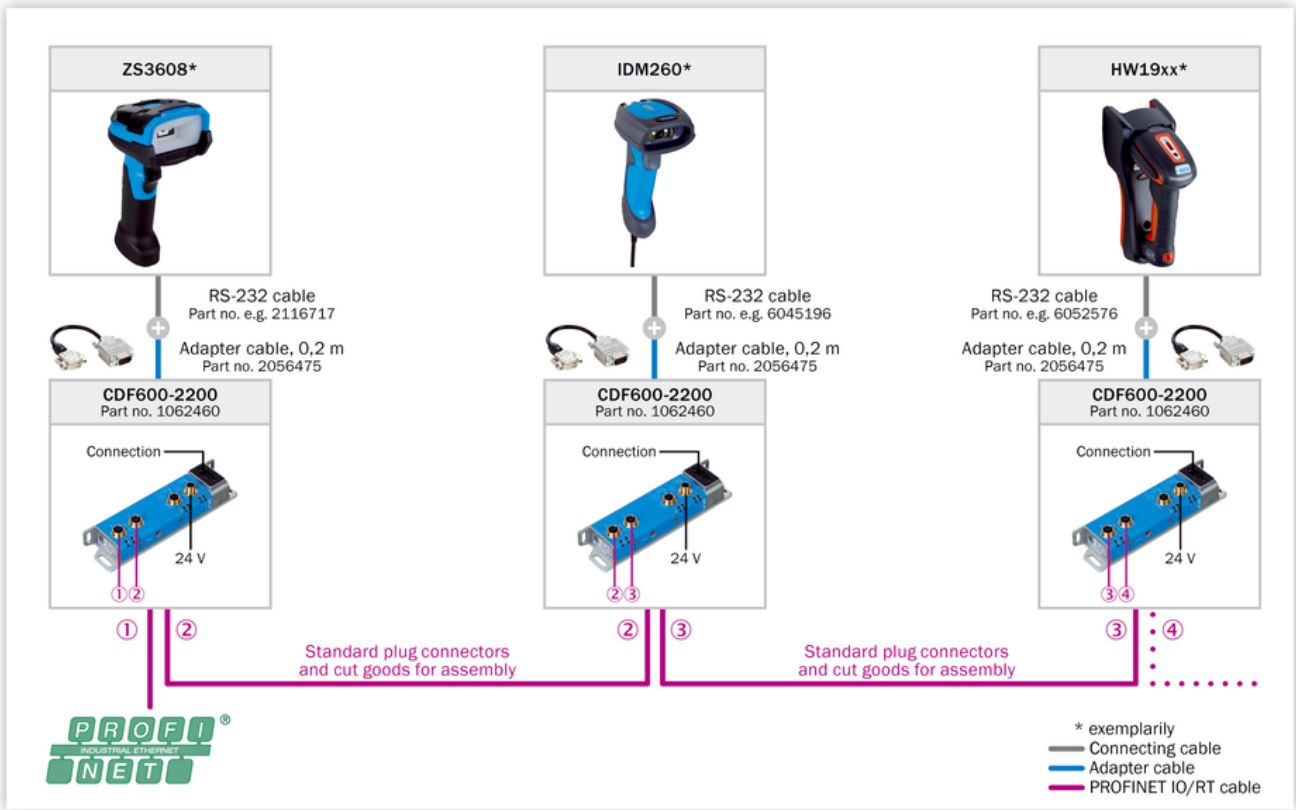

Connection diagram PROFIBUS DP

PROFIBUS DP

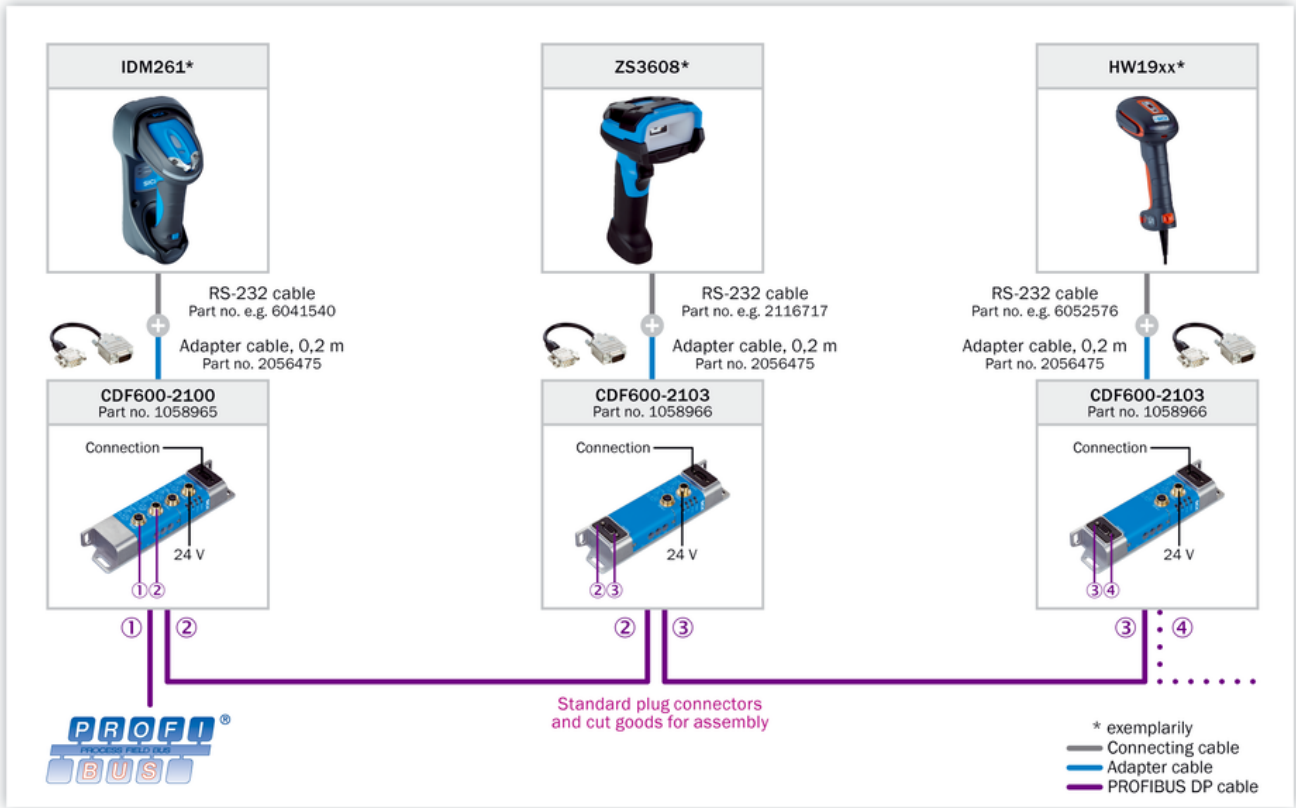

Connection diagram Ethernet TCP/IP

Ethernet TCP/IP

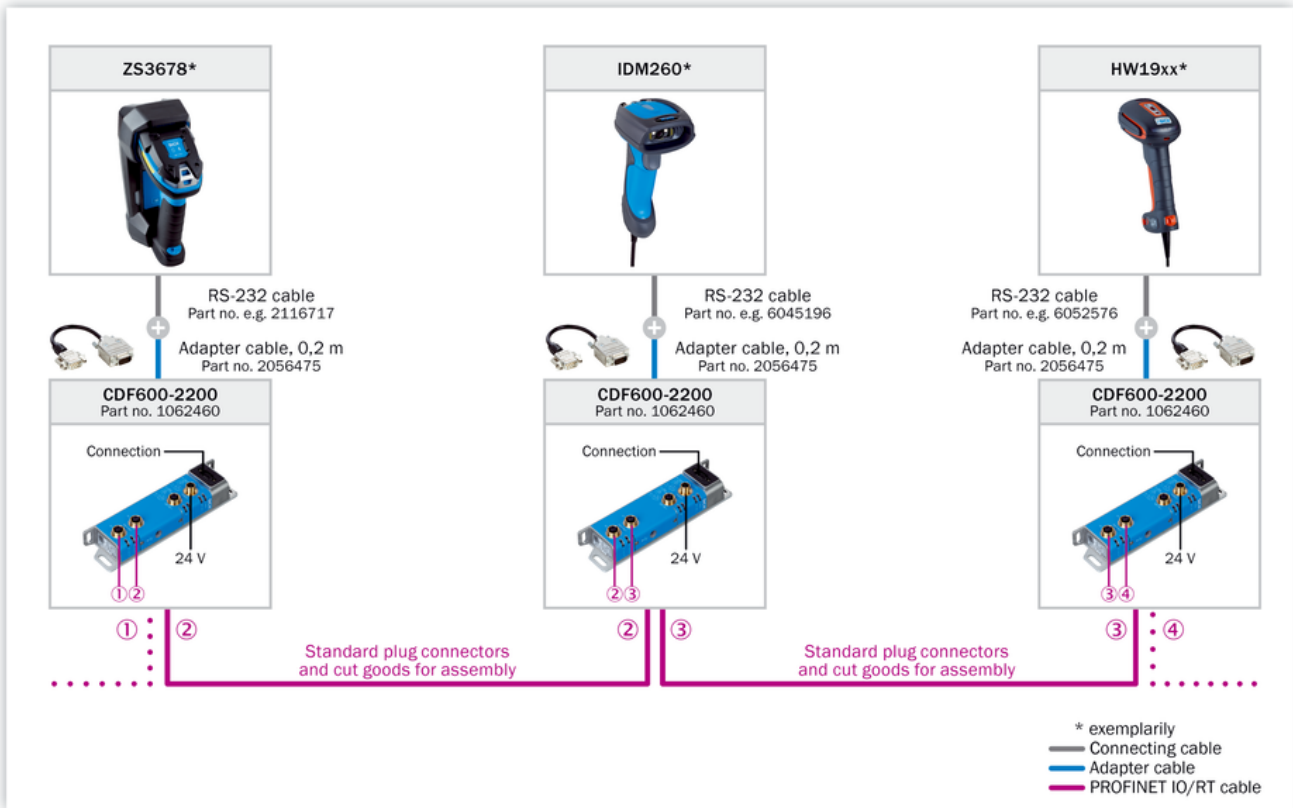

Connection diagram EtherCAT®

EtherCAT®

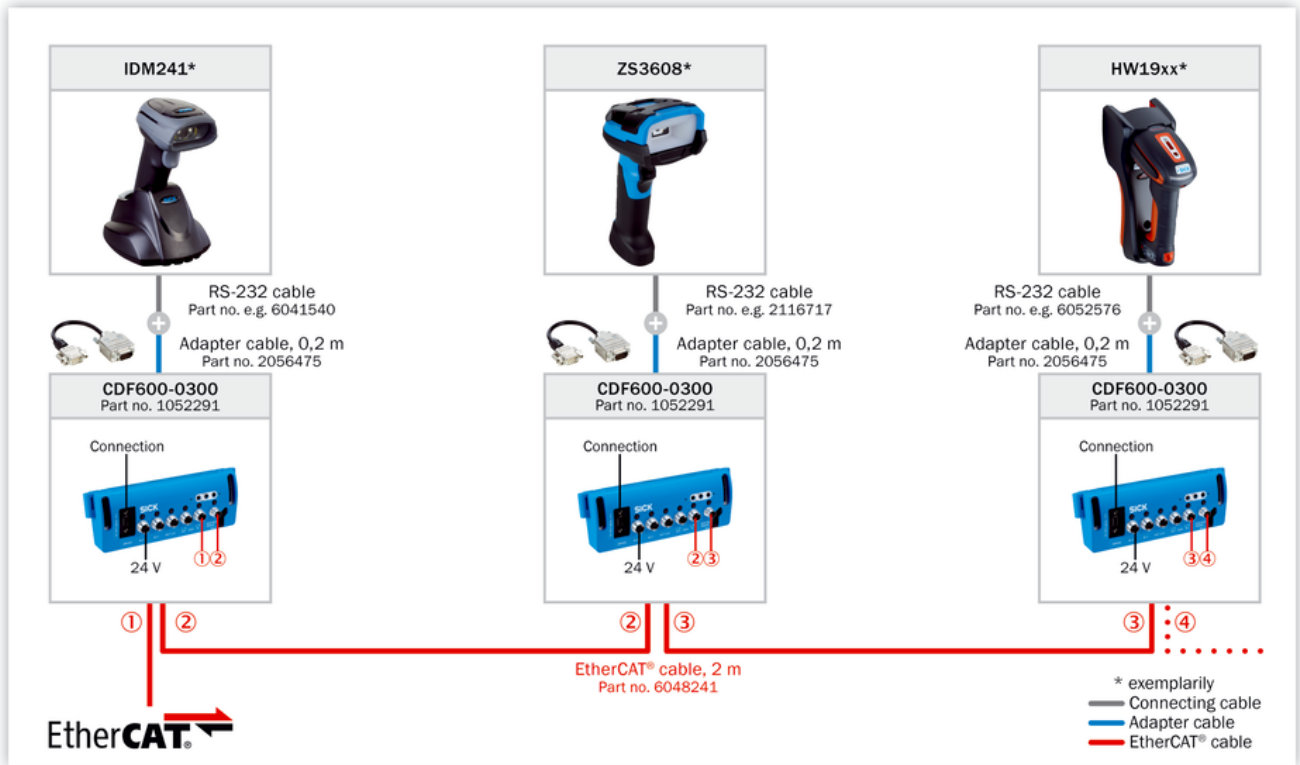

Connection diagram AUX looping

Looping-in via AUX

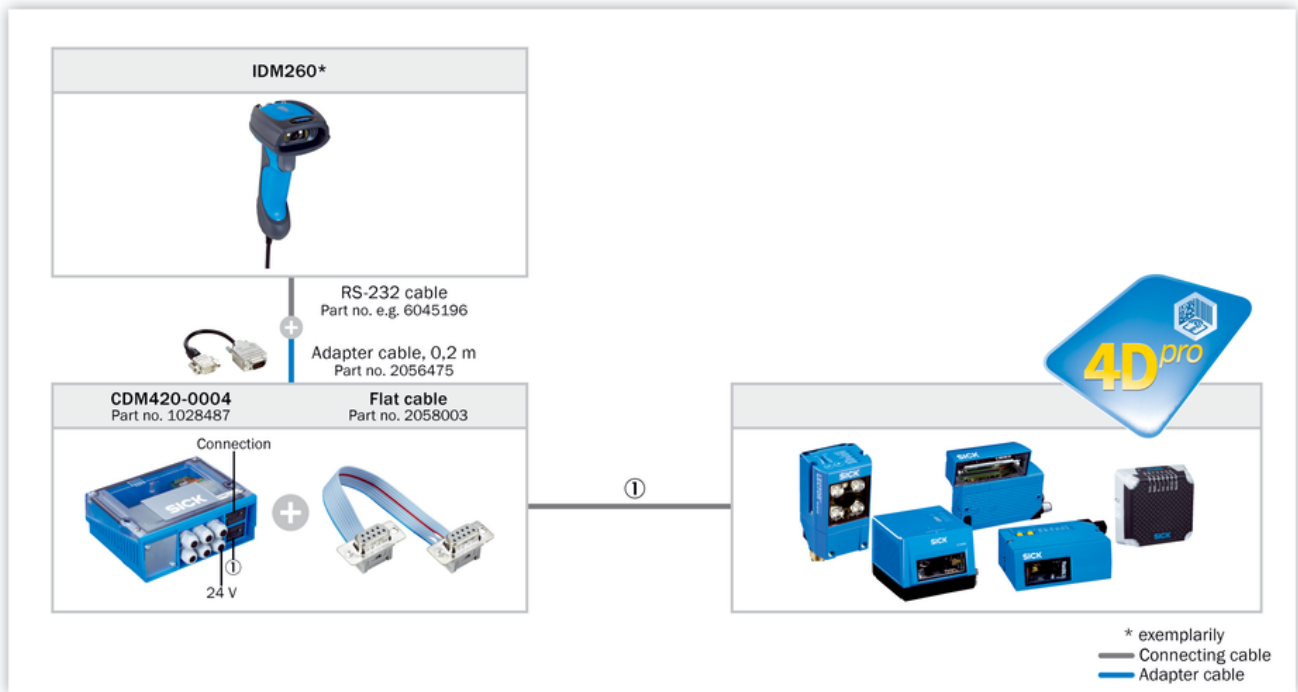





Selection Guide



\*) For EtherNet/IP third party gateway is required from e.g. Control or HMS (requires local sourcing).

## Recommended accessories

Other models and accessories → [www.sick.com/IDM](http://www.sick.com/IDM)

|  | Brief description   | Type                           | part no. |
|--|---|--------------------------------|----------|
| connectors and cables  |   |                                |          |
|   | <ul style="list-style-type: none"> <li>• <b>Connection type head A:</b> Male connector, D-Sub, 9-pin</li> <li>• <b>Connection type head B:</b> Male connector, D-Sub, 15-pin</li> <li>• <b>Items supplied:</b> Incl. 24V/5V DC converter</li> <li>• <b>Cable:</b> 0,3 m</li> <li>• <b>Note:</b> For handheld scanners to CDB620/CDM420/CDF600/CDF600-2, adapter AUX port</li> </ul>                             | YMH-DAC-C30XXMDSA9             | 2056475  |
|   | <ul style="list-style-type: none"> <li>• <b>Description:</b> USB, unshielded</li> <li>• <b>Connection type head A:</b> Male connector, USB-A</li> <li>• <b>Connection type head B:</b> Male connector, RJ50</li> <li>• <b>Signal type:</b> USB</li> <li>• <b>Cable:</b> 2 m, straightened cable</li> <li>• <b>Note:</b> For keyboard wedge or USB Com Port Emulation</li> </ul>                                 | Connection cable               | 6081864  |
|   | <ul style="list-style-type: none"> <li>• <b>Description:</b> RS-232, unshielded</li> <li>• <b>Connection type head A:</b> Female connector, D-Sub, 9-pin, straight</li> <li>• <b>Connection type head B:</b> Male connector, RJ50</li> <li>• <b>Signal type:</b> RS-232</li> <li>• <b>Cable:</b> 2 m, straightened cable</li> <li>• <b>Note:</b> Voltage via pin 9 or external power supply required</li> </ul> | Connection cable               | 6081865  |
| integration modules and adapters   |   |                                |          |
|   | <ul style="list-style-type: none"> <li>• <b>Description:</b> Connection kit for connecting a hand-held scanner to a PROFINET (Siemens) interface</li> </ul>   | Hand-held scanner PROFINET kit | 1101488  |
| Power supply units and power supply cables   |   |                                |          |
|  | <ul style="list-style-type: none"> <li>• <b>Input voltage:</b> 100 V AC ... 240 V AC</li> <li>• <b>Output voltage:</b> 5 V DC</li> <li>• <b>Output current:</b> 2 A</li> <li>• <b>Description:</b> Power supply unit, input 100 ... 240 V AC, output 5 V DC/2 A (required when using the RS-232-TTL cable, does not satisfy the medical standard EN 60601 / IEC 60601)</li> </ul>                               | Power supply unit              | 6036722  |

## SICK AT A GLANCE

SICK is one of the leading manufacturers of intelligent sensors and sensor solutions for industrial applications. A unique range of products and services creates the perfect basis for controlling processes securely and efficiently, protecting individuals from accidents and preventing damage to the environment.

We have extensive experience in a wide range of industries and understand their processes and requirements. With intelligent sensors, we can deliver exactly what our customers need. In application centers in Europe, Asia and North America, system solutions are tested and optimized in accordance with customer specifications. All this makes us a reliable supplier and development partner.

Comprehensive services complete our offering: SICK LifeTime Services provide support throughout the machine life cycle and ensure safety and productivity.

For us, that is “Sensor Intelligence.”

## WORLDWIDE PRESENCE:

Contacts and other locations –[www.sick.com](http://www.sick.com)