



# IDM141-411S USB Kit

IDM

MOBILE HANDHELD SCANNERS

**SICK**  
Sensor Intelligence.



## Ordering information

Type	part no.
IDM141-411S USB Kit	6080743

**Included in delivery:** Power supply unit (1), IDM141-411S (1), Connection cable (1), Base station (1)

Other models and accessories → [www.sick.com/IDM](http://www.sick.com/IDM)



## Detailed technical data

## Features

<b>Application</b>	Standard application
<b>Version</b>	Standard Range
<b>Scanner design</b>	Wireless variant
<b>Light source</b>	LED, Visible, Red, 630 nm
<b>Reading distance</b>	20 mm ... 850 mm
<b>Scanning frequency</b>	≤ 500 Hz
<b>Code resolution</b>	≥ 0.076 mm

## Mechanics/electronics

<b>Supply voltage</b>	3.7 V DC ... 5 V <sup>1)</sup>
<b>Current consumption</b>	Operation: 180 mA Standby: 80 mA
<b>Housing color</b>	Black/gray
<b>Enclosure rating</b>	IP52
<b>Weight</b>	230 g, incl. rechargeable battery
<b>Dimensions (L x W x H)</b>	97.8 mm x 70.5 mm x 156.2 mm

<sup>1)</sup> Rechargeable battery operation.

## Performance

<b>Readable code structures</b>	1D codes, Stacked
<b>Bar code types</b>	Code 39, Code 39 Full ASCII, Code 32, Code 128, GS1-128, Codabar, Code 11, Code 93, GS1 DataBar, Standard and Industrial 2 of 5, Interleaved & Matrix 2 of 5, IATA, UPC / EAN / JAN, UPC / EAN / JAN (with addition), Telepen, MSI/Plessey, UK/Plessey, Australian Post, China Post, German Post, US Planet, US Postnet, British Post, Intelligent Mail, Japan Post, Korea Post, Dutch KIX Post, Posi LAPA 4 State Code
<b>Stacked code types</b>	PDF417, MicroPDF417, Composite Code
<b>Battery power</b>	Over 60,000 scans with full battery

<b>Code buffer</b>	80,000 Codes (EAN)
--------------------	--------------------

## Interfaces

<b>USB</b>	✓
Function	Keyboard wedge, COM-Port emulation
<b>Optical indicators</b>	2 LEDs (good read, charge of battery , radio connection status)
<b>Acoustic indicators</b>	Beeper, can be switched off
<b>Vibration</b>	No
<b>Configuration software</b>	IDM Setup Tool

## Ambient data

<b>Shock resistance</b>	25 drops from 1.8 m height on concrete
<b>Ambient operating temperature</b>	-10 °C ... +50 °C
<b>Storage temperature</b>	-40 °C ... +70 °C
<b>Permissible relative humidity</b>	± 95 %, Non-condensing
<b>Ambient light immunity</b>	100,000 lx

## General notes

<b>Items supplied</b>	The rechargeable battery is included with delivery
<b>Note</b>	Not free of paint wetting impairment substances.

## Certificates

<b>EU declaration of conformity</b>	✓
<b>UK declaration of conformity</b>	✓
<b>ACMA declaration of conformity</b>	✓
<b>China RoHS</b>	✓
<b>Information according to Art. 3 of Data Act (Regulation EU 2023/2854)</b>	✓
<b>Bluetooth</b>	✓

## Classifications

<b>ECLASS 5.0</b>	27280101
<b>ECLASS 5.1.4</b>	27280101
<b>ECLASS 6.0</b>	27280101
<b>ECLASS 6.2</b>	27280101
<b>ECLASS 7.0</b>	27280101
<b>ECLASS 8.0</b>	27280101
<b>ECLASS 8.1</b>	27280101
<b>ECLASS 9.0</b>	27280101
<b>ECLASS 10.0</b>	27280101
<b>ECLASS 11.0</b>	27280101
<b>ECLASS 12.0</b>	27280101
<b>ETIM 5.0</b>	EC002550
<b>ETIM 6.0</b>	EC002550
<b>ETIM 7.0</b>	EC002550
<b>ETIM 8.0</b>	EC002550

UNSPSC 16.0901	43211701
----------------	----------

Connection diagram AUX looping

Looping-in via AUX

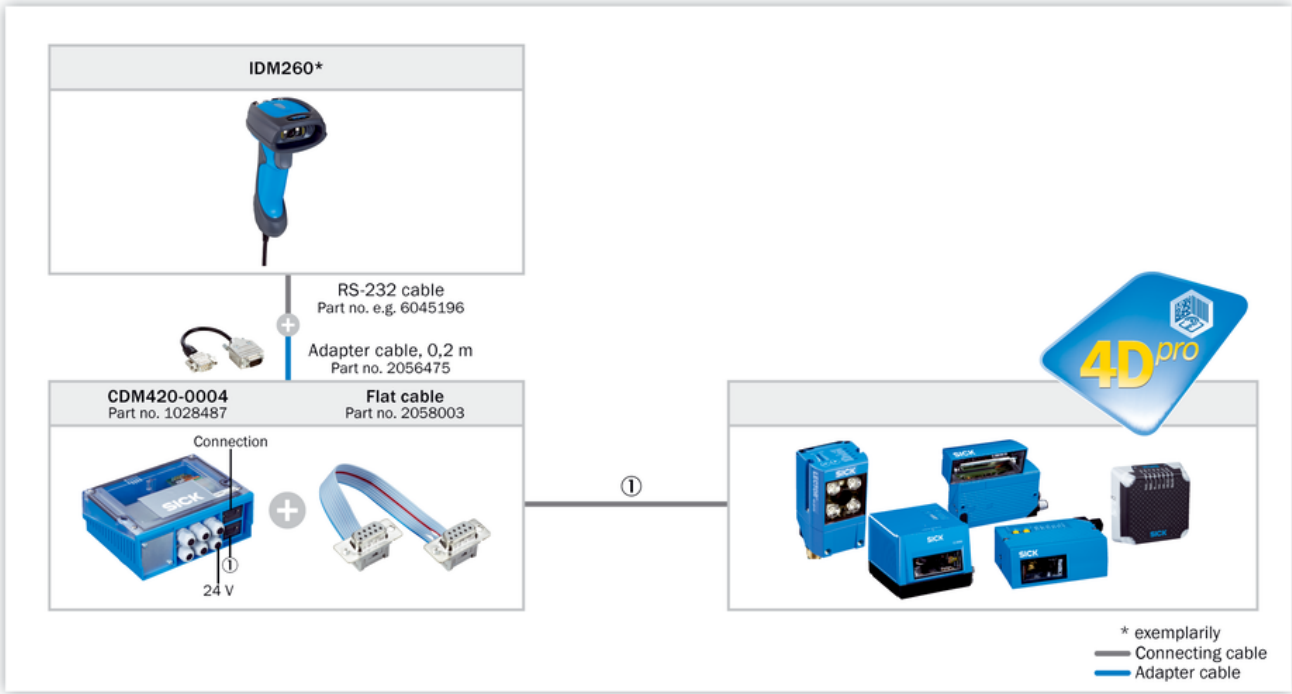

## Connection diagram EtherCAT<sup>®</sup>

### EtherCAT<sup>®</sup>

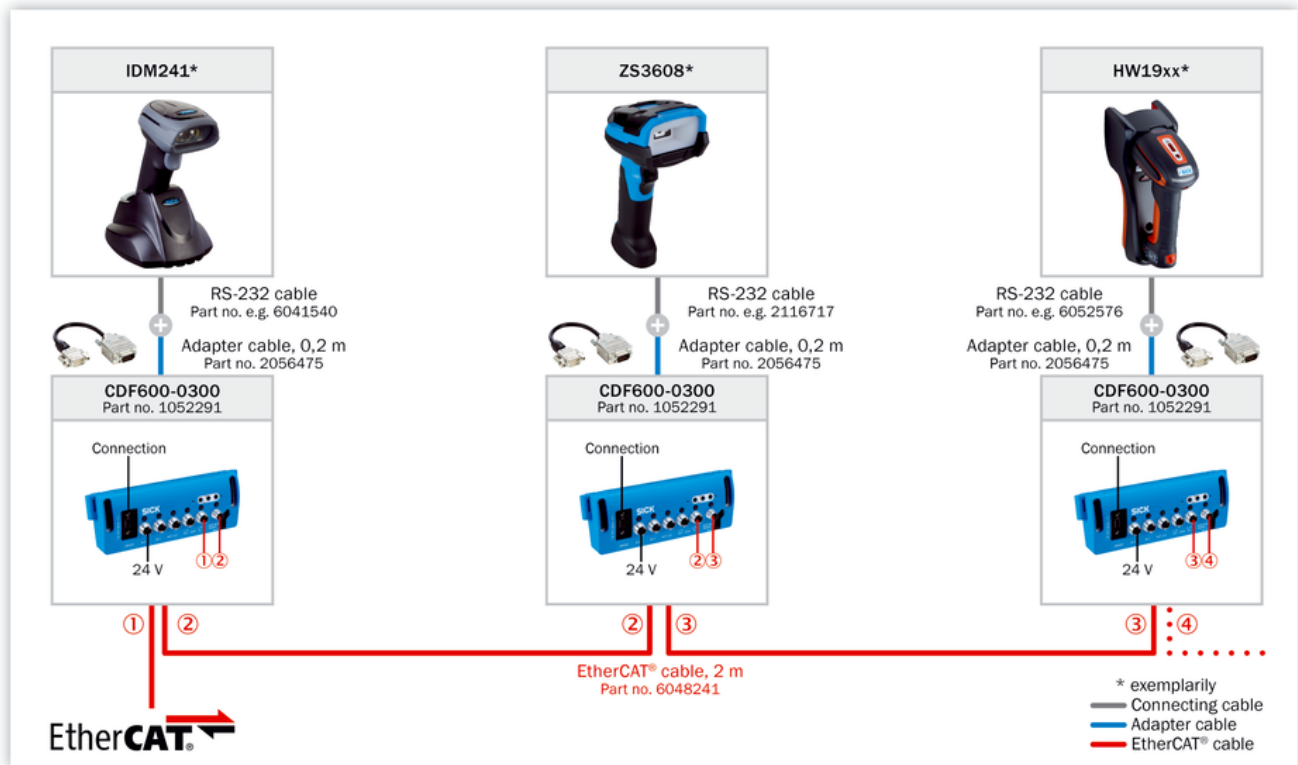

Connection diagram PROFIBUS DP

PROFIBUS DP

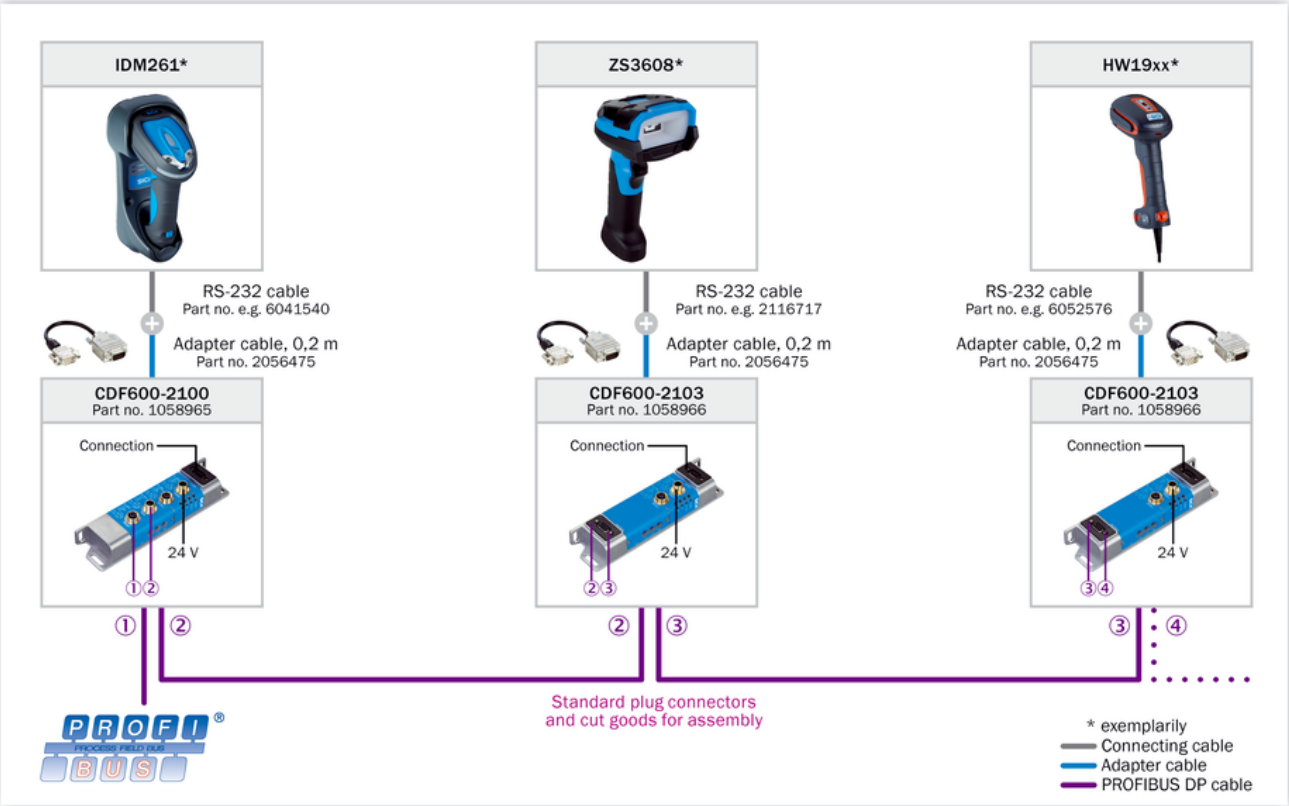

## Connection diagram PROFINET IO/RT

### PROFINET IO/RT

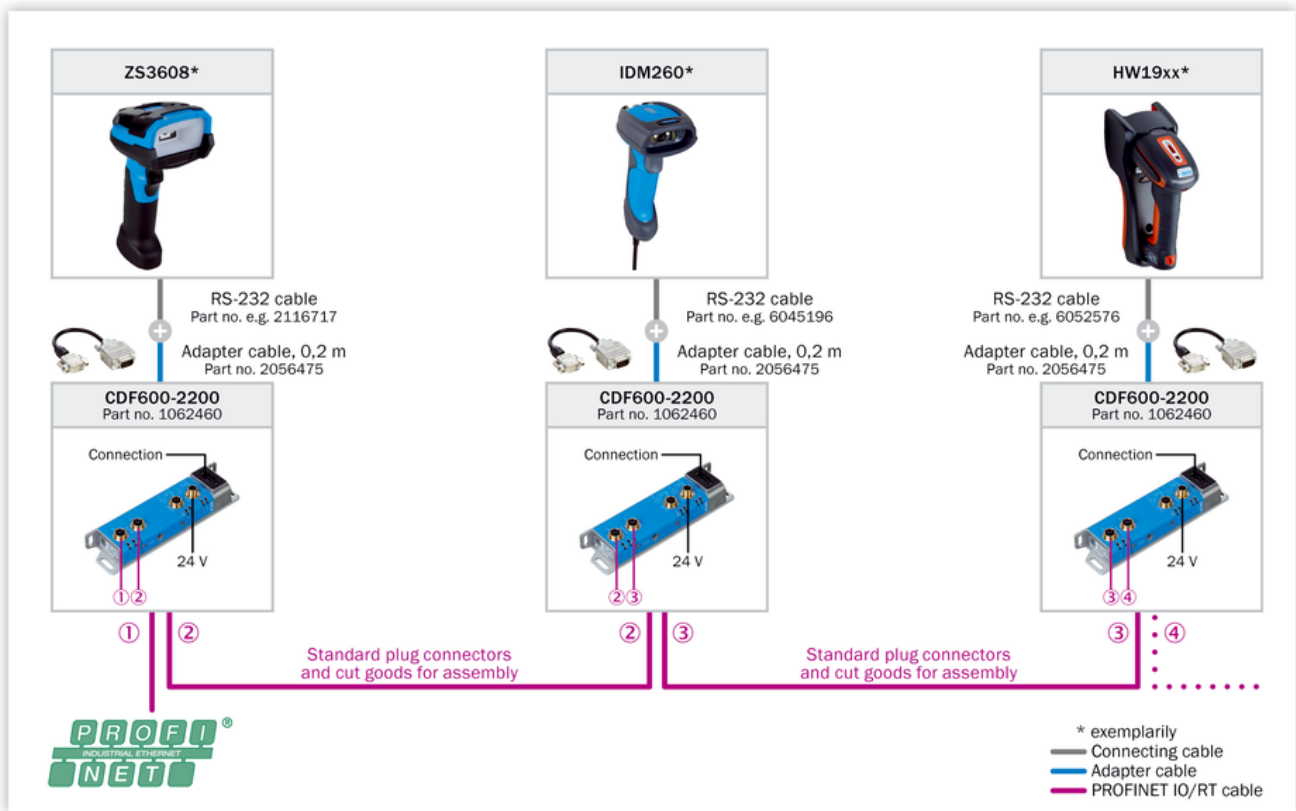

Connection diagram Ethernet TCP/IP

Ethernet TCP/IP

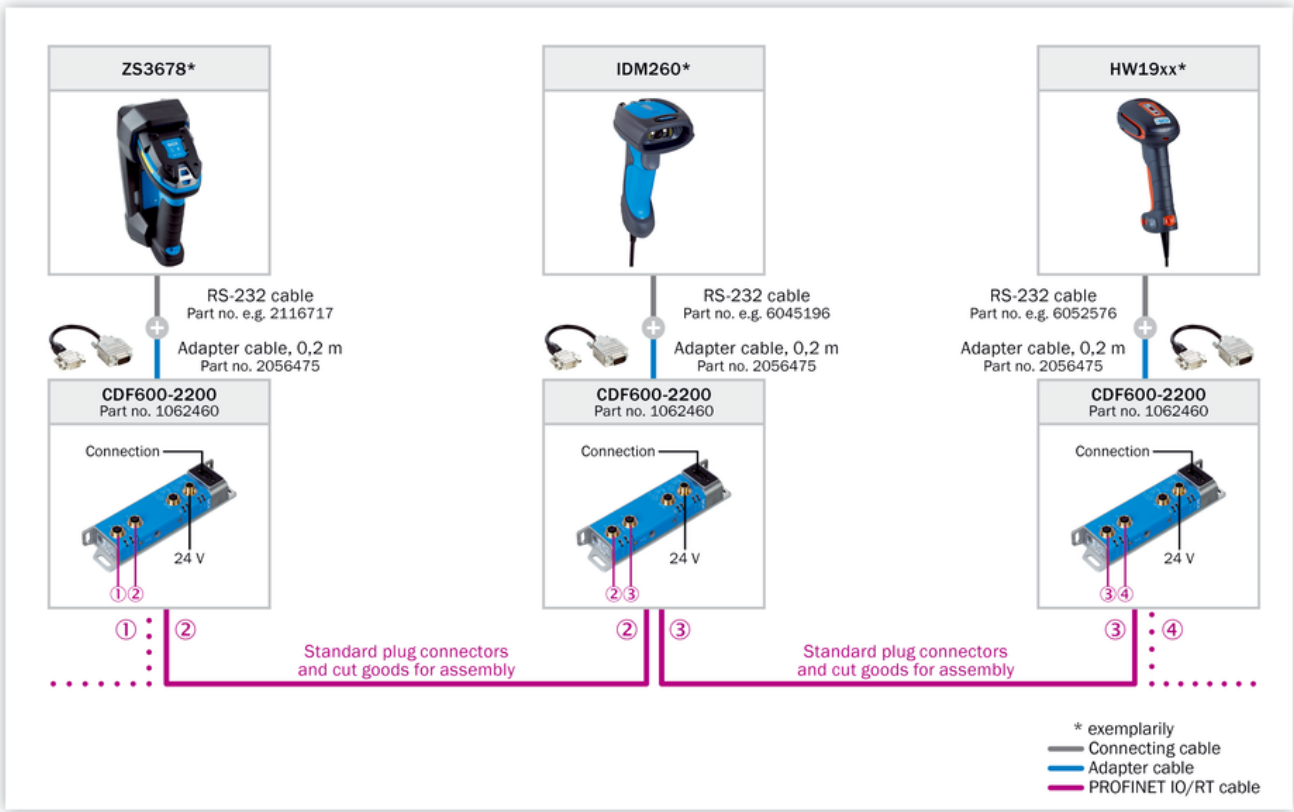



### Selection Guide



\*) For EtherNet/IP third party gateway is required from e.g. Comtrol or HMS (requires local sourcing).

## SICK AT A GLANCE

SICK is one of the leading manufacturers of intelligent sensors and sensor solutions for industrial applications. A unique range of products and services creates the perfect basis for controlling processes securely and efficiently, protecting individuals from accidents and preventing damage to the environment.

We have extensive experience in a wide range of industries and understand their processes and requirements. With intelligent sensors, we can deliver exactly what our customers need. In application centers in Europe, Asia and North America, system solutions are tested and optimized in accordance with customer specifications. All this makes us a reliable supplier and development partner.

Comprehensive services complete our offering: SICK LifeTime Services provide support throughout the machine life cycle and ensure safety and productivity.

**For us, that is “Sensor Intelligence.”**

## WORLDWIDE PRESENCE:

Contacts and other locations –[www.sick.com](http://www.sick.com)