



# IDM240-411S RS-232 Kit

IDM

MOBILE HANDHELD SCANNERS

**SICK**  
Sensor Intelligence.



### Ordering information

Type	part no.
IDM240-411S RS-232 Kit	6080737

**Included in delivery:** IDM240-411S (1), Connection cable (1)

Other models and accessories → [www.sick.com/IDM](http://www.sick.com/IDM)



### Detailed technical data

#### Features

<b>Application</b>	Standard application
<b>Scanner design</b>	Cable connection variant
<b>Sensor resolution</b>	1,280 px x 800 px
<b>Light source</b>	LED, Visible, Red, 660 nm
<b>Alignment aid</b>	LED, green, 660 nm
<b>Reading distance</b>	30 mm ... 400 mm
<b>Code resolution</b>	≥ 0.07 mm <sup>1)</sup> ≥ 0.13 mm <sup>2)</sup>

<sup>1)</sup> Valid for Code 39.

<sup>2)</sup> Valid for Data Matrix code.

#### Mechanics/electronics

<b>Supply voltage</b>	5 V DC, ± 10 %
<b>Current consumption</b>	Operation: 395 mA Standby: 220 mA
<b>Housing color</b>	Black, Gray
<b>Enclosure rating</b>	IP52
<b>Weight</b>	152 g, without cable
<b>Dimensions (L x W x H)</b>	95 mm x 70.5 mm x 161.7 mm
<b>MTBF</b>	100,000 h

#### Performance

<b>Readable code structures</b>	1D codes, 2D codes, Stacked
<b>Bar code types</b>	Code 39, Code 39 Full ASCII, Code 32, Code 128, GS1-128, Codabar, Code 11, Code 93, GS1 DataBar, Standard and Industrial 2 of 5, Interleaved & Matrix 2 of 5, IATA, UPC / EAN / JAN, UPC / EAN / JAN (with addition), Telepen, MSI/Plessey, UK/Plessey, Australian Post, China Post, German Post, US Planet, US Postnet, British Post, Intelligent Mail, Japan Post, Korea Post, Dutch KIX Post, Posi LAPA 4 State Code
<b>2D code types</b>	Data Matrix, MaxiCode, QR code, Aztec, MicroQR-Code, GS1 QR code, GS1 Data-Matrix

<b>Stacked code types</b>	PDF417, MicroPDF417, Code 49, Code 16K, Composite, Codablock F
---------------------------	--

Interfaces

<b>Ethernet</b>	✓ , TCP/IP
Type of fieldbus integration	Optional, over external connection module CDF600-2
<b>PROFINET</b>	✓
Type of fieldbus integration	Optional over external fieldbus module CDF600-2
Function	PROFINET Single Port, PROFINET Dual Port
<b>EtherCAT®</b>	✓
Type of fieldbus integration	Optional over external fieldbus module CDF600
<b>Serial</b>	✓ , RS-232
<b>PROFIBUS DP</b>	✓
Type of fieldbus integration	Optional over external fieldbus module CDF600-2
<b>Optical indicators</b>	2 LEDs (operational status, good read)
<b>Acoustic indicators</b>	Beeper, can be switched off
<b>Vibration</b>	No
<b>Configuration software</b>	IDM Setup Tool

Ambient data

<b>Shock resistance</b>	25 drops from 1.8 m height on concrete
<b>Ambient operating temperature</b>	-10 °C ... +50 °C
<b>Storage temperature</b>	-40 °C ... +70 °C
<b>Relative humidity</b>	95 %, Non-condensing
<b>Ambient light immunity</b>	100,000 lx

General notes

<b>Note</b>	A power supply unit may also be required for commissioning. Not free of paint wetting impairment substances.
-------------	---

Certificates

<b>EU declaration of conformity</b>	✓
<b>UK declaration of conformity</b>	✓
<b>ACMA declaration of conformity</b>	✓
<b>China RoHS</b>	✓
<b>Information according to Art. 3 of Data Act (Regulation EU 2023/2854)</b>	✓

Classifications

<b>ECLASS 5.0</b>	27280101
<b>ECLASS 5.1.4</b>	27280101
<b>ECLASS 6.0</b>	27280101
<b>ECLASS 6.2</b>	27280101
<b>ECLASS 7.0</b>	27280101
<b>ECLASS 8.0</b>	27280101
<b>ECLASS 8.1</b>	27280101
<b>ECLASS 9.0</b>	27280101

<b>ECLASS 10.0</b>	27280101
<b>ECLASS 11.0</b>	27280101
<b>ECLASS 12.0</b>	27280101
<b>ETIM 5.0</b>	EC002550
<b>ETIM 6.0</b>	EC002550
<b>ETIM 7.0</b>	EC002550
<b>ETIM 8.0</b>	EC002550
<b>UNSPSC 16.0901</b>	43211701

### Connection diagram PROFINET IO/RT

#### PROFINET IO/RT

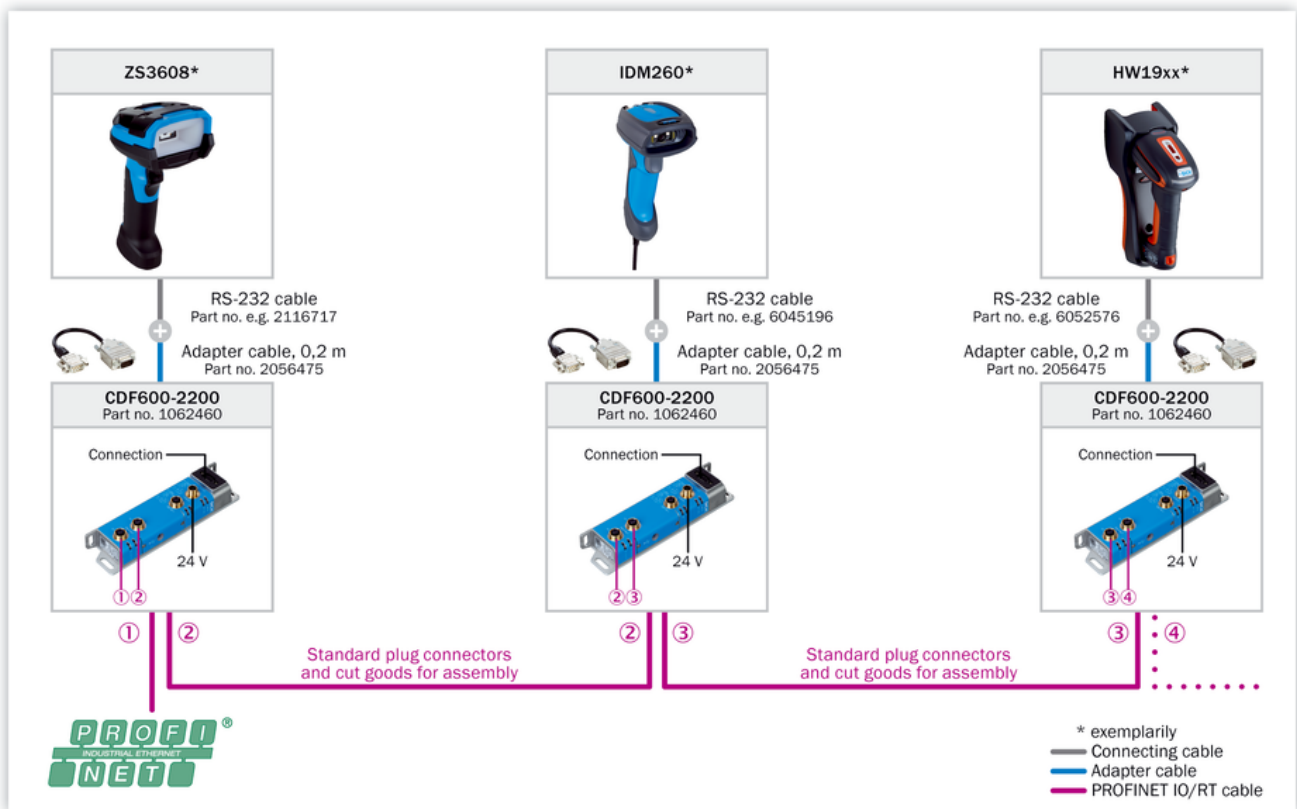

Connection diagram PROFIBUS DP

PROFIBUS DP

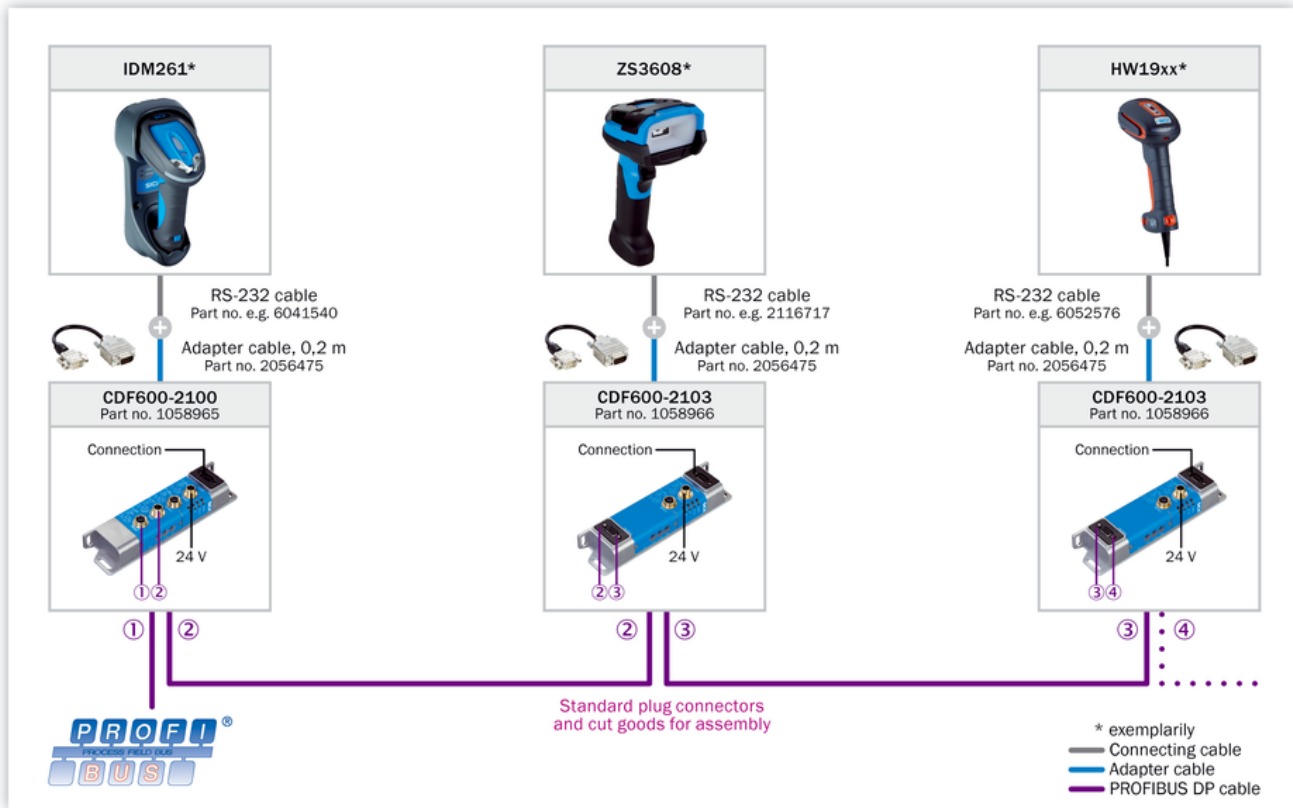

Connection diagram Ethernet TCP/IP

Ethernet TCP/IP

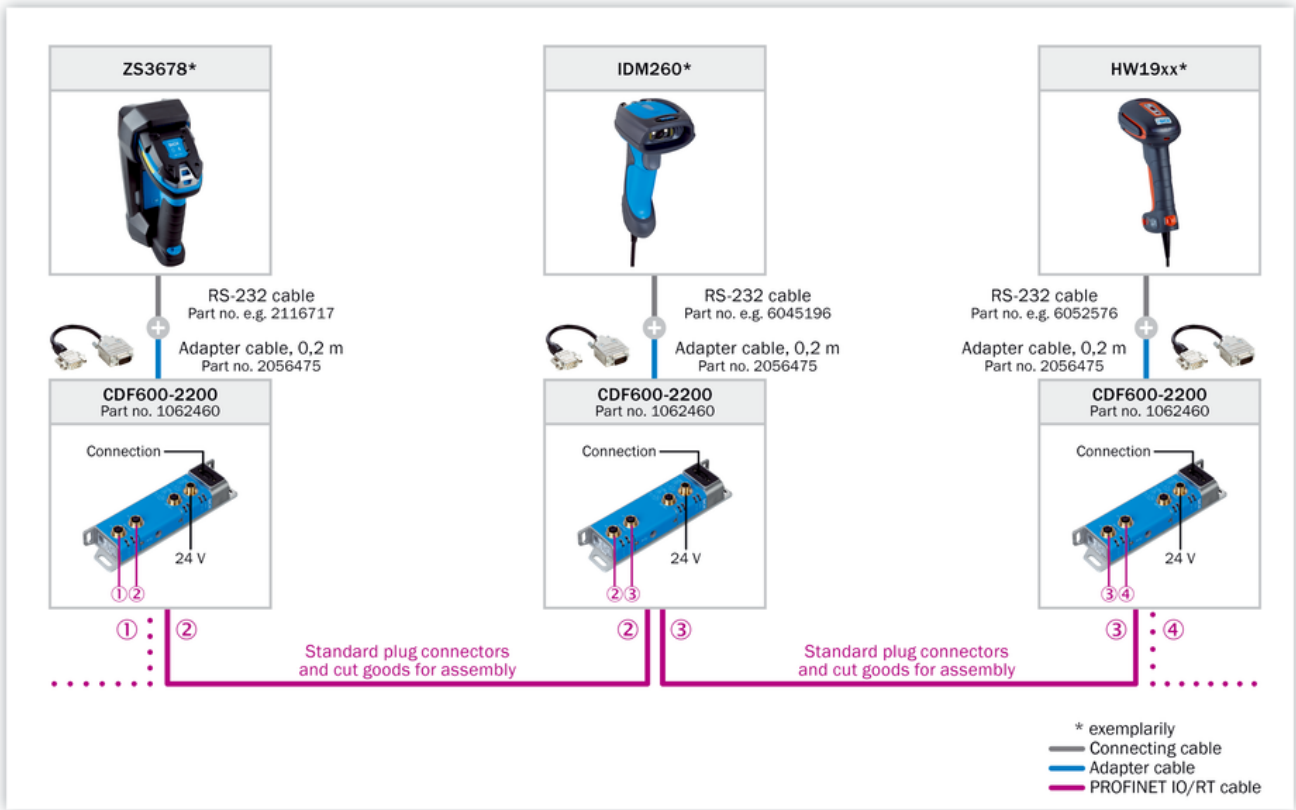

Connection diagram EtherCAT®

EtherCAT®

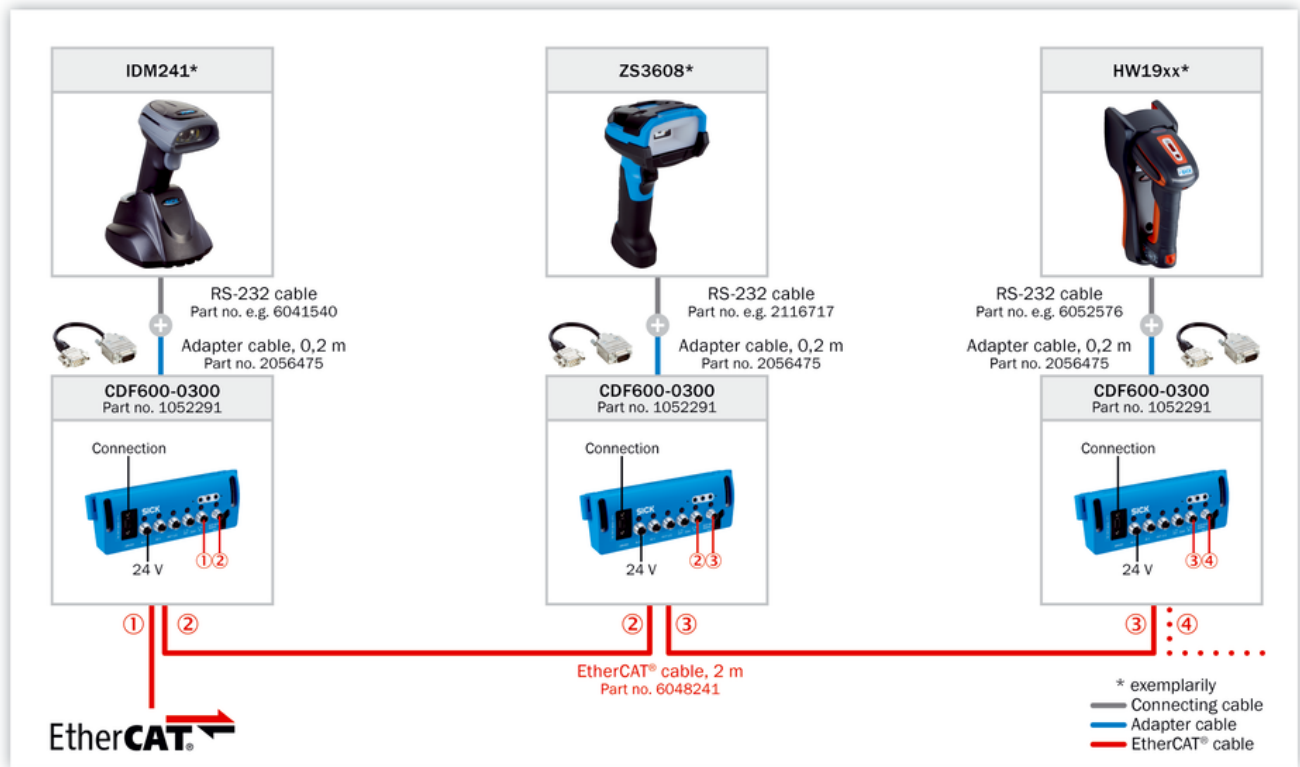

Connection diagram AUX looping

Looping-in via AUX







Selection Guide



\*) For EtherNet/IP third party gateway is required from e.g. Comtrol or HMS (requires local sourcing).

### Recommended accessories

Other models and accessories → [www.sick.com/IDM](http://www.sick.com/IDM)

	Brief description	Type	part no.
connectors and cables			
	<ul style="list-style-type: none"> <li>• <b>Connection type head A:</b> Male connector, D-Sub, 9-pin</li> <li>• <b>Connection type head B:</b> Male connector, D-Sub, 15-pin</li> <li>• <b>Items supplied:</b> Incl. 24V/5V DC converter</li> <li>• <b>Cable:</b> 0.3 m</li> <li>• <b>Note:</b> For handheld scanners to CDB620/CDM420/CDF600/CDF600-2, adapter AUX port</li> </ul>	YMH-DAC-C30XXMDSA9	2056475
integration modules and adapters			
	<ul style="list-style-type: none"> <li>• <b>Description:</b> Connection kit for connecting a hand-held scanner to a PROFINET (Siemens) interface</li> </ul>	Hand-held scanner PROFINET kit	1101488
Power supply units and power supply cables			
	<ul style="list-style-type: none"> <li>• <b>Input voltage:</b> 100 V AC ... 240 V AC</li> <li>• <b>Output voltage:</b> 5 V DC</li> <li>• <b>Output current:</b> 2 A</li> <li>• <b>Description:</b> Power supply unit, input 100 ... 240 V AC, output 5 V DC/2 A (required when using the RS-232-TTL cable, does not satisfy the medical standard EN 60601 / IEC 60601)</li> </ul>	Power supply unit	6036722
Mounting systems			
	<ul style="list-style-type: none"> <li>• <b>Description:</b> Tripod mount</li> </ul>	Stand mount	6036724

## SICK AT A GLANCE

SICK is one of the leading manufacturers of intelligent sensors and sensor solutions for industrial applications. A unique range of products and services creates the perfect basis for controlling processes securely and efficiently, protecting individuals from accidents and preventing damage to the environment.

We have extensive experience in a wide range of industries and understand their processes and requirements. With intelligent sensors, we can deliver exactly what our customers need. In application centers in Europe, Asia and North America, system solutions are tested and optimized in accordance with customer specifications. All this makes us a reliable supplier and development partner.

Comprehensive services complete our offering: SICK LifeTime Services provide support throughout the machine life cycle and ensure safety and productivity.

For us, that is “Sensor Intelligence.”

## WORLDWIDE PRESENCE:

Contacts and other locations –[www.sick.com](http://www.sick.com)