



# IDM160-411S USB Kit

IDM

MOBILE HANDHELD SCANNERS

**SICK**  
Sensor Intelligence.



### Ordering information

| Type                | part no. |
|---------------------|----------|
| IDM160-411S USB Kit | 6080733  |

**Included in delivery:** IDM160-411S (1), Connection cable (1)

Other models and accessories → [www.sick.com/IDM](http://www.sick.com/IDM)



### Detailed technical data

#### Features

|                           |                           |
|---------------------------|---------------------------|
| <b>Application</b>        | Industrial application    |
| <b>Version</b>            | Standard Range            |
| <b>Scanner design</b>     | Cable connection variant  |
| <b>Light source</b>       | LED, Visible, Red, 630 nm |
| <b>Reading distance</b>   | 20 mm ... 850 mm          |
| <b>Scanning frequency</b> | ≤ 500 Hz                  |
| <b>Code resolution</b>    | ≥ 0.076 mm                |

#### Mechanics/electronics

|                               |  |
|-------------------------------|--|
| <b>Supply voltage</b>         | 5 V DC, ± 10 %   |
| <b>Current consumption</b>    | Operation (vibration activated): 230 mA<br>Operation (vibration deactivated): 180 mA<br>Standby: 80 mA |
| <b>Housing color</b>          | Blue, gray   |
| <b>Enclosure rating</b>       | IP65   |
| <b>Weight</b>                 | 208 g, without cable   |
| <b>Dimensions (L x W x H)</b> | 104 mm x 76.3 mm x 176 mm  |

#### Performance

|                                 |   |
|---------------------------------|---|
| <b>Readable code structures</b> | 1D codes, Stacked   |
| <b>Bar code types</b>           | Code 39, Code 39 Full ASCII, Code 32, Code 128, GS1-128, Codabar, Code 11, Code 93, GS1 DataBar, Standard and Industrial 2 of 5, Interleaved & Matrix 2 of 5, IATA, UPC / EAN / JAN, UPC / EAN / JAN (with addition), Telepen, MSI/Plessey, UK/Plessey, Australian Post, China Post, German Post, US Planet, US Postnet, British Post, Intelligent Mail, Japan Post, Korea Post, Dutch KIX Post, Posi LAPA 4 State Code |
| <b>Stacked code types</b>       | PDF417, MicroPDF417, Composite Code   |

#### Interfaces

|            |                                    |
|------------|------------------------------------|
| <b>USB</b> | ✓                                  |
| Function   | Keyboard wedge, COM-Port emulation |

|                               |  |
|-------------------------------|--|
| <b>Optical indicators</b>     | 2 LEDs (operational status, good read) |
| <b>Acoustic indicators</b>    | Beeper, can be switched off            |
| <b>Vibration</b>              | Yes                                    |
| <b>Configuration software</b> | IDM Setup Tool                         |

#### Ambient data

|                                      |                                      |
|--------------------------------------|--------------------------------------|
| <b>Shock resistance</b>              | 50 drops from 2 m height on concrete |
| <b>Ambient operating temperature</b> | -10 °C ... +50 °C                    |
| <b>Storage temperature</b>           | -40 °C ... +70 °C                    |
| <b>Relative humidity</b>             | ± 95 %, Non-condensing               |
| <b>Ambient light immunity</b>        | 100,000 lx                           |

#### General notes

|             |  |
|-------------|--|
| <b>Note</b> | Not free of paint wetting impairment substances. |
|-------------|--|

#### Certificates

|  |   |
|--|---|
| <b>EU declaration of conformity</b>  | ✓ |
| <b>UK declaration of conformity</b>  | ✓ |
| <b>ACMA declaration of conformity</b>  | ✓ |
| <b>China RoHS</b>  | ✓ |
| <b>Information according to Art. 3 of Data Act (Regulation EU 2023/2854)</b> | ✓ |

#### Classifications

|                       |          |
|-----------------------|----------|
| <b>ECLASS 5.0</b>     | 27280101 |
| <b>ECLASS 5.1.4</b>   | 27280101 |
| <b>ECLASS 6.0</b>     | 27280101 |
| <b>ECLASS 6.2</b>     | 27280101 |
| <b>ECLASS 7.0</b>     | 27280101 |
| <b>ECLASS 8.0</b>     | 27280101 |
| <b>ECLASS 8.1</b>     | 27280101 |
| <b>ECLASS 9.0</b>     | 27280101 |
| <b>ECLASS 10.0</b>    | 27280101 |
| <b>ECLASS 11.0</b>    | 27280101 |
| <b>ECLASS 12.0</b>    | 27280101 |
| <b>ETIM 5.0</b>       | EC002550 |
| <b>ETIM 6.0</b>       | EC002550 |
| <b>ETIM 7.0</b>       | EC002550 |
| <b>ETIM 8.0</b>       | EC002550 |
| <b>UNSPSC 16.0901</b> | 43211701 |

Connection diagram PROFINET IO/RT

PROFINET IO/RT

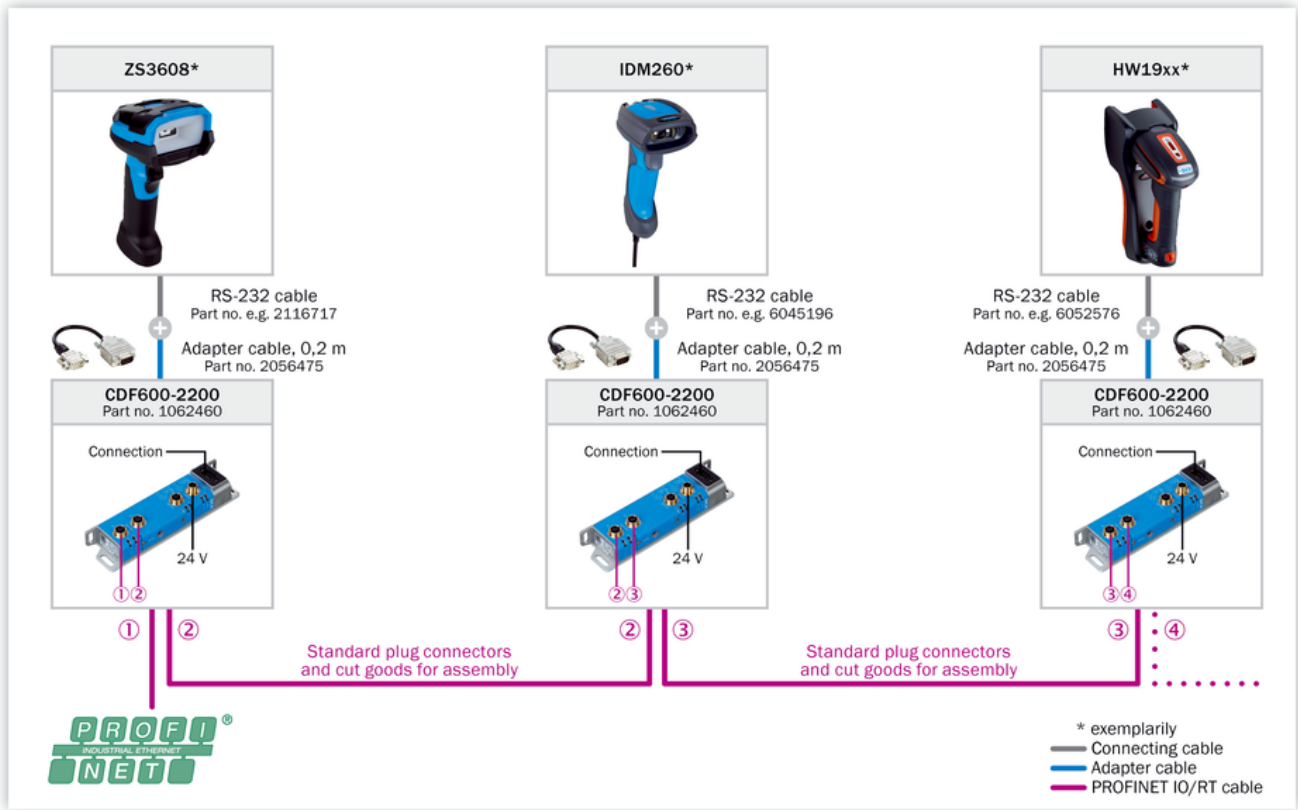

Connection diagram PROFIBUS DP

PROFIBUS DP

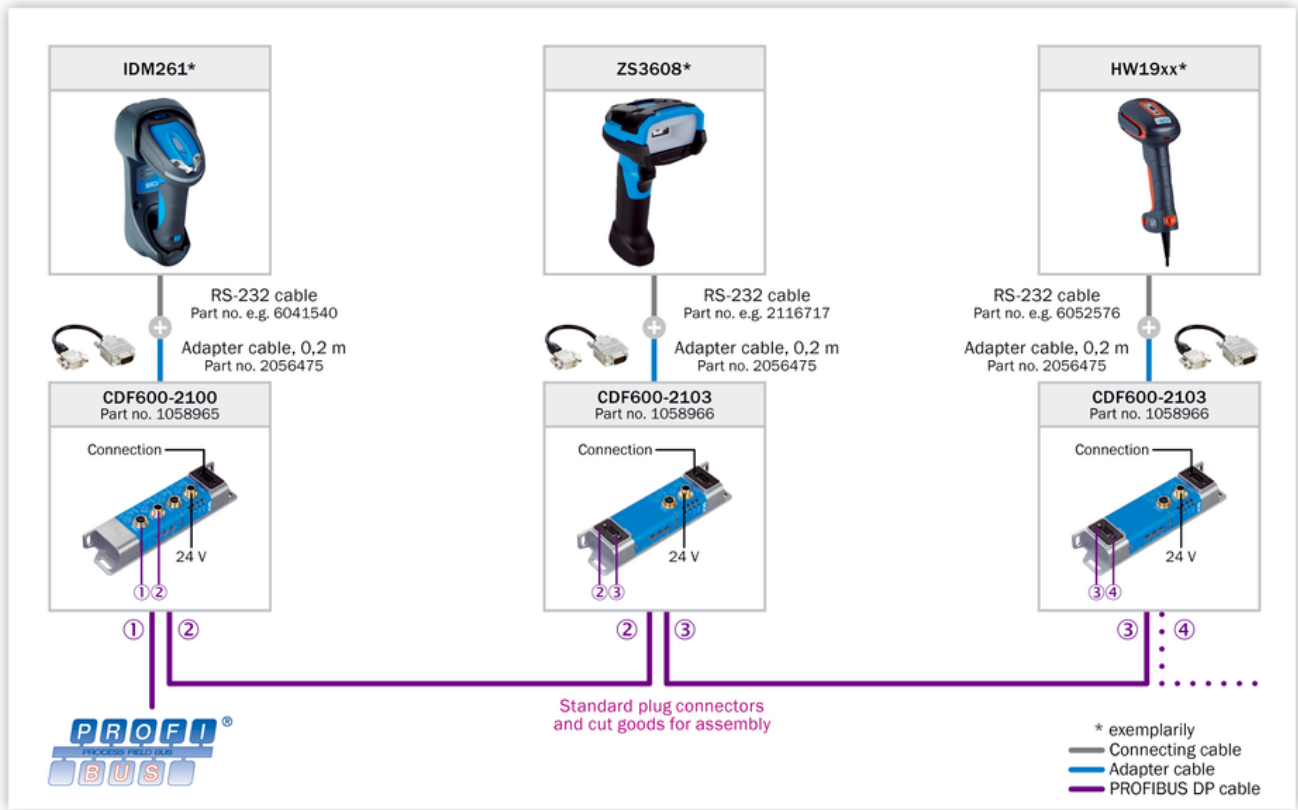

Connection diagram Ethernet TCP/IP

Ethernet TCP/IP

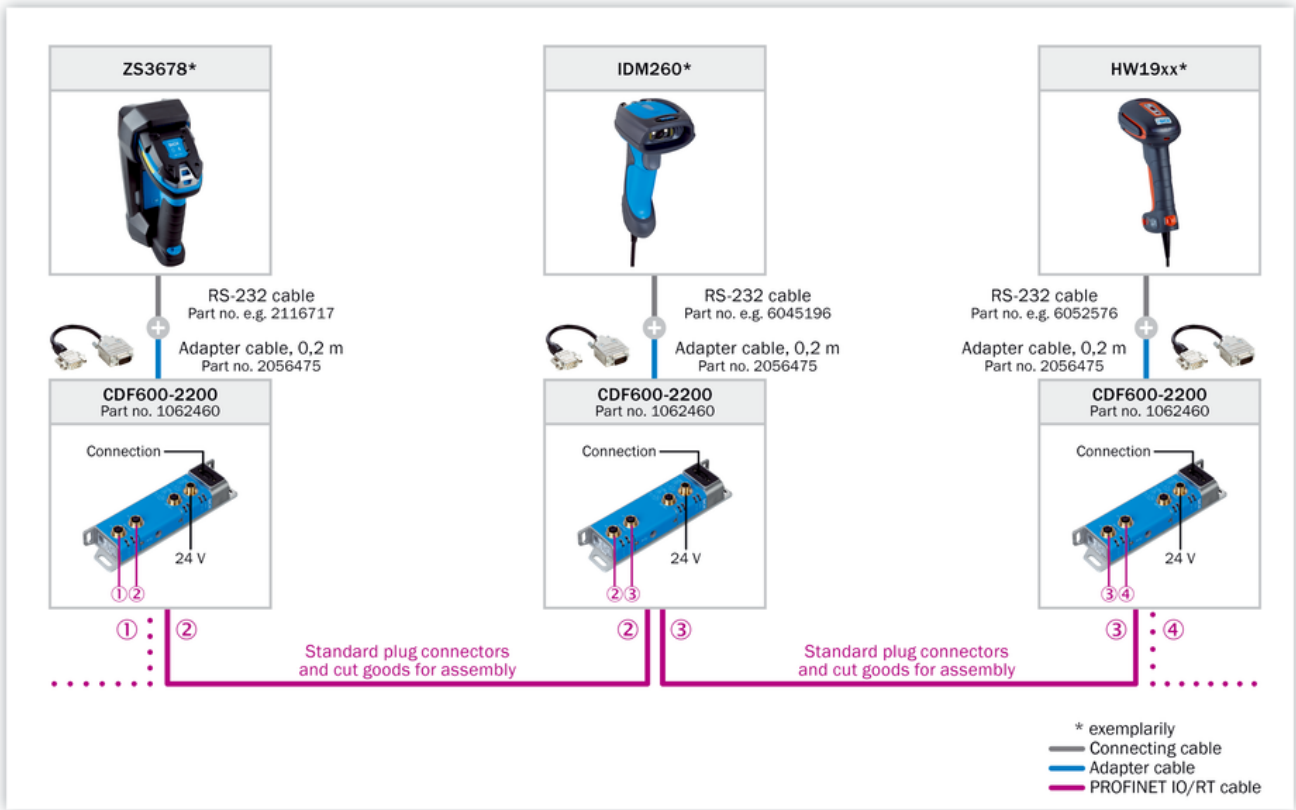

Connection diagram EtherCAT®

EtherCAT®

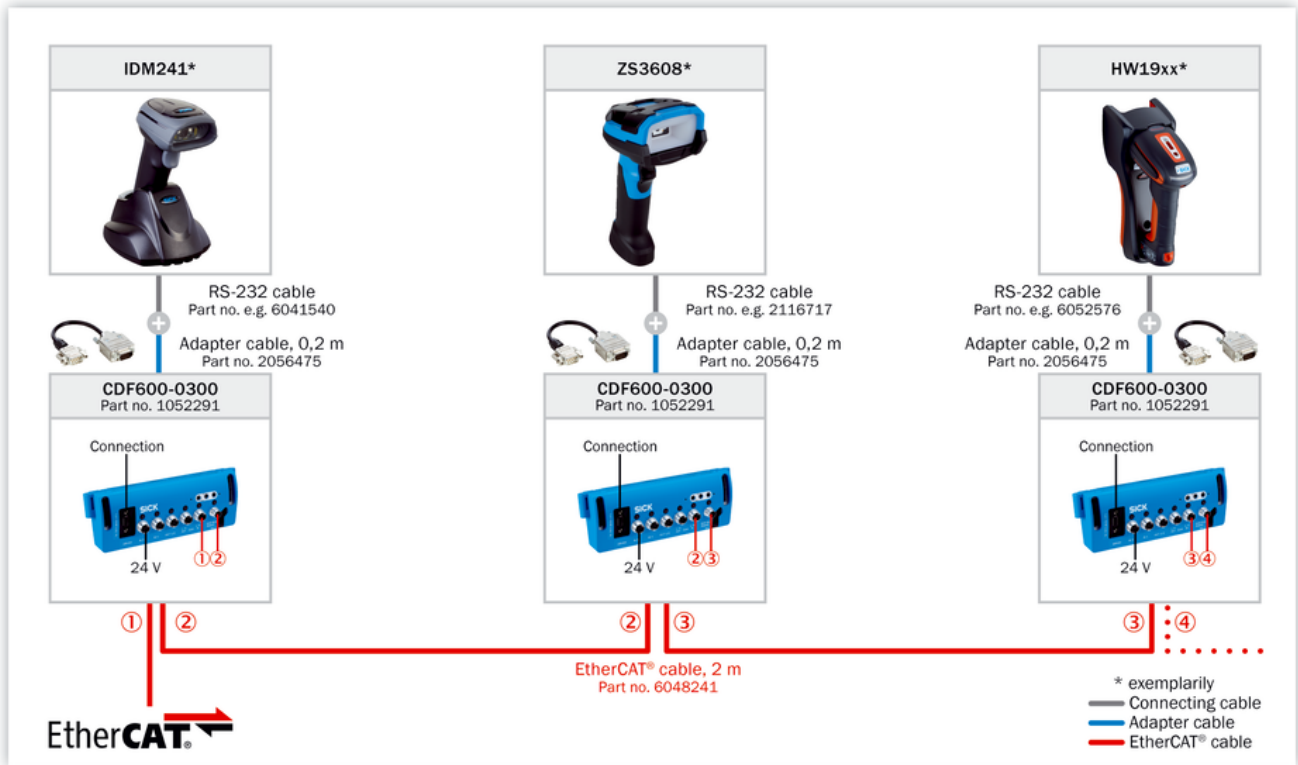

Connection diagram AUX looping

Looping-in via AUX

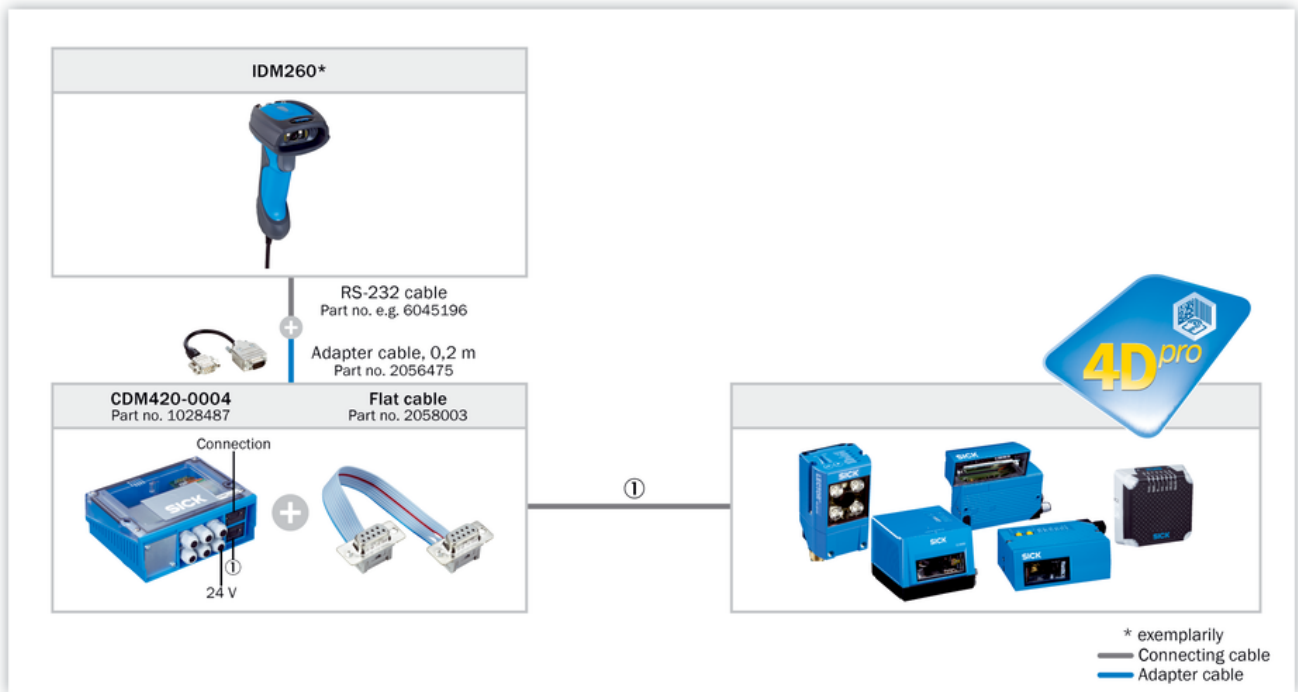

Selection Guide



\*) For EtherNet/IP third party gateway is required from e.g. Comtrol or HMS (requires local sourcing).

## SICK AT A GLANCE

SICK is one of the leading manufacturers of intelligent sensors and sensor solutions for industrial applications. A unique range of products and services creates the perfect basis for controlling processes securely and efficiently, protecting individuals from accidents and preventing damage to the environment.

We have extensive experience in a wide range of industries and understand their processes and requirements. With intelligent sensors, we can deliver exactly what our customers need. In application centers in Europe, Asia and North America, system solutions are tested and optimized in accordance with customer specifications. All this makes us a reliable supplier and development partner.

Comprehensive services complete our offering: SICK LifeTime Services provide support throughout the machine life cycle and ensure safety and productivity.

For us, that is “Sensor Intelligence.”

## WORLDWIDE PRESENCE:

Contacts and other locations –[www.sick.com](http://www.sick.com)