



# IDM140-411S USB Kit

IDM

MOBILE HANDHELD SCANNERS

**SICK**  
Sensor Intelligence.



### Ordering information

Type	part no.
IDM140-411S USB Kit	6080730

**Included in delivery:** IDM140-411S (1), Connection cable (1)

Other models and accessories → [www.sick.com/IDM](http://www.sick.com/IDM)



### Detailed technical data

#### Features

<b>Application</b>	Standard application
<b>Version</b>	Standard Range
<b>Scanner design</b>	Cable connection variant
<b>Light source</b>	LED, Visible, Red, 630 nm
<b>Reading distance</b>	20 mm ... 850 mm
<b>Scanning frequency</b>	≤ 500 Hz
<b>Code resolution</b>	≥ 0.076 mm

#### Mechanics/electronics

<b>Supply voltage</b>	5 V DC, ± 10 %
<b>Current consumption</b>	Operation: 180 mA Standby: 80 mA
<b>Housing color</b>	Black/gray
<b>Enclosure rating</b>	IP52
<b>Weight</b>	157 g, without cable
<b>Dimensions (L x W x H)</b>	98 mm x 71 mm x 157 mm

#### Performance

<b>Readable code structures</b>	1D codes, Stacked
<b>Bar code types</b>	Code 128, GS1-128, UPC-A, EAN13, Codabar, Code 39, Code 32, Code 93, Standard and Industrial 2 of 5, Interleaved 2 of 5, Matrix 2 of 5, China Postal Code, German Postal Code, IA-TA, Code 11, MSI/Plessey, UK/Plessey, Telepen, GS1 DataBar, UPC-E, EAN-8, Code 39 Trioptic, UCC Coupon Extended Code, Chinese Sensible Code, Australian Post, British Post, Intelligent Mail (USPS 4CB/One Code), Japan Post, Netherlands KIX Post, US Planet, US Postnet
<b>Stacked code types</b>	PDF417, MicroPDF417, Codablock F, Composite

#### Interfaces

<b>USB</b>	✓
Function	Keyboard wedge, COM-Port emulation
<b>Optical indicators</b>	2 LEDs (operational status, good read)

<b>Acoustic indicators</b>	Beeper, can be switched off
<b>Vibration</b>	No
<b>Configuration software</b>	IDM Setup Tool

#### Ambient data

<b>Shock resistance</b>	25 drops from 1.8 m height on concrete
<b>Ambient operating temperature</b>	-10 °C ... +50 °C
<b>Storage temperature</b>	-40 °C ... +70 °C
<b>Relative humidity</b>	± 95 %, Non-condensing
<b>Ambient light immunity</b>	100,000 lx

#### General notes

<b>Note</b>	Not free of paint wetting impairment substances.
-------------	--

#### Certificates

<b>EU declaration of conformity</b>	✓
<b>UK declaration of conformity</b>	✓
<b>ACMA declaration of conformity</b>	✓
<b>China RoHS</b>	✓
<b>Information according to Art. 3 of Data Act (Regulation EU 2023/2854)</b>	✓

#### Classifications

<b>ECLASS 5.0</b>	27280101
<b>ECLASS 5.1.4</b>	27280101
<b>ECLASS 6.0</b>	27280101
<b>ECLASS 6.2</b>	27280101
<b>ECLASS 7.0</b>	27280101
<b>ECLASS 8.0</b>	27280101
<b>ECLASS 8.1</b>	27280101
<b>ECLASS 9.0</b>	27280101
<b>ECLASS 10.0</b>	27280101
<b>ECLASS 11.0</b>	27280101
<b>ECLASS 12.0</b>	27280101
<b>ETIM 5.0</b>	EC002550
<b>ETIM 6.0</b>	EC002550
<b>ETIM 7.0</b>	EC002550
<b>ETIM 8.0</b>	EC002550
<b>UNSPSC 16.0901</b>	43211701

Connection diagram PROFINET IO/RT

PROFINET IO/RT

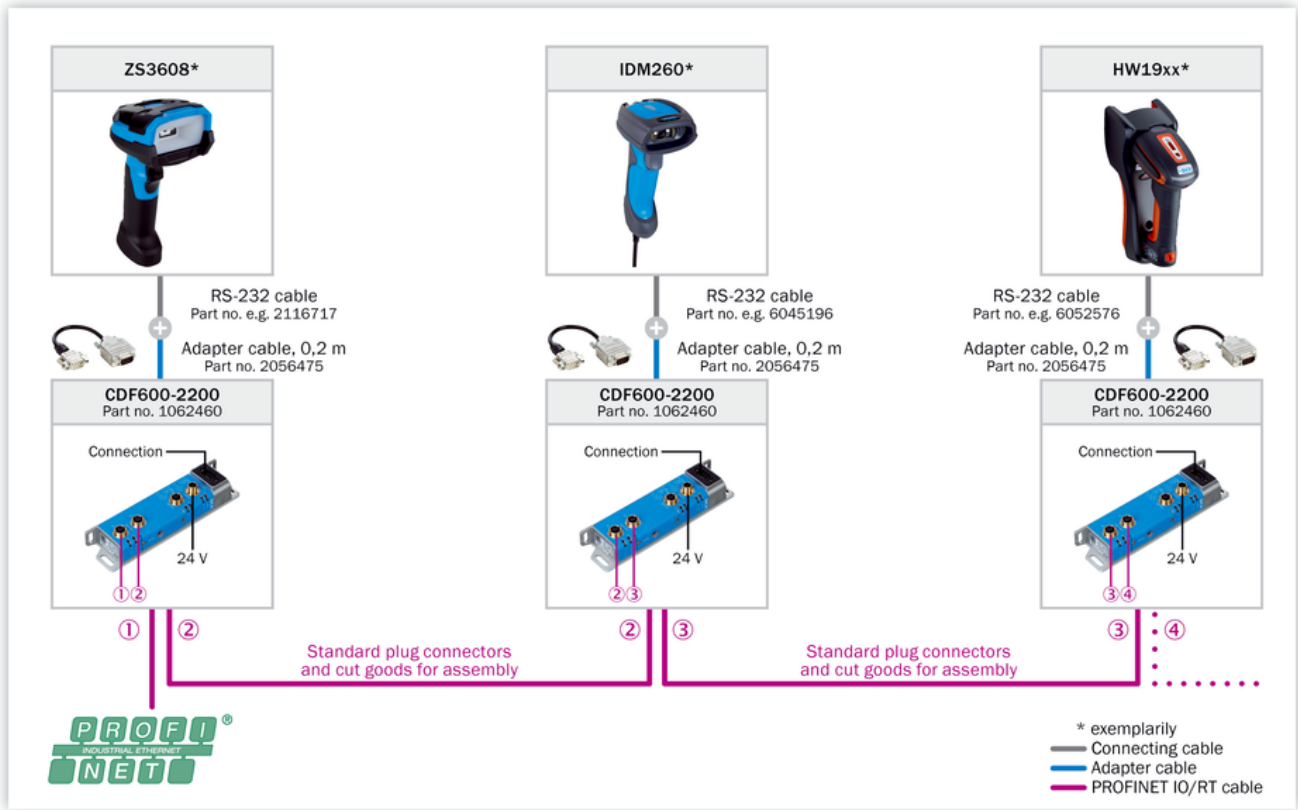

Connection diagram PROFIBUS DP

PROFIBUS DP

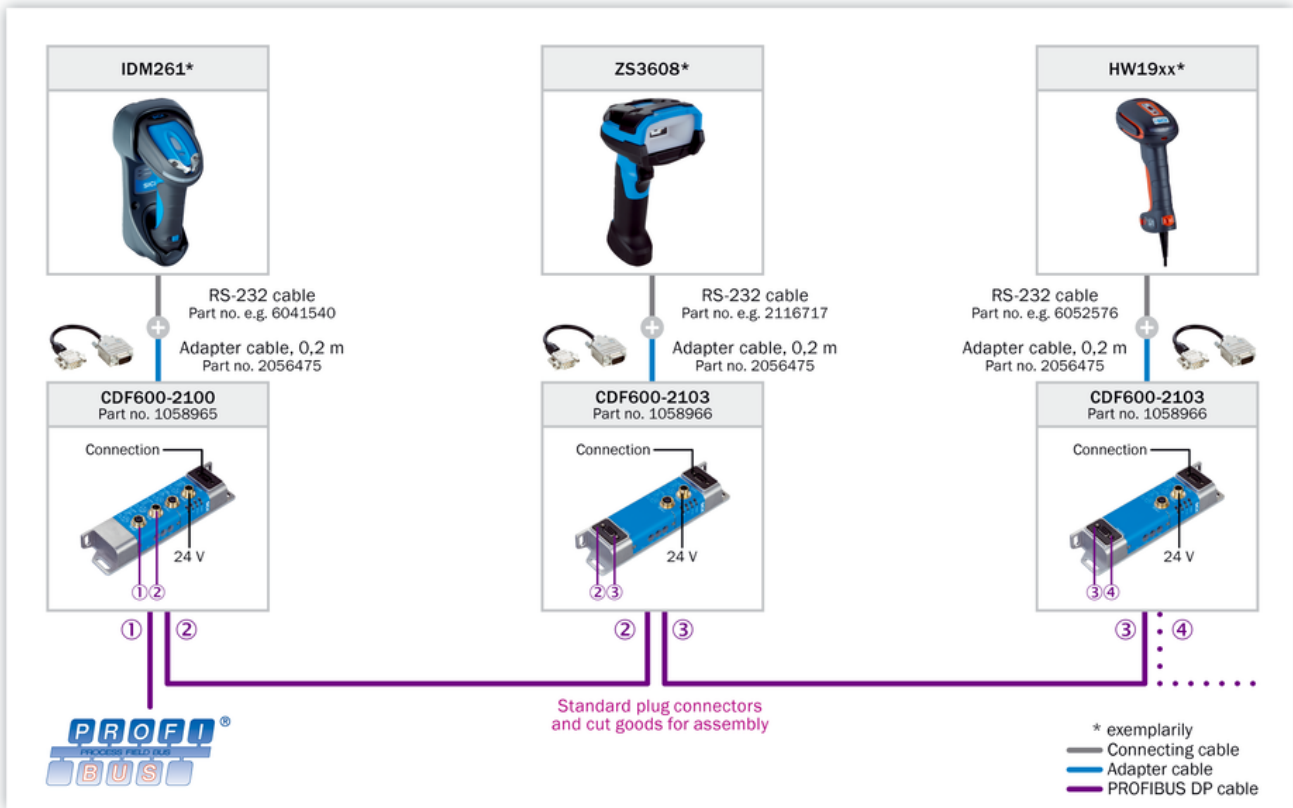

Connection diagram Ethernet TCP/IP

Ethernet TCP/IP

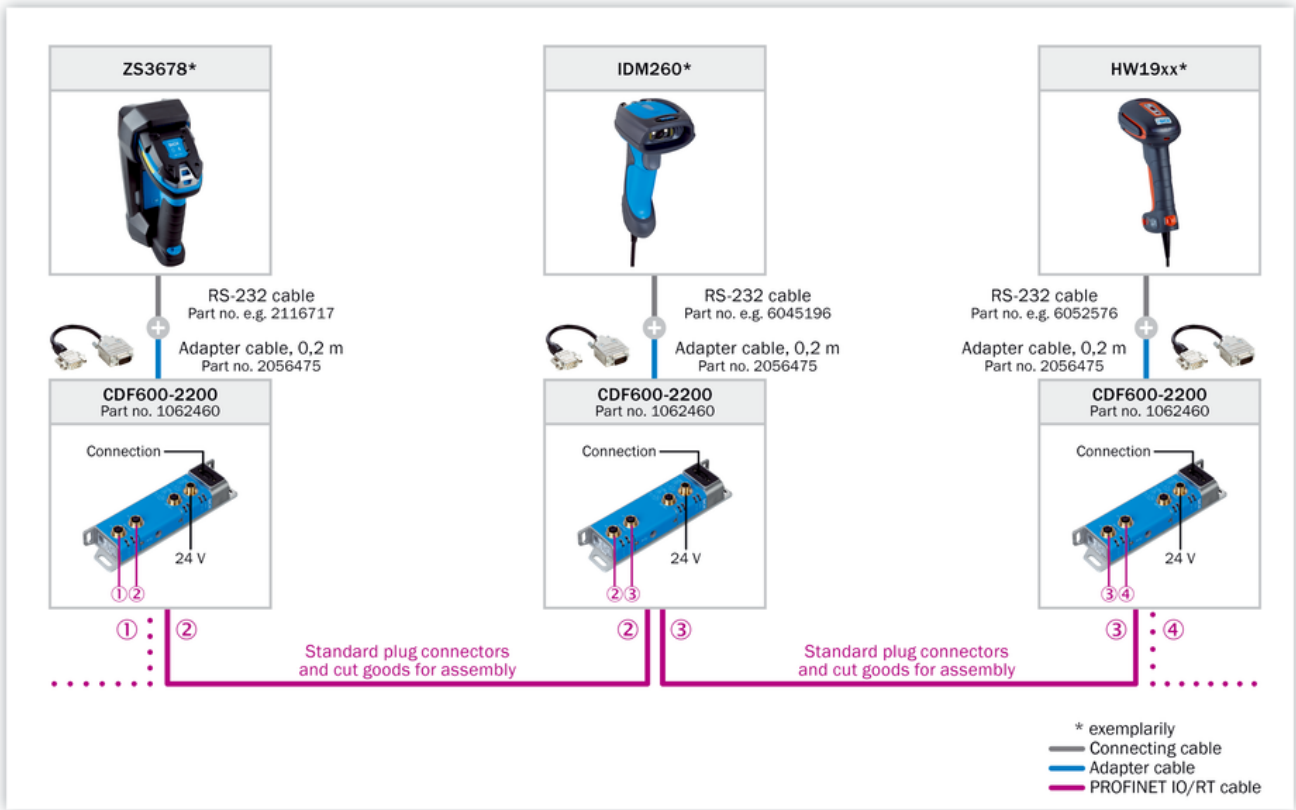

Connection diagram EtherCAT®

EtherCAT®



Connection diagram AUX looping

Looping-in via AUX

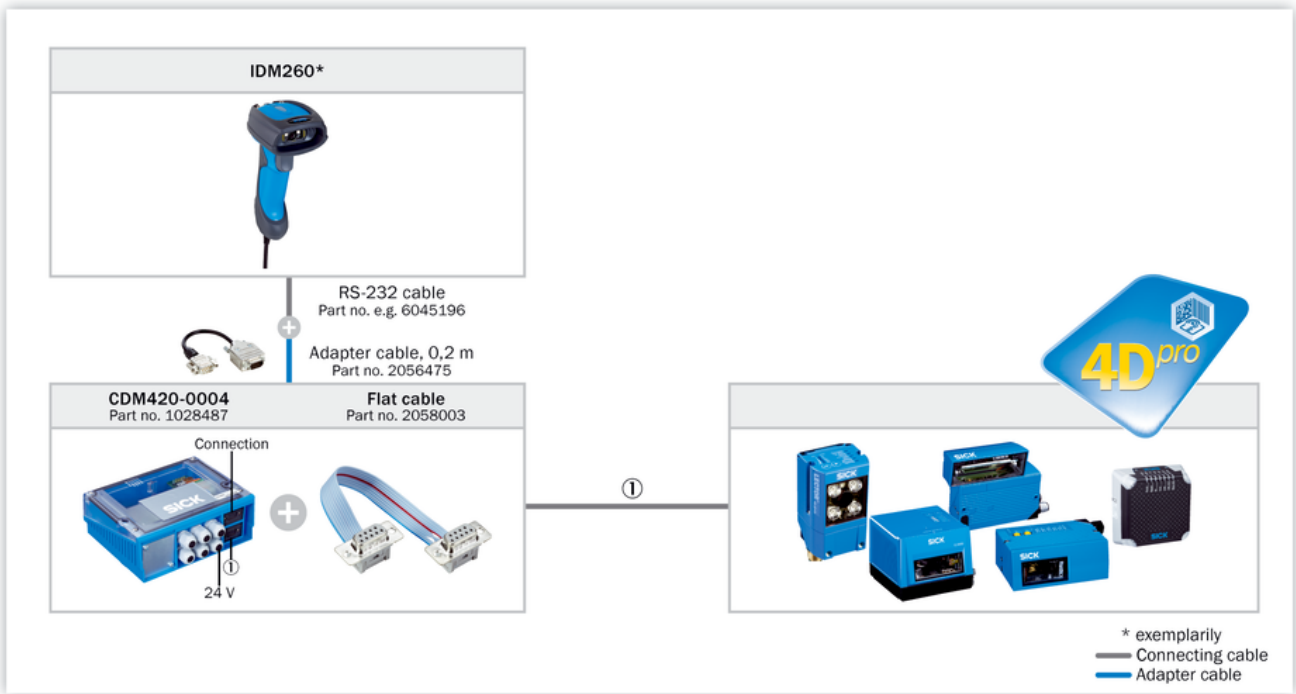



Selection Guide



\*) For EtherNet/IP third party gateway is required from e.g. Comtrol or HMS (requires local sourcing).

### Recommended accessories

Other models and accessories → [www.sick.com/IDM](http://www.sick.com/IDM)

	Brief description	Type	part no.
Mounting systems			
	<ul style="list-style-type: none"><li><b>Description:</b> Tripod mount</li></ul>	Stand mount	6036724
	<ul style="list-style-type: none"><li><b>Description:</b> Desk holder</li><li><b>Dimensions (W x H x L):</b> Bore hole spacing 58 mm</li></ul>	Table mount	6036723

## SICK AT A GLANCE

SICK is one of the leading manufacturers of intelligent sensors and sensor solutions for industrial applications. A unique range of products and services creates the perfect basis for controlling processes securely and efficiently, protecting individuals from accidents and preventing damage to the environment.

We have extensive experience in a wide range of industries and understand their processes and requirements. With intelligent sensors, we can deliver exactly what our customers need. In application centers in Europe, Asia and North America, system solutions are tested and optimized in accordance with customer specifications. All this makes us a reliable supplier and development partner.

Comprehensive services complete our offering: SICK LifeTime Services provide support throughout the machine life cycle and ensure safety and productivity.

For us, that is “Sensor Intelligence.”

## WORLDWIDE PRESENCE:

Contacts and other locations –[www.sick.com](http://www.sick.com)