



ZI3608-SR00263VZK

Zx36

MOBILE HANDHELD SCANNERS

SICK
Sensor Intelligence.



Ordering information

Type	part no.
ZI3608-SR00263VZK	6080548

Other models and accessories → www.sick.com/Zx36

Detailed technical data

Features

Application	Industrial application
Version	Standard Range (SR)
Country approval	Korea, India
Scanner design	Cable connection variant
Light source	LED, Visible, Red, 617 nm Target, laser, Visible, Red, 655 nm
Reading distance	0 mm ... 1,067 mm
Code resolution	≥ 0.102 mm ¹⁾

¹⁾ Valid for Code 39.

Mechanics/electronics

Supply voltage	5 V DC, ± 10 %, Via host 12 V DC, ± 5 %, External supply
Housing color	Blue, black
Enclosure rating	IP65 IP68
Weight	304 g
Dimensions (L x W x H)	132 mm x 77 mm x 185 mm

Performance

Readable code structures	1D codes
Bar code types	Code 39, Code 39 Trioptic, Code 93, Code 11, Codabar/NW7, Code 128, GS1-128 / EAN 128, UPC / EAN / JAN (with addition), MSI/Plessey, Interleaved 2 of 5, Korean 3 of 5, Chinese 2 of 5, Matrix 2 of 5, GS1 DataBar, Australian Post, US Planet, US Postnet, British Post, Japan Post, Dutch KIX Post
Battery power	3,100 mAh, over 100,000 scans with full battery
Code buffer	9,000 Codes (EAN, for scanning in batch mode)

Interfaces

Ethernet	✓, TCP/IP
Type of fieldbus integration	Optional over external fieldbus module CDF600-2
PROFINET	✓

	Type of fieldbus integration	Optional over external fieldbus module CDF600-2
	Function	PROFINET Single Port, PROFINET Dual Port
EtherCAT®		✓
	Type of fieldbus integration	Optional over external fieldbus module CDF600-2
Serial		✓ , RS-232 TTL
PROFIBUS DP		✓
	Type of fieldbus integration	Optional over external fieldbus module CDF600-2
USB		✓
	Function	Keyboard wedge, COM-Port emulation
Optical indicators		2 LEDs (operational status, good read)
Acoustic indicators		Beeper, can be switched off
Vibration		Yes
Configuration software		Z-Up Tool

Ambient data

Shock resistance	Multiple falls Onto concrete from a height of 3 m
Ambient operating temperature	-30 °C ... +50 °C
Storage temperature	-40 °C ... +70 °C
Permissible relative humidity	95 %, Non-condensing
Ambient light immunity	108,000 lx

General notes

Note	Not free of paint wetting impairment substances.
-------------	--

Classifications

ECLASS 5.0	27280101
ECLASS 5.1.4	27280101
ECLASS 6.0	27280101
ECLASS 6.2	27280101
ECLASS 7.0	27280101
ECLASS 8.0	27280101
ECLASS 8.1	27280101
ECLASS 9.0	27280101
ECLASS 10.0	27280101
ECLASS 11.0	27280101
ECLASS 12.0	27280101
ETIM 5.0	EC002550
ETIM 6.0	EC002550
ETIM 7.0	EC002550
ETIM 8.0	EC002550
UNSPSC 16.0901	43211701

Connection diagram AUX looping

Looping-in via AUX

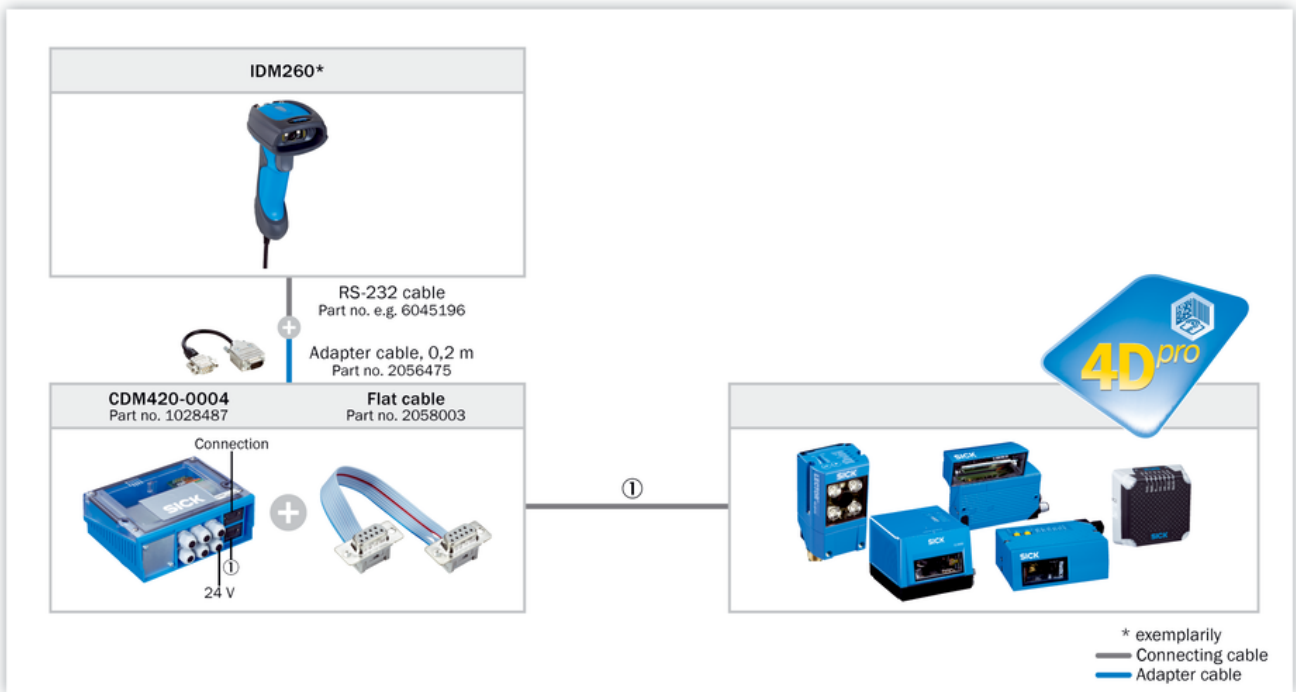

Connection diagram EtherCAT®

EtherCAT®

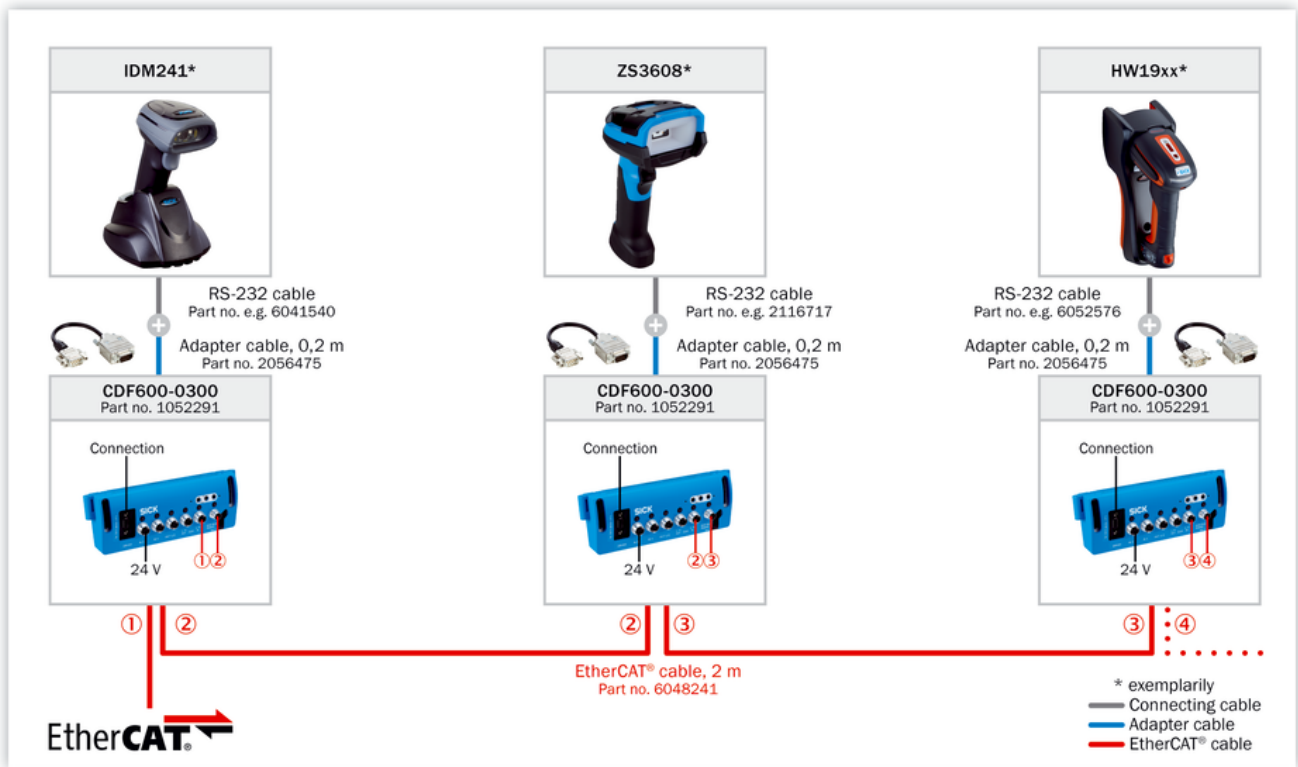

Connection diagram PROFIBUS DP

PROFIBUS DP

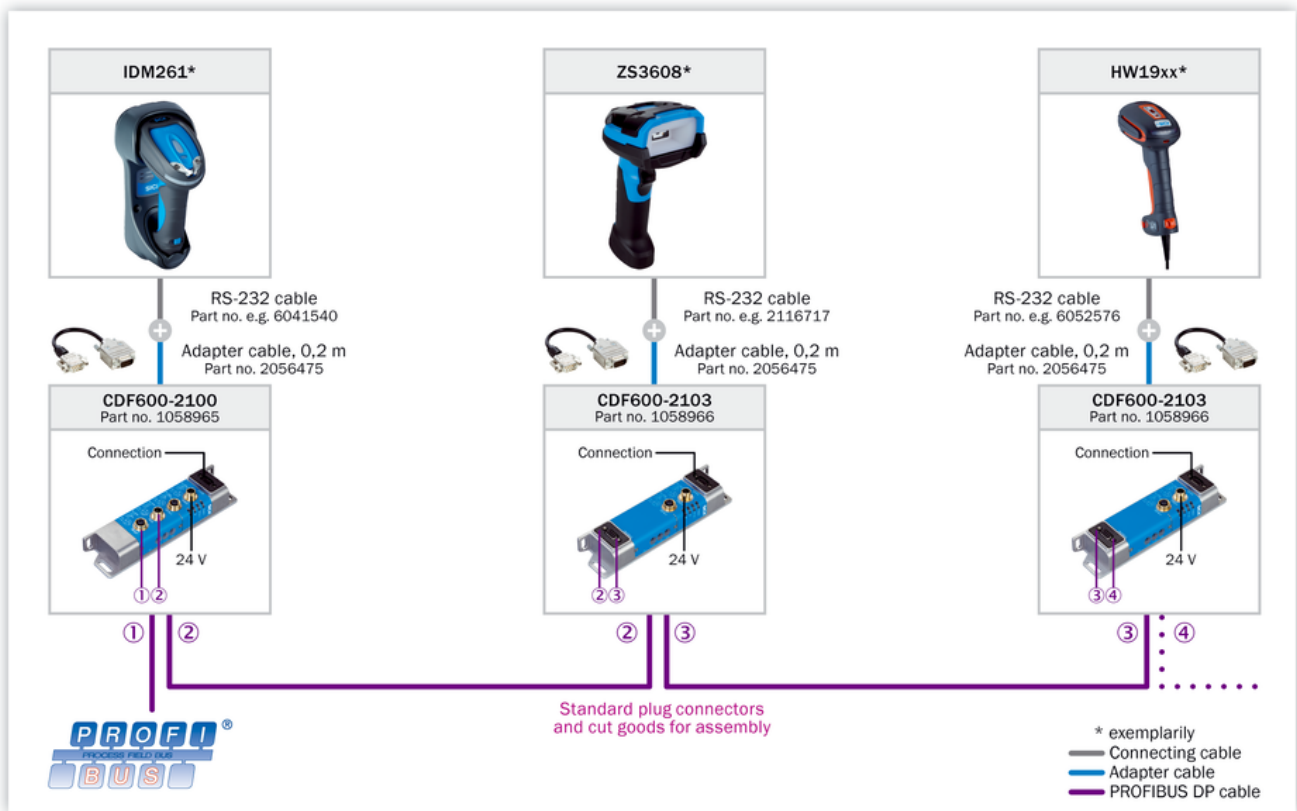

Connection diagram PROFINET IO/RT

PROFINET IO/RT



Connection diagram Ethernet TCP/IP

Ethernet TCP/IP

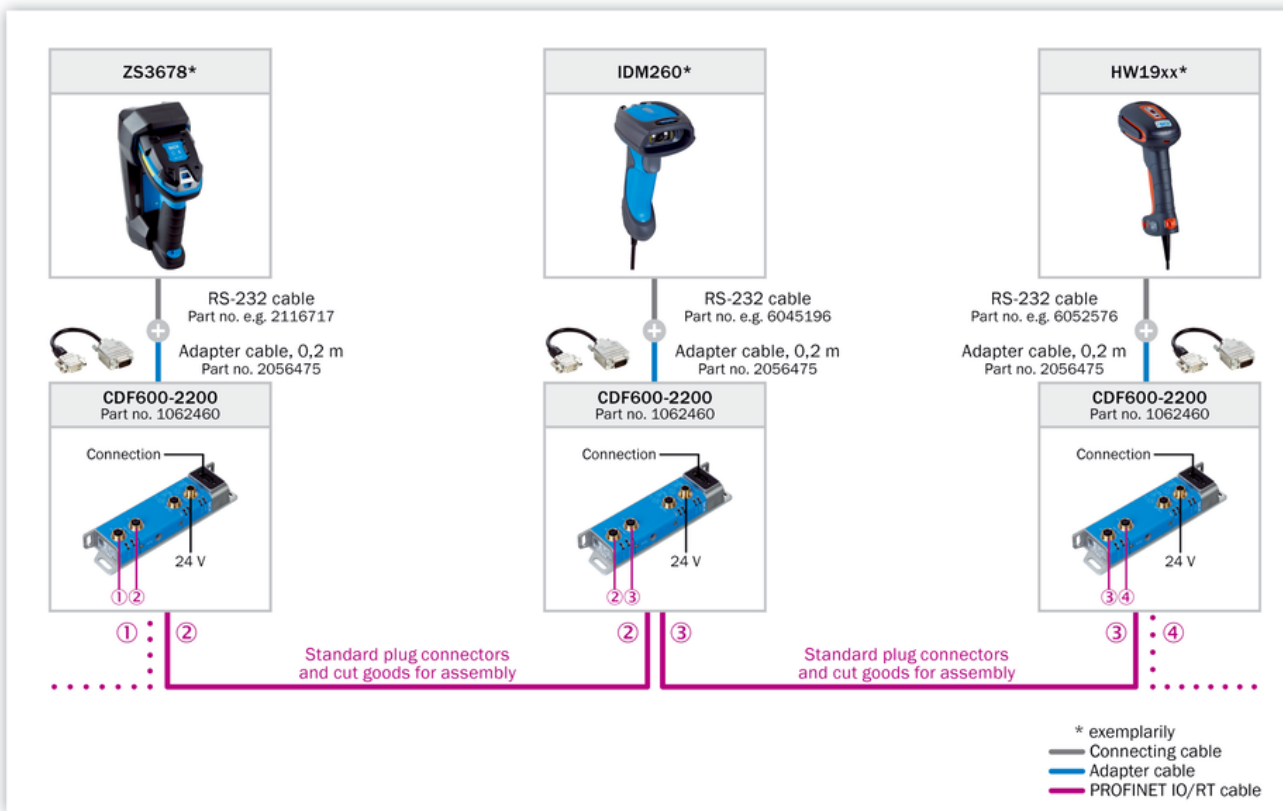

Selection Guide

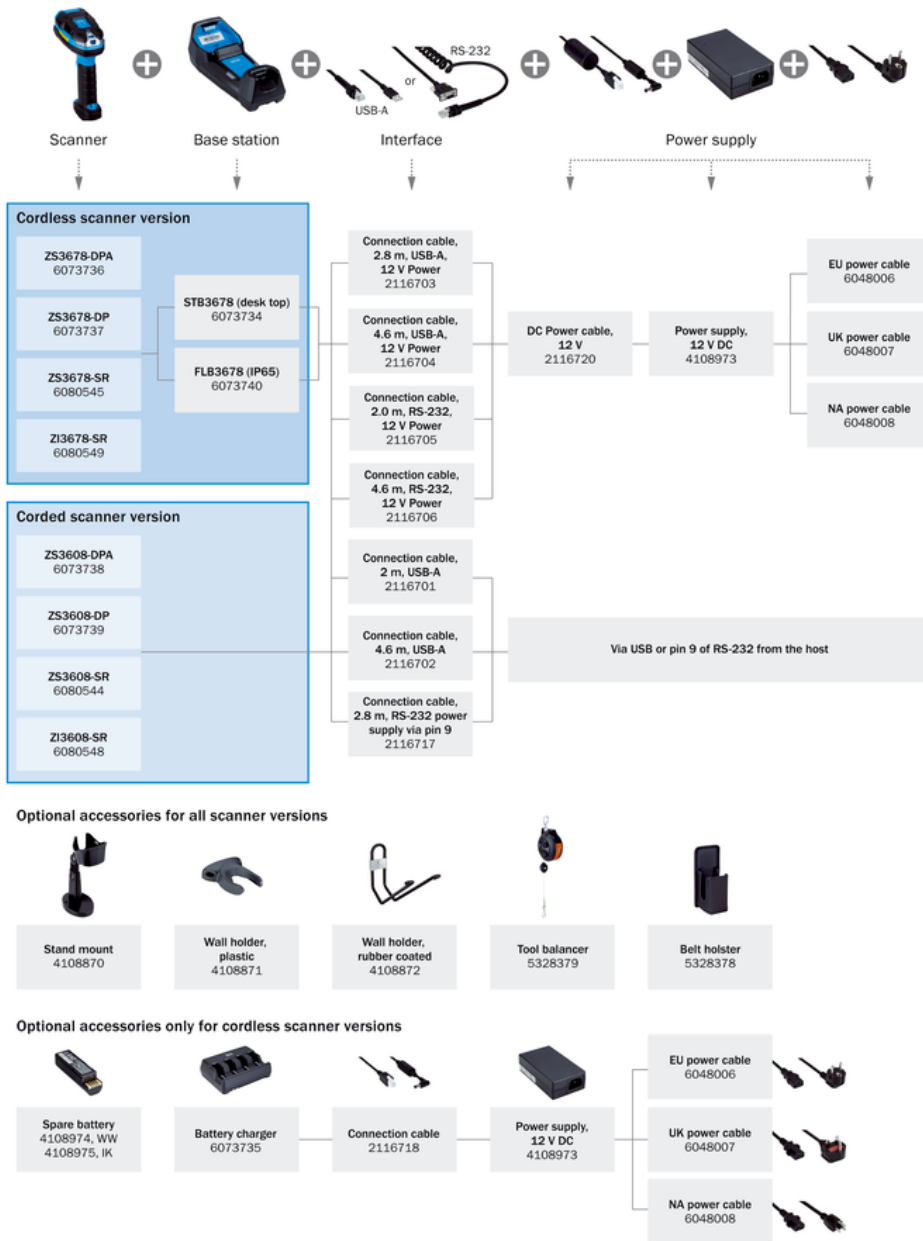

Selection Guide



*) For EtherNet/IP third party gateway is required from e.g. Control or HMS (requires local sourcing).

Recommended accessories

Other models and accessories → www.sick.com/Zx36

	Brief description	Type	part no.
connectors and cables			
	<ul style="list-style-type: none"> • Connection type head A: Female connector, D-Sub, 9-pin, straight • Connection type head B: Male connector, RJ45 • Signal type: RS-232 TTL • Cable: 2 m, straightened cable • Description: RS-232 TTL 	Connection cable (male connector-female connector)	2116705
	<ul style="list-style-type: none"> • Connection type head A: Female connector, D-Sub, 9-pin, straight • Connection type head B: Male connector, RJ45 • Signal type: RS-232 TTL • Cable: 2.8 m, coiled cable • Description: RS-232 TTL 	Connection cable (male connector-female connector)	2116717
	<ul style="list-style-type: none"> • Connection type head A: Male connector, USB-A • Connection type head B: Male connector, RJ45 • Signal type: USB • Cable: 2 m, straightened cable • Description: USB 	Connection cable (male connector-male connector)	2116701
	<ul style="list-style-type: none"> • Connection type head A: Male connector, USB-A • Connection type head B: Male connector, RJ45 • Signal type: USB • Cable: 2.8 m, straightened cable • Description: USB 	Connection cable (male connector-male connector)	2116703
Power supply units and power supply cables			
		Power cable	6048006
	<ul style="list-style-type: none"> • Output voltage: 12 V DC • Output current: 4.16 A 	Power cable	2116720
	<ul style="list-style-type: none"> • Input voltage: 100 V AC ... 240 V AC • Output voltage: 12 V DC • Output current: 4.16 A • Description: Power supply for ZS36xx, battery charger, EA 3600 module (Zebra PWRB-GA12V50W0WW), requires DC and AC line 	Power supply unit	4108973
Mounting systems			
	<ul style="list-style-type: none"> • Description: Adjustable stand, grey, weighted base plate, plastic (Zebra STND-AS0036-07) for ZS36xx 	Stand mount	4108870
	<ul style="list-style-type: none"> • Description: Wall bracket, grey, plastic (Zebra 11-66553-06R) for ZS36xx 	Wall holder	4108871

SICK AT A GLANCE

SICK is one of the leading manufacturers of intelligent sensors and sensor solutions for industrial applications. A unique range of products and services creates the perfect basis for controlling processes securely and efficiently, protecting individuals from accidents and preventing damage to the environment.

We have extensive experience in a wide range of industries and understand their processes and requirements. With intelligent sensors, we can deliver exactly what our customers need. In application centers in Europe, Asia and North America, system solutions are tested and optimized in accordance with customer specifications. All this makes us a reliable supplier and development partner.

Comprehensive services complete our offering: SICK LifeTime Services provide support throughout the machine life cycle and ensure safety and productivity.

For us, that is “Sensor Intelligence.”

WORLDWIDE PRESENCE:

Contacts and other locations –www.sick.com