



ZI3678-SR0F263VZWW

Zx36

MOBILE HANDHELD SCANNERS

SICK
Sensor Intelligence.



Ordering information

Type	part no.
ZI3678-SR0F263VZWW	6080547

Other models and accessories → www.sick.com/Zx36

Detailed technical data

Features

Application	Industrial application
Version	Standard Range (SR)
Country approval	World-wide (except India, Korea)
Scanner design	Wireless variant
Light source	LED, Visible, Red, 617 nm Target, laser, Visible, Red, 655 nm
Reading distance	0 mm ... 1,067 mm
Code resolution	≥ 0.102 mm ¹⁾

¹⁾ Valid for Code 39.

Mechanics/electronics

Supply voltage	5 V DC, ± 10 %, Via host 12 V DC, ± 5 %, External supply
Housing color	Blue, black
Enclosure rating	IP65 IP68
Weight	402 g, incl. rechargeable battery
Dimensions (L x W x H)	132 mm x 77 mm x 185 mm

Performance

Readable code structures	1D codes
Bar code types	Code 39, Code 39 Trioptic, Code 93, Code 11, Codabar/NW7, Code 128, GS1-128 / EAN 128, UPC / EAN / JAN (with addition), MSI/Plessey, Interleaved 2 of 5, Korean 3 of 5, Chinese 2 of 5, Matrix 2 of 5, GS1 DataBar, Australian Post, US Planet, US Postnet, British Post, Japan Post, Dutch KIX Post
Battery power	3,100 mAh, over 100,000 scans with full battery
Code buffer	9,000 Codes (EAN, for scanning in batch mode)

Interfaces

Ethernet	✓, TCP/IP
Type of fieldbus integration	Optional over external fieldbus module CDF600-2
PROFINET	✓

Type of fieldbus integration	Optional over external fieldbus module CDF600-2
Function	PROFINET Single Port, PROFINET Dual Port
EtherCAT®	✓
Type of fieldbus integration	Optional over external fieldbus module CDF600-2
Serial	✓, RS-232 TTL
PROFIBUS DP	✓
Type of fieldbus integration	Optional over external fieldbus module CDF600-2
USB	✓
Function	Keyboard wedge, COM-Port emulation
Bluetooth	✓
Remark	Bluetooth™ V4.0, 2.402 ... 2.4830 GHz
Function	Wireless operating range up to 100 m (free view), batch function for expansion of the wireless radius, up to seven scanners communicate with one base station
Data transmission rate	≤ 3 Mbit/s
Optical indicators	3 LEDs (operational status, good read, radio connection status)
Acoustic indicators	Beeper, can be switched off
Vibration	Yes
Configuration software	Z-Up Tool

Ambient data

Shock resistance	Multiple falls Onto concrete from a height of 3 m
Ambient operating temperature	-20 °C ... +50 °C
Storage temperature	-40 °C ... +70 °C
Permissible relative humidity	95 %, Non-condensing
Ambient light immunity	108,000 lx

General notes

Items supplied	The rechargeable battery is included with delivery
Note	Not free of paint wetting impairment substances.

Certificates

UN38.3 Test Summary Report	✓
-----------------------------------	---

Classifications

ECLASS 5.0	27280101
ECLASS 5.1.4	27280101
ECLASS 6.0	27280101
ECLASS 6.2	27280101
ECLASS 7.0	27280101
ECLASS 8.0	27280101
ECLASS 8.1	27280101
ECLASS 9.0	27280101
ECLASS 10.0	27280101
ECLASS 11.0	27280101
ECLASS 12.0	27280101

ETIM 5.0	EC002550
ETIM 6.0	EC002550
ETIM 7.0	EC002550
ETIM 8.0	EC002550
UNSPSC 16.0901	43211701

Connection diagram AUX looping

Looping-in via AUX

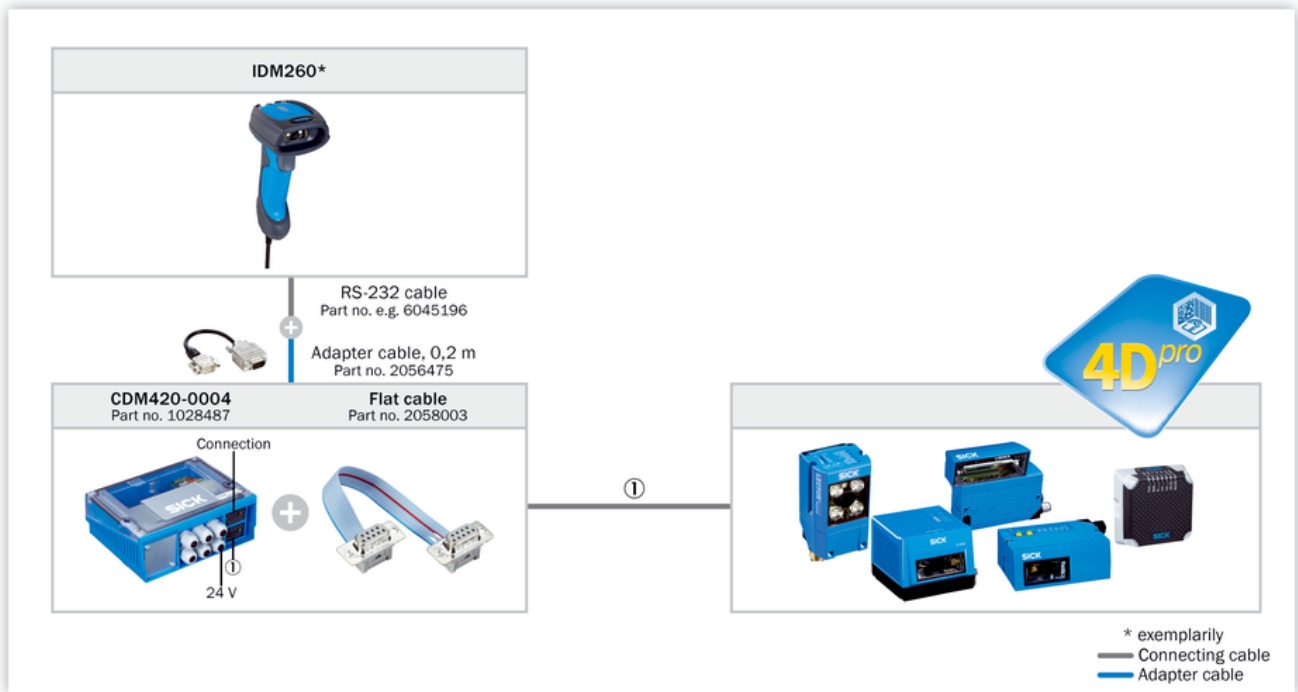

Connection diagram EtherCAT®

EtherCAT®

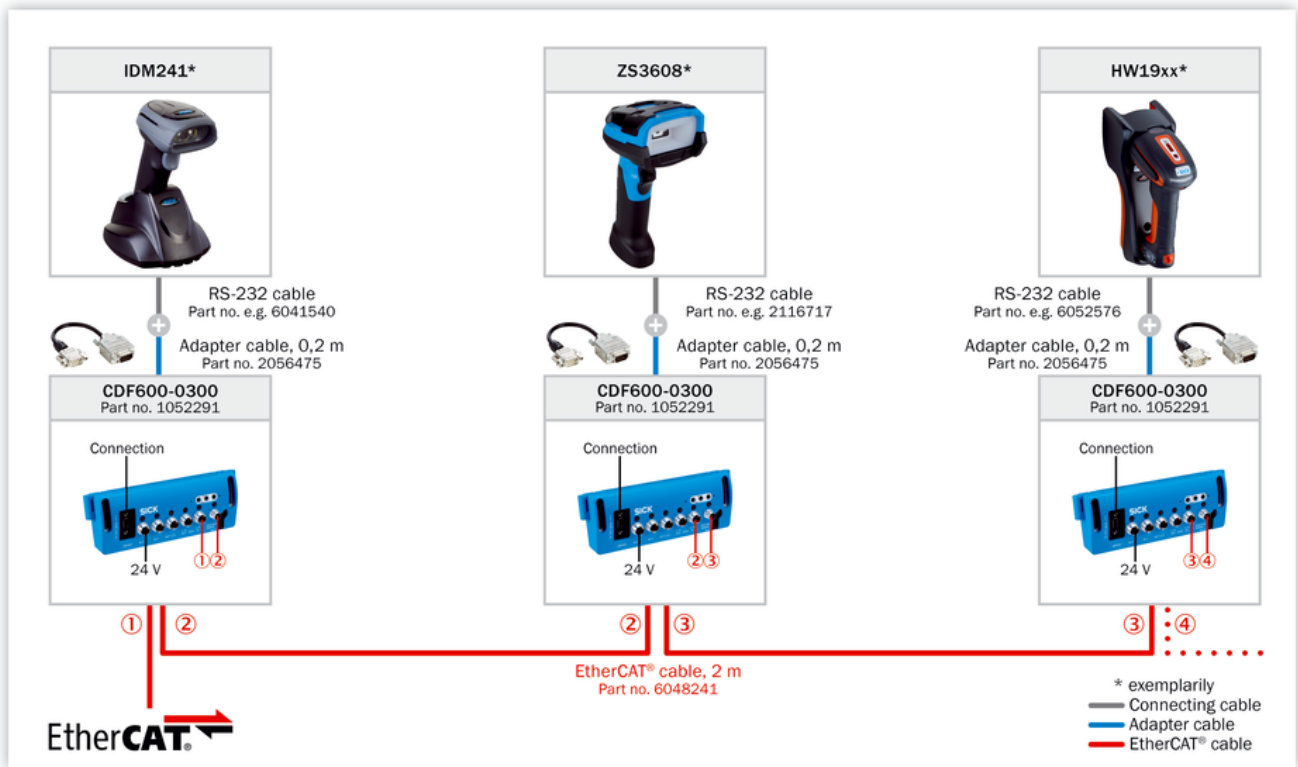

Connection diagram PROFIBUS DP

PROFIBUS DP

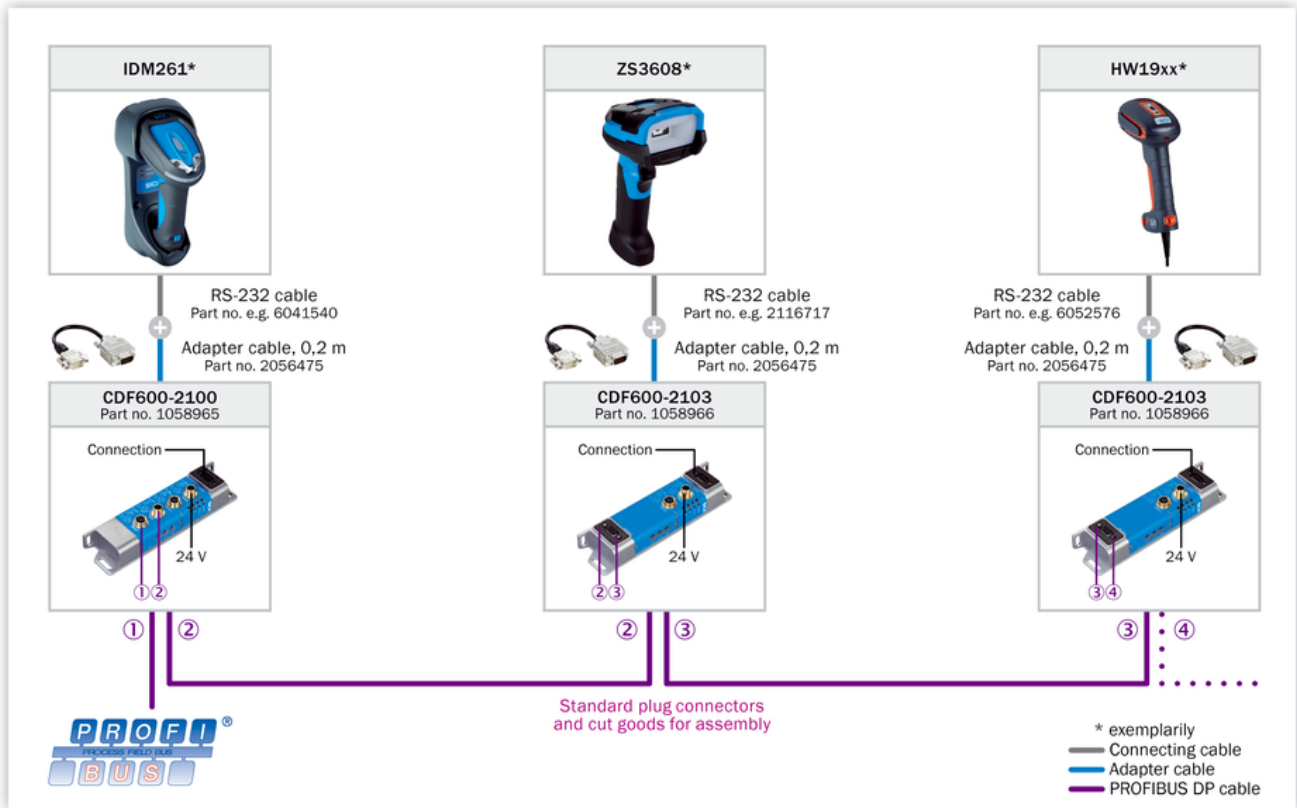

Connection diagram PROFINET IO/RT

PROFINET IO/RT

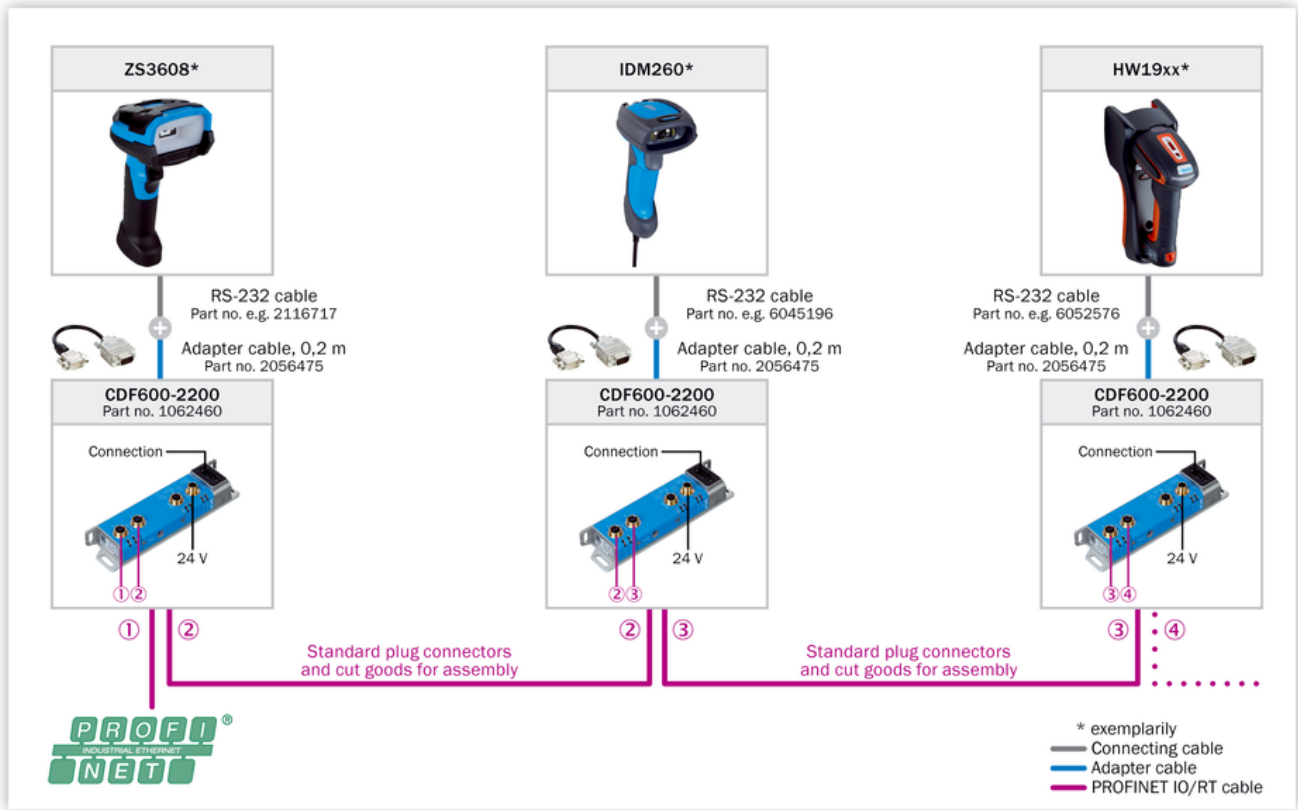

Connection diagram Ethernet TCP/IP

Ethernet TCP/IP

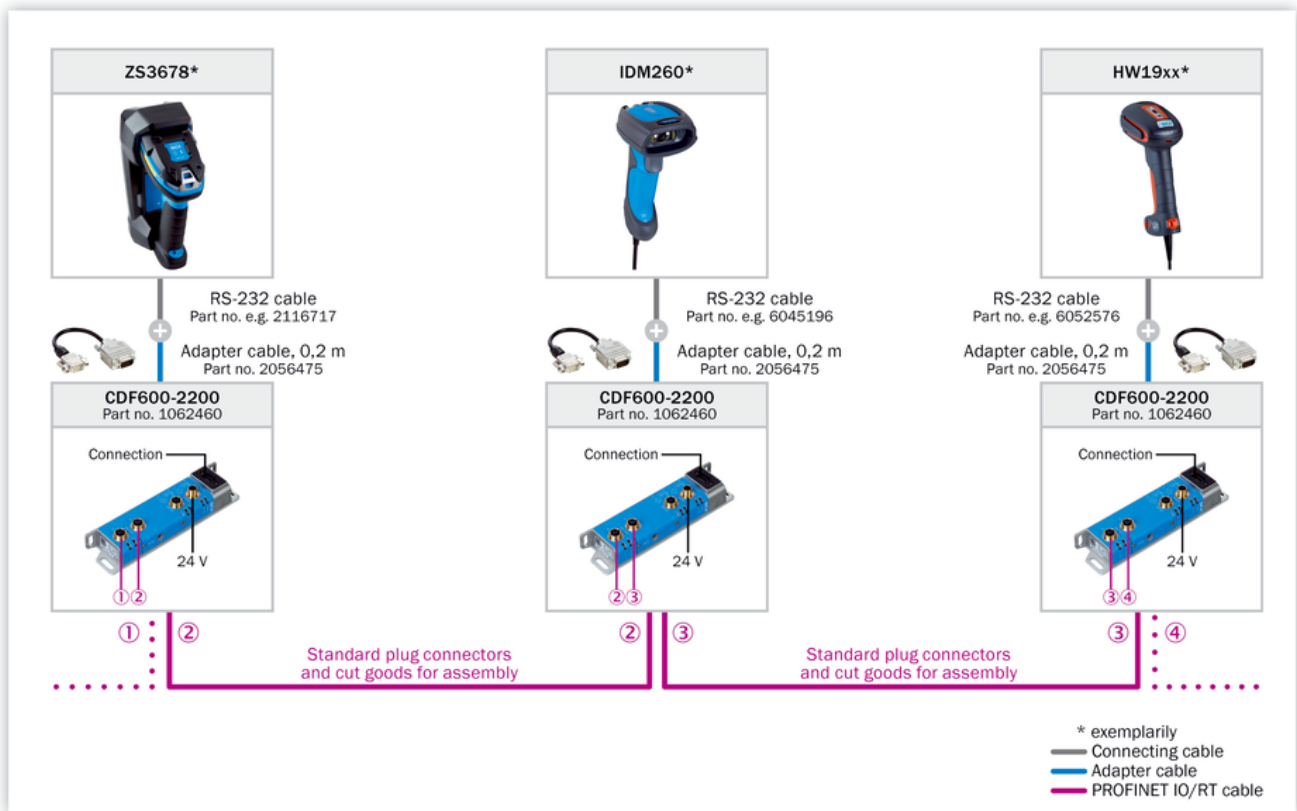

Selection Guide







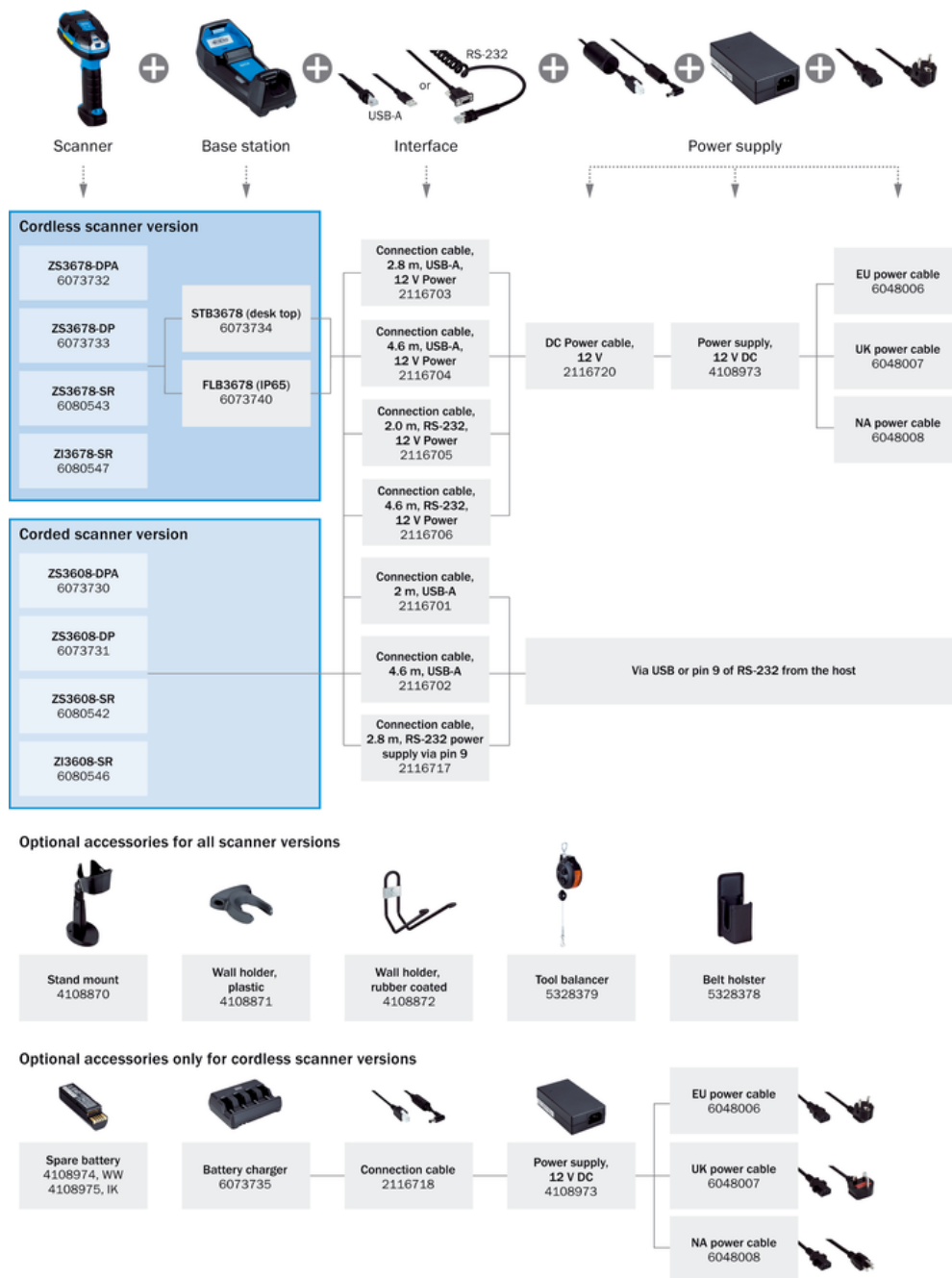

*) For EtherNet/IP third party gateway is required from e.g. Comtrol or HMS (requires local sourcing).

Selection Guide ZS36x8 DPM



Recommended accessories

Other models and accessories → www.sick.com/Zx36

	Brief description	Type	part no.
connectors and cables			
	<ul style="list-style-type: none"> • Connection type head A: Female connector, D-Sub, 9-pin, straight • Connection type head B: Male connector, RJ45 • Signal type: RS-232 TTL • Cable: 2 m, straightened cable • Description: RS-232 TTL 	Connection cable (male connector-female connector)	2116705
	<ul style="list-style-type: none"> • Connection type head A: Female connector, D-Sub, 9-pin, straight • Connection type head B: Male connector, RJ45 • Signal type: RS-232 TTL • Cable: 2.8 m, coiled cable • Description: RS-232 TTL 	Connection cable (male connector-female connector)	2116717
	<ul style="list-style-type: none"> • Connection type head A: Male connector, USB-A • Connection type head B: Male connector, RJ45 • Signal type: USB • Cable: 2 m, straightened cable • Description: USB 	Connection cable (male connector-male connector)	2116701
	<ul style="list-style-type: none"> • Connection type head A: Male connector, USB-A • Connection type head B: Male connector, RJ45 • Signal type: USB • Cable: 2.8 m, straightened cable • Description: USB 	Connection cable (male connector-male connector)	2116703
Power supply units and power supply cables			
		Power cable	6048006
	<ul style="list-style-type: none"> • Output voltage: 12 V DC • Output current: 4.16 A 	Power cable	2116720
	<ul style="list-style-type: none"> • Input voltage: 100 V AC ... 240 V AC • Output voltage: 12 V DC • Output current: 4.16 A • Description: Power supply for ZS36xx, battery charger, EA 3600 module (Zebra PWRB-GA12V50W0WW), requires DC and AC line 	Power supply unit	4108973
rechargeable batteries and base stations			
	<ul style="list-style-type: none"> • Description: Charging and WPAN receiver station for ZS36xx, desk top (Zebra STB3678-C126F3WW), may require power supply unit (part number 4108973, Zebra PWRB-GA12V50W0WW), DC cable (part number 2116720, Zebra CBL-DC-451A1-01) and AC cable 	STB3678 base station	6073734

SICK AT A GLANCE

SICK is one of the leading manufacturers of intelligent sensors and sensor solutions for industrial applications. A unique range of products and services creates the perfect basis for controlling processes securely and efficiently, protecting individuals from accidents and preventing damage to the environment.

We have extensive experience in a wide range of industries and understand their processes and requirements. With intelligent sensors, we can deliver exactly what our customers need. In application centers in Europe, Asia and North America, system solutions are tested and optimized in accordance with customer specifications. All this makes us a reliable supplier and development partner.

Comprehensive services complete our offering: SICK LifeTime Services provide support throughout the machine life cycle and ensure safety and productivity.

For us, that is “Sensor Intelligence.”

WORLDWIDE PRESENCE:

Contacts and other locations –www.sick.com