



ZS3608-SR20263VZWW

Zx36

MOBILE HANDHELD SCANNERS

**SICK**  
Sensor Intelligence.



### Ordering information

Type	part no.
ZS3608-SR20263VZWW	6080542

Other models and accessories → [www.sick.com/Zx36](http://www.sick.com/Zx36)

### Detailed technical data

#### Features

<b>Application</b>	Industrial application
<b>Version</b>	Standard Range (SR)
<b>Country approval</b>	World-wide (except India, Korea)
<b>Scanner design</b>	Cable connection variant
<b>Light source</b>	LED, Visible, Red, 660 nm Target, laser, Visible, Red, 610 nm
<b>Reading distance</b>	30 mm ... 1,520 mm
<b>Code resolution</b>	≥ 0.13 mm <sup>1)</sup> ≥ 0.19 mm <sup>2)</sup>

<sup>1)</sup> Valid for Code 128.

<sup>2)</sup> Valid for Data Matrix code.

#### Mechanics/electronics

<b>Supply voltage</b>	5 V DC, ± 10 %, Via host 12 V DC, ± 5 %, External supply
<b>Housing color</b>	Blue, black
<b>Enclosure rating</b>	IP65 IP68
<b>Weight</b>	305 g
<b>Dimensions (L x W x H)</b>	132 mm x 77 mm x 185 mm

#### Performance

<b>Readable code structures</b>	1D codes, 2D codes, Stacked, Digimarc®
<b>Bar code types</b>	Code 39, Code 39 Trioptic, Code 32, Code 93, Code 11, Codabar, Code 128, GS1-128 / EAN 128, UPC / EAN / JAN (with addition), MSI/Plessey, Interleaved 2 of 5, Standard and Industrial 2 of 5, Matrix 2 of 5, GS1 DataBar, DotCode, OCR-A/B, Australian Post, US Planet, US Postnet, British Post, Japan Post, Dutch KIX Post, OCR symbologies
<b>2D code types</b>	Data Matrix, QR code, MicroQR-Code, Aztec, MaxiCode, TLC-39, Chinese Sensible (Han Xin)
<b>Stacked code types</b>	PDF417, MicroPDF417, Code 49, Code 16K, Composite, Codablock F
<b>Code alignment</b>	Omni-directional
<b>Battery power</b>	3,100 mAh, over 100,000 scans with full battery
<b>Code buffer</b>	9,000 Codes (EAN, for scanning in batch mode)

Interfaces

<b>Ethernet</b>		✓ , TCP/IP
	Type of fieldbus integration	Optional over external fieldbus module CDF600-2
<b>PROFINET</b>		✓
	Type of fieldbus integration	Optional over external fieldbus module CDF600-2
	Function	PROFINET Single Port, PROFINET Dual Port
<b>EtherCAT®</b>		✓
	Type of fieldbus integration	Optional over external fieldbus module CDF600-2
<b>Serial</b>		✓ , RS-232 TTL
<b>PROFIBUS DP</b>		✓
	Type of fieldbus integration	Optional over external fieldbus module CDF600-2
<b>USB</b>		✓
	Function	Keyboard wedge, COM-Port emulation
<b>Optical indicators</b>		2 LEDs (operational status, good read)
<b>Acoustic indicators</b>		Beeper, can be switched off
<b>Vibration</b>		Yes
<b>Configuration software</b>		Z-Up Tool

Ambient data

<b>Shock resistance</b>	Multiple falls Onto concrete from a height of 3 m
<b>Ambient operating temperature</b>	-30 °C ... +50 °C
<b>Storage temperature</b>	-40 °C ... +70 °C
<b>Permissible relative humidity</b>	95 %, Non-condensing
<b>Ambient light immunity</b>	108,000 lx

General notes

<b>Note</b>	Not free of paint wetting impairment substances.
-------------	--

Classifications

<b>ECLASS 5.0</b>	27280101
<b>ECLASS 5.1.4</b>	27280101
<b>ECLASS 6.0</b>	27280101
<b>ECLASS 6.2</b>	27280101
<b>ECLASS 7.0</b>	27280101
<b>ECLASS 8.0</b>	27280101
<b>ECLASS 8.1</b>	27280101
<b>ECLASS 9.0</b>	27280101
<b>ECLASS 10.0</b>	27280101
<b>ECLASS 11.0</b>	27280101
<b>ECLASS 12.0</b>	27280101
<b>ETIM 5.0</b>	EC002550
<b>ETIM 6.0</b>	EC002550
<b>ETIM 7.0</b>	EC002550
<b>ETIM 8.0</b>	EC002550

UNSPSC 16.0901

43211701

Connection diagram AUX looping

Looping-in via AUX

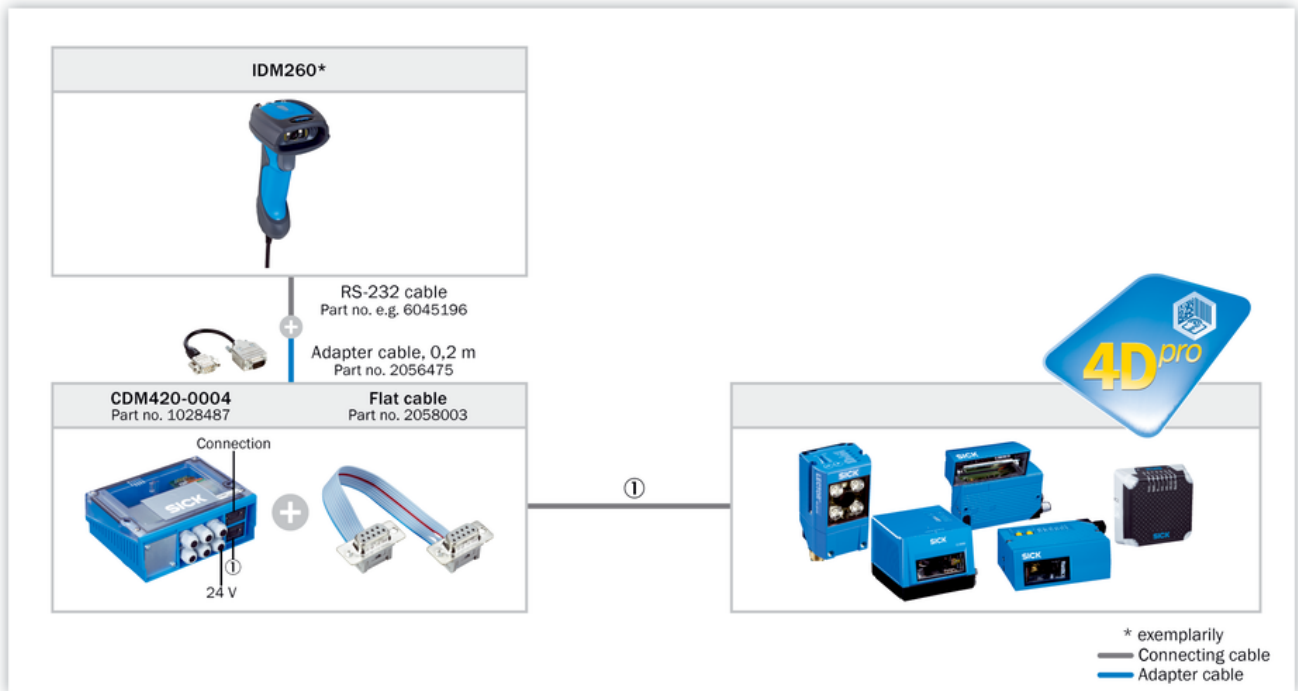

Connection diagram EtherCAT®

EtherCAT®

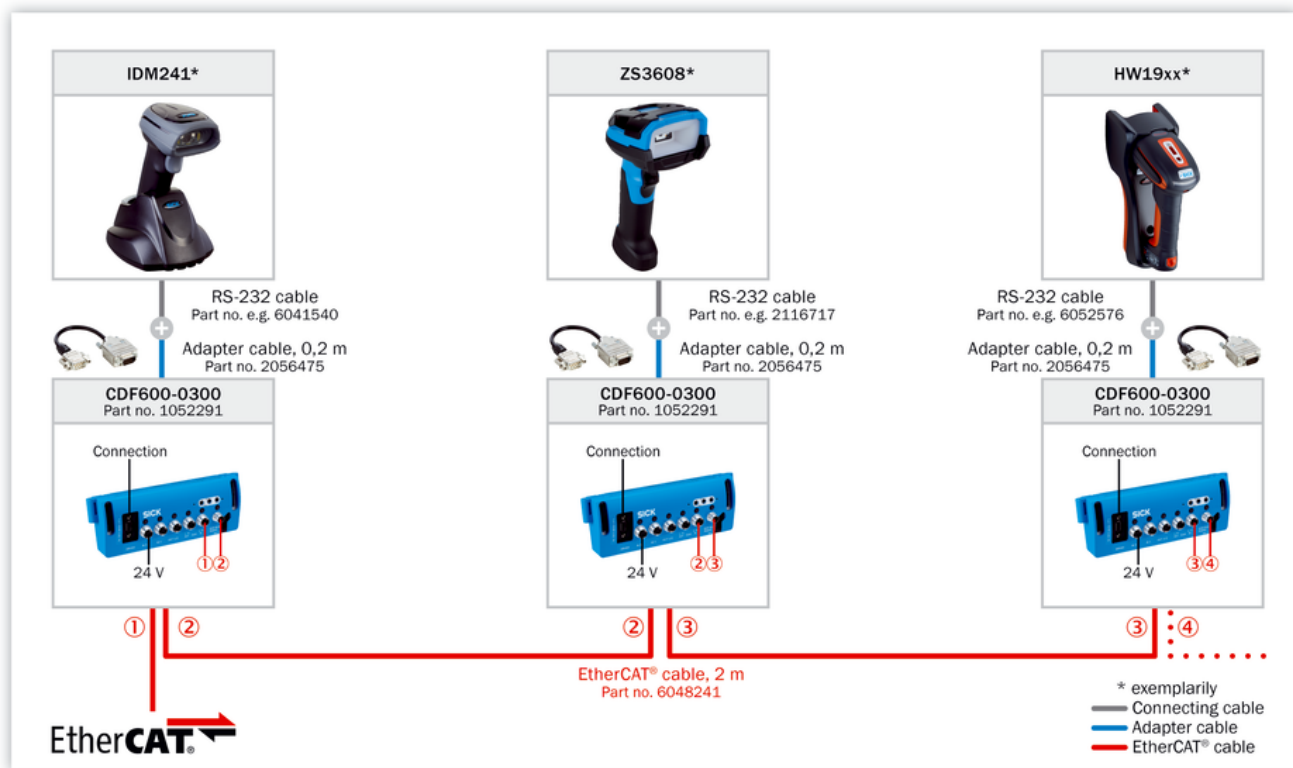

### Connection diagram PROFIBUS DP

#### PROFIBUS DP

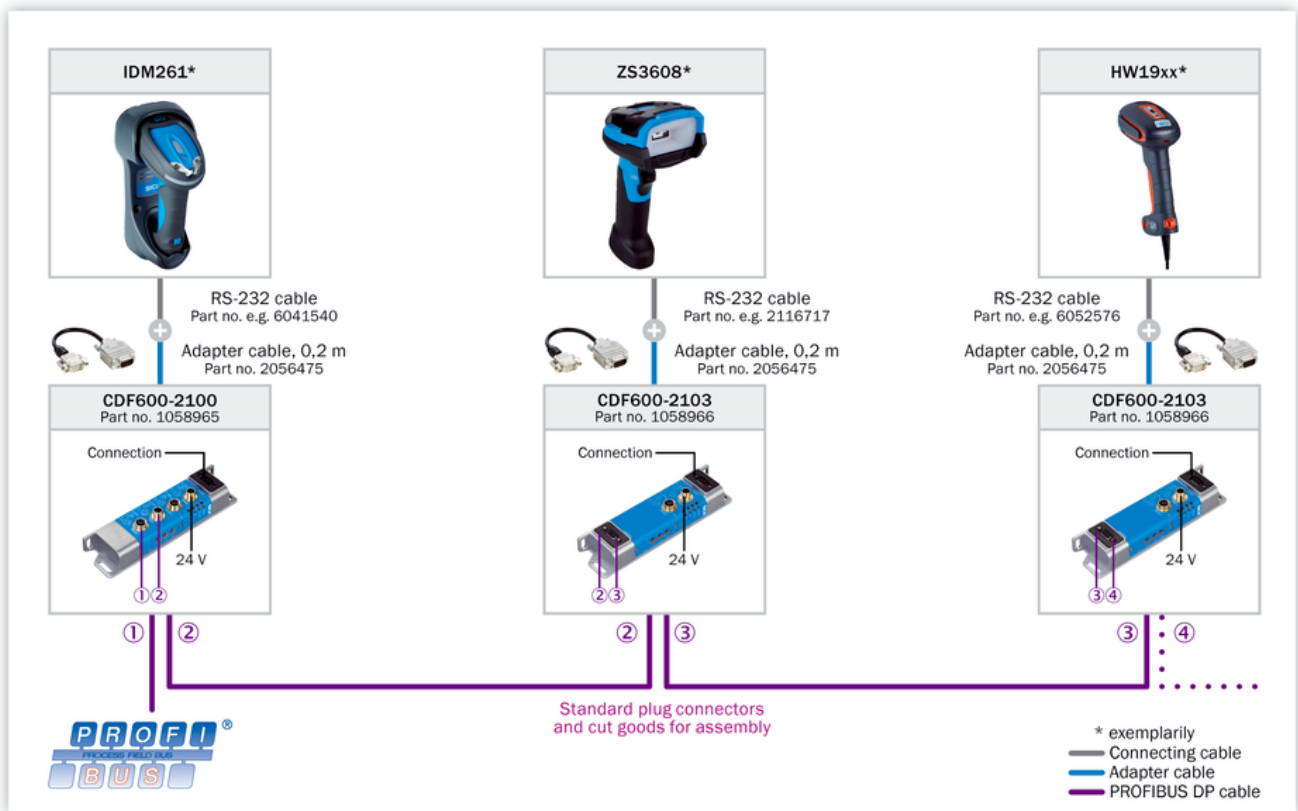

Connection diagram PROFINET IO/RT

PROFINET IO/RT

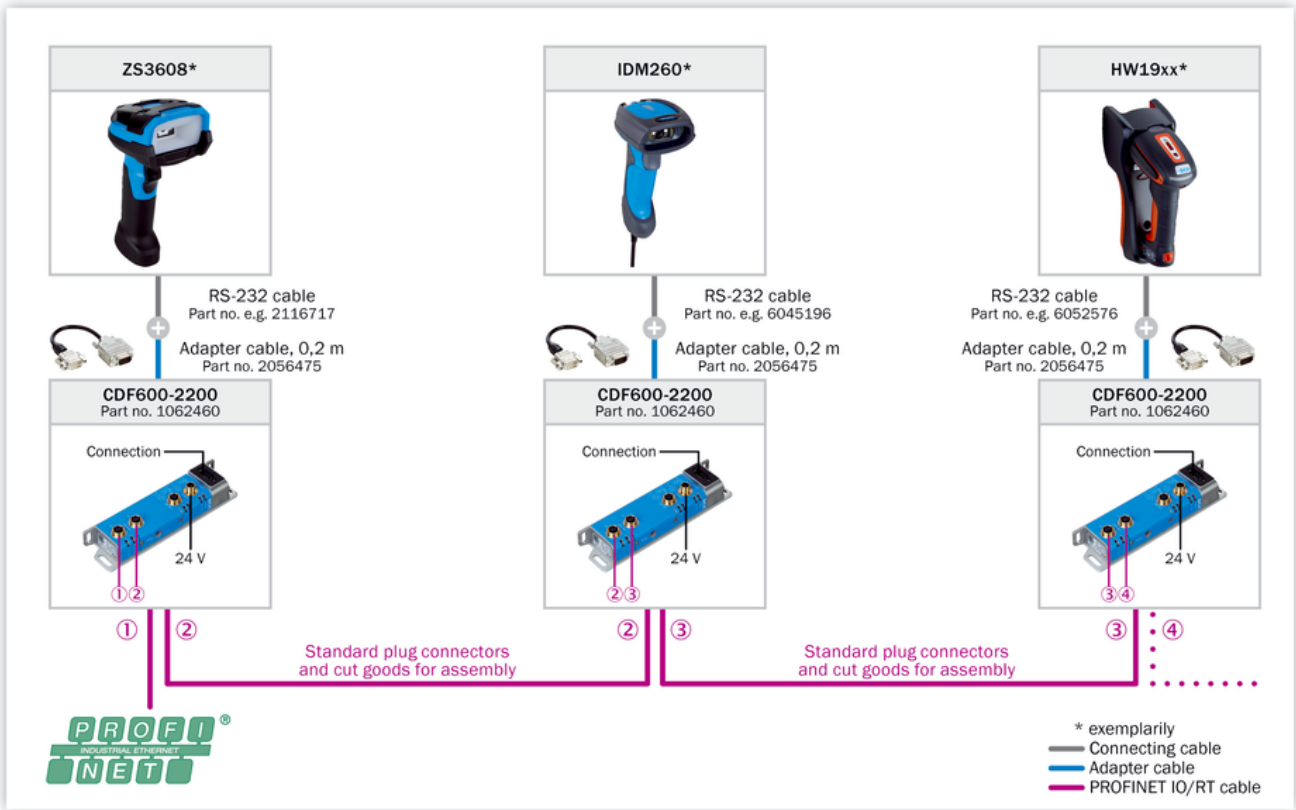

Connection diagram Ethernet TCP/IP

Ethernet TCP/IP

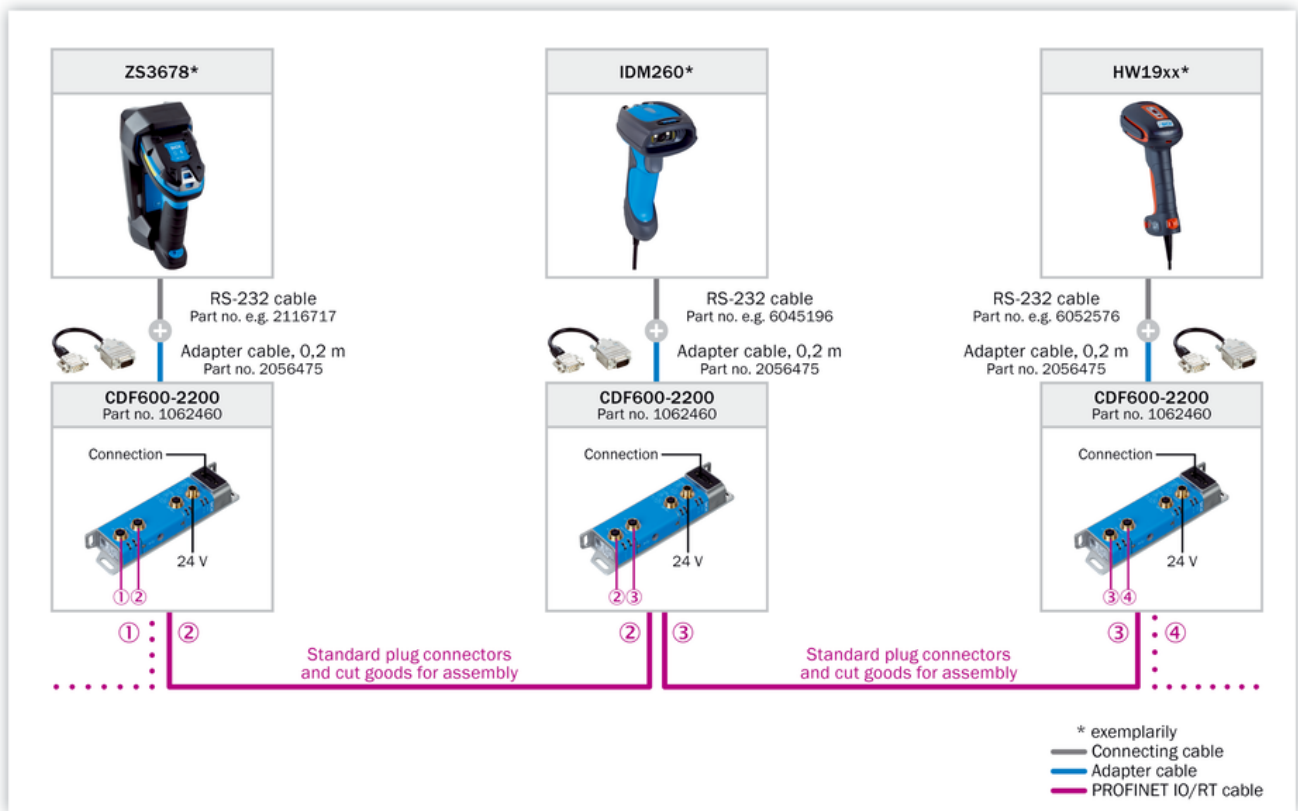

Selection Guide



\*) For EtherNet/IP third party gateway is required from e.g. Comtrol or HMS (requires local sourcing).

### Selection Guide ZS36x8 DPM

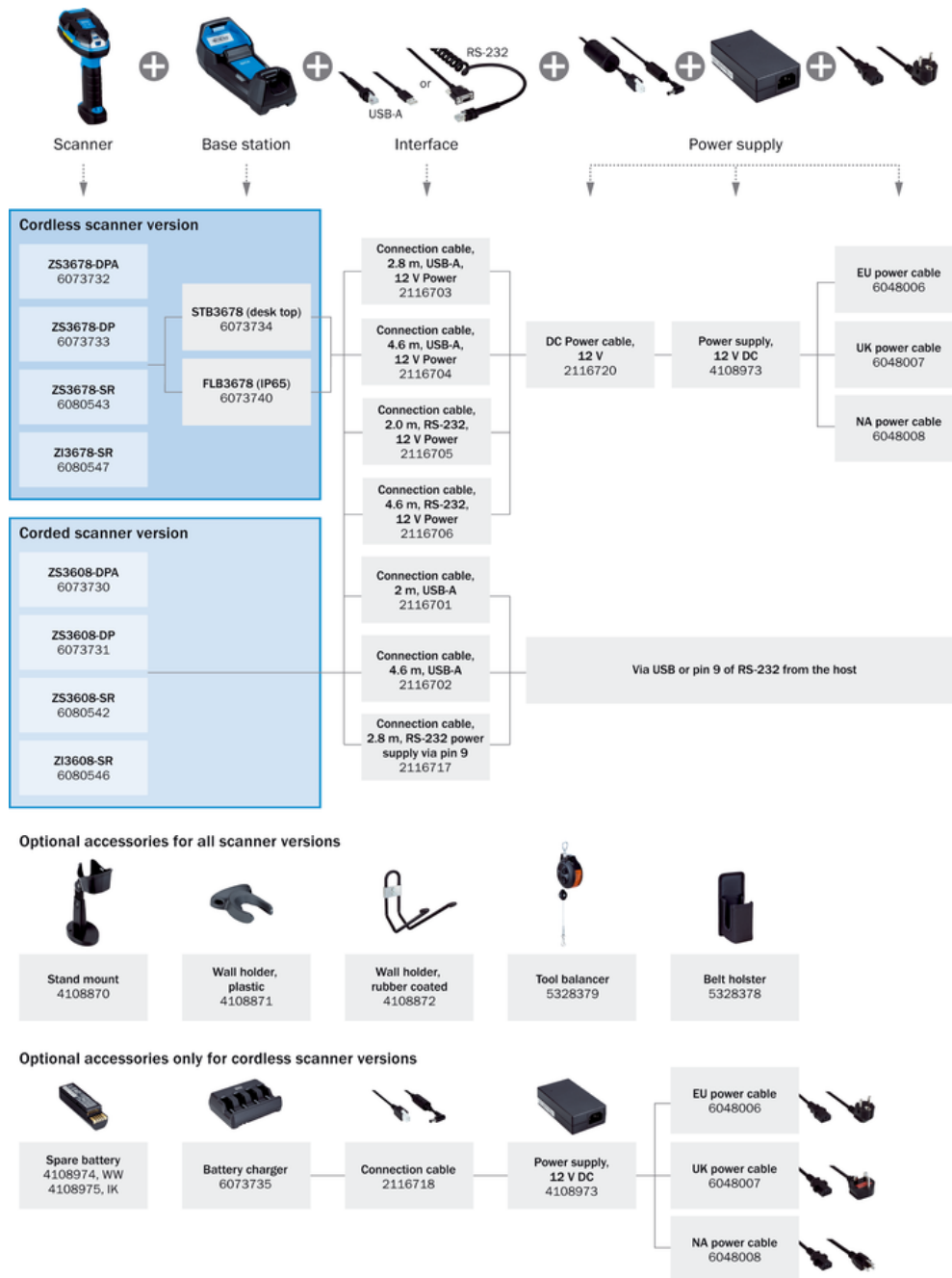

## Recommended accessories

Other models and accessories → [www.sick.com/Zx36](http://www.sick.com/Zx36)

	Brief description	Type	part no.
<b>connectors and cables</b>			
	<ul style="list-style-type: none"> <li>• <b>Connection type head A:</b> Female connector, D-Sub, 9-pin, straight</li> <li>• <b>Connection type head B:</b> Male connector, RJ45</li> <li>• <b>Signal type:</b> RS-232 TTL</li> <li>• <b>Cable:</b> 2 m, straightened cable</li> <li>• <b>Description:</b> RS-232 TTL</li> </ul>	Connection cable (male connector-female connector)	2116705
	<ul style="list-style-type: none"> <li>• <b>Connection type head A:</b> Female connector, D-Sub, 9-pin, straight</li> <li>• <b>Connection type head B:</b> Male connector, RJ45</li> <li>• <b>Signal type:</b> RS-232 TTL</li> <li>• <b>Cable:</b> 2.8 m, coiled cable</li> <li>• <b>Description:</b> RS-232 TTL</li> </ul>	Connection cable (male connector-female connector)	2116717
	<ul style="list-style-type: none"> <li>• <b>Connection type head A:</b> Male connector, USB-A</li> <li>• <b>Connection type head B:</b> Male connector, RJ45</li> <li>• <b>Signal type:</b> USB</li> <li>• <b>Cable:</b> 2 m, straightened cable</li> <li>• <b>Description:</b> USB</li> </ul>	Connection cable (male connector-male connector)	2116701
	<ul style="list-style-type: none"> <li>• <b>Connection type head A:</b> Male connector, USB-A</li> <li>• <b>Connection type head B:</b> Male connector, RJ45</li> <li>• <b>Signal type:</b> USB</li> <li>• <b>Cable:</b> 2.8 m, straightened cable</li> <li>• <b>Description:</b> USB</li> </ul>	Connection cable (male connector-male connector)	2116703
<b>Power supply units and power supply cables</b>			
		Power cable	6048006
	<ul style="list-style-type: none"> <li>• <b>Output voltage:</b> 12 V DC</li> <li>• <b>Output current:</b> 4.16 A</li> </ul>	Power cable	2116720
	<ul style="list-style-type: none"> <li>• <b>Input voltage:</b> 100 V AC ... 240 V AC</li> <li>• <b>Output voltage:</b> 12 V DC</li> <li>• <b>Output current:</b> 4.16 A</li> <li>• <b>Description:</b> Power supply for ZS36xx, battery charger, EA 3600 module (Zebra PWRB-GA12V50W0WW), requires DC and AC line</li> </ul>	Power supply unit	4108973
<b>Mounting systems</b>			
	<ul style="list-style-type: none"> <li>• <b>Description:</b> Adjustable stand, grey, weighted base plate, plastic (Zebra STND-AS0036-07) for ZS36xx</li> </ul>	Stand mount	4108870
	<ul style="list-style-type: none"> <li>• <b>Description:</b> Wall bracket, grey, plastic (Zebra 11-66553-06R) for ZS36xx</li> </ul>	Wall holder	4108871

## SICK AT A GLANCE

SICK is one of the leading manufacturers of intelligent sensors and sensor solutions for industrial applications. A unique range of products and services creates the perfect basis for controlling processes securely and efficiently, protecting individuals from accidents and preventing damage to the environment.

We have extensive experience in a wide range of industries and understand their processes and requirements. With intelligent sensors, we can deliver exactly what our customers need. In application centers in Europe, Asia and North America, system solutions are tested and optimized in accordance with customer specifications. All this makes us a reliable supplier and development partner.

Comprehensive services complete our offering: SICK LifeTime Services provide support throughout the machine life cycle and ensure safety and productivity.

For us, that is “Sensor Intelligence.”

## WORLDWIDE PRESENCE:

Contacts and other locations –[www.sick.com](http://www.sick.com)