



# IDM261-311S USB Kit

IDM

MOBILE HANDHELD SCANNERS

**SICK**  
Sensor Intelligence.



### Ordering information

Type	part no.
IDM261-311S USB Kit	6068401

**Included in delivery:** IDM261-311S (1), Power supply unit (1), Base station (1)

Other models and accessories → [www.sick.com/IDM](http://www.sick.com/IDM)



### Detailed technical data

#### Features

<b>Application</b>	Industrial application
<b>Scanner design</b>	Wireless variant
<b>Sensor resolution</b>	1,280 px x 800 px
<b>Light source</b>	LED, Visible, Red, 660 nm
<b>Alignment aid</b>	Laser, Red, 630 nm
<b>Laser class</b>	1 (EN/IEC 60825-1:2014)
<b>Reading distance</b>	30 mm ... 400 mm
<b>Code resolution</b>	≥ 0.07 mm <sup>1)</sup> ≥ 0.13 mm <sup>2)</sup>

<sup>1)</sup> Valid for Code 39.

<sup>2)</sup> Valid for Data Matrix code.

#### Mechanics/electronics

<b>Supply voltage</b>	5 V DC, ± 5 %
<b>Current consumption</b>	Operation (charge status incl. base station): 750 mA Standby: 175 mA
<b>Housing color</b>	Blue, gray
<b>Enclosure rating</b>	IP65
<b>Weight</b>	228 g
<b>Dimensions (L x W x H)</b>	104 mm x 76.3 mm x 176 mm
<b>MTBF</b>	100,000 h

#### Performance

<b>Readable code structures</b>	1D codes, 2D codes, Stacked
<b>Bar code types</b>	Code 39, Code 39 Trioptic, Code 32, Code 93, Code 11, Codabar, Code 128, GS1-128 / EAN 128, UPC / EAN / JAN (with addition), MSI/Plessey, UK/Plessey, IATA, Interleaved 2 of 5, Standard and Industrial 2 of 5, Matrix 2 of 5, Telepen, GS1 DataBar, Australian Post, China Post,

	German Post, US Planet, US Postnet, British Post, Intelligent Mail, Japan Post, Korean Post, Dutch KIX Post
<b>2D code types</b>	Data Matrix, QR code, MicroQR-Code, Aztec, MaxiCode
<b>Stacked code types</b>	PDF417, MicroPDF417, Code 49, Code 16K, Composite, Codablock F
<b>Battery power</b>	Over 60,000 scans with full battery
<b>Code buffer</b>	5,000 Codes (EAN, for scanning in batch mode), 100,000 Codes (EAN, for out of range scanning)

## Interfaces

<b>USB</b>	✓
Function	Keyboard wedge, COM-Port emulation
<b>Optical indicators</b>	2 LEDs (good read, charge of battery , radio connection status)
<b>Acoustic indicators</b>	Beeper, can be switched off
<b>Vibration</b>	Yes
<b>Configuration software</b>	IDM Setup Tool

## Ambient data

<b>Shock resistance</b>	50 drops from 2 m height on concrete
<b>Ambient operating temperature</b>	-20 °C ... +50 °C
<b>Storage temperature</b>	-40 °C ... +70 °C
<b>Relative humidity</b>	95 %, Non-condensing
<b>Ambient light immunity</b>	100,000 lx

## General notes

<b>Items supplied</b>	The rechargeable battery is included with delivery
-----------------------	--

## Certificates

<b>EU declaration of conformity</b>	✓
<b>ACMA declaration of conformity</b>	✓
<b>China RoHS</b>	✓
<b>KC Mark certificate</b>	✓
<b>Bluetooth</b>	✓

## Classifications

<b>ECLASS 5.0</b>	27280101
<b>ECLASS 5.1.4</b>	27280101
<b>ECLASS 6.0</b>	27280101
<b>ECLASS 6.2</b>	27280101
<b>ECLASS 7.0</b>	27280101
<b>ECLASS 8.0</b>	27280101
<b>ECLASS 8.1</b>	27280101
<b>ECLASS 9.0</b>	27280101
<b>ECLASS 10.0</b>	27280101
<b>ECLASS 11.0</b>	27280101
<b>ECLASS 12.0</b>	27280101
<b>ETIM 5.0</b>	EC002550

<b>ETIM 6.0</b>	EC002550
<b>ETIM 7.0</b>	EC002550
<b>ETIM 8.0</b>	EC002550
<b>UNSPSC 16.0901</b>	43211701

### Connection diagram PROFINET IO/RT

#### PROFINET IO/RT

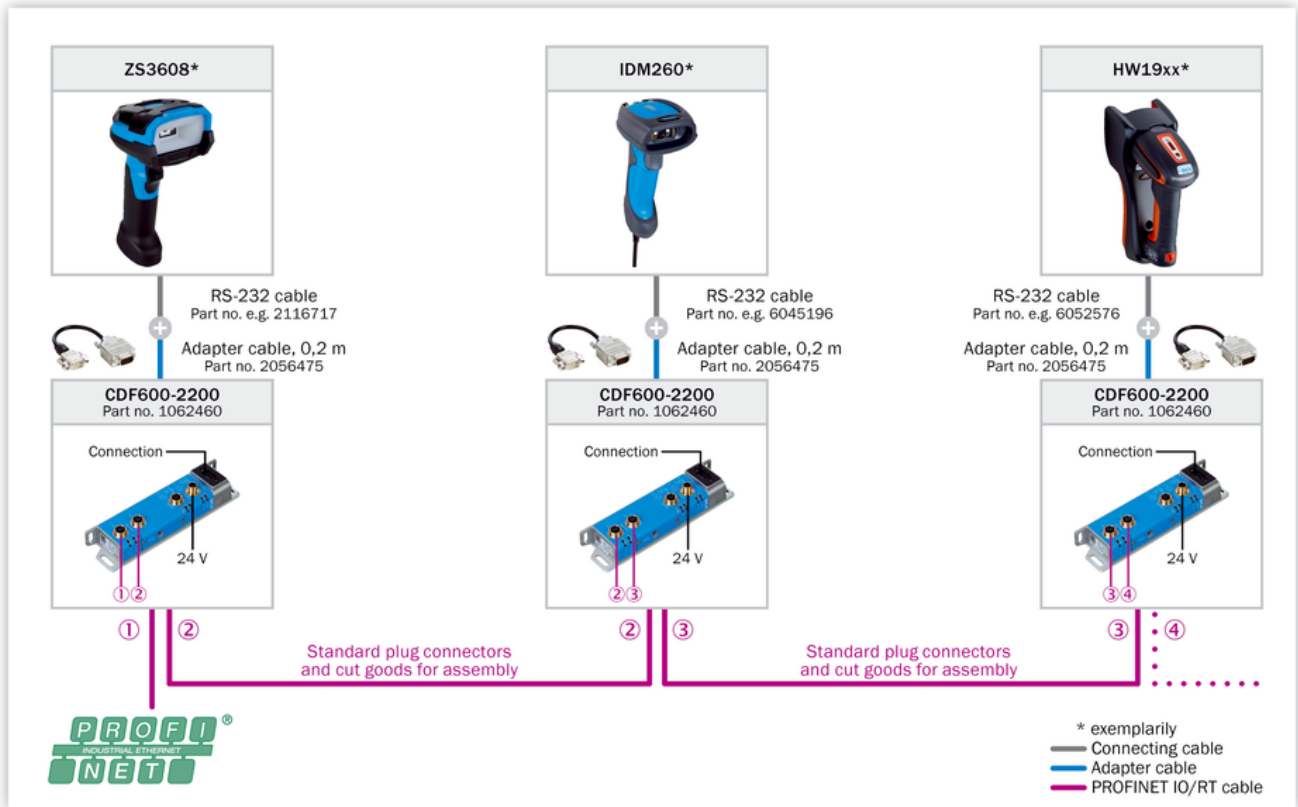

Connection diagram PROFIBUS DP

PROFIBUS DP

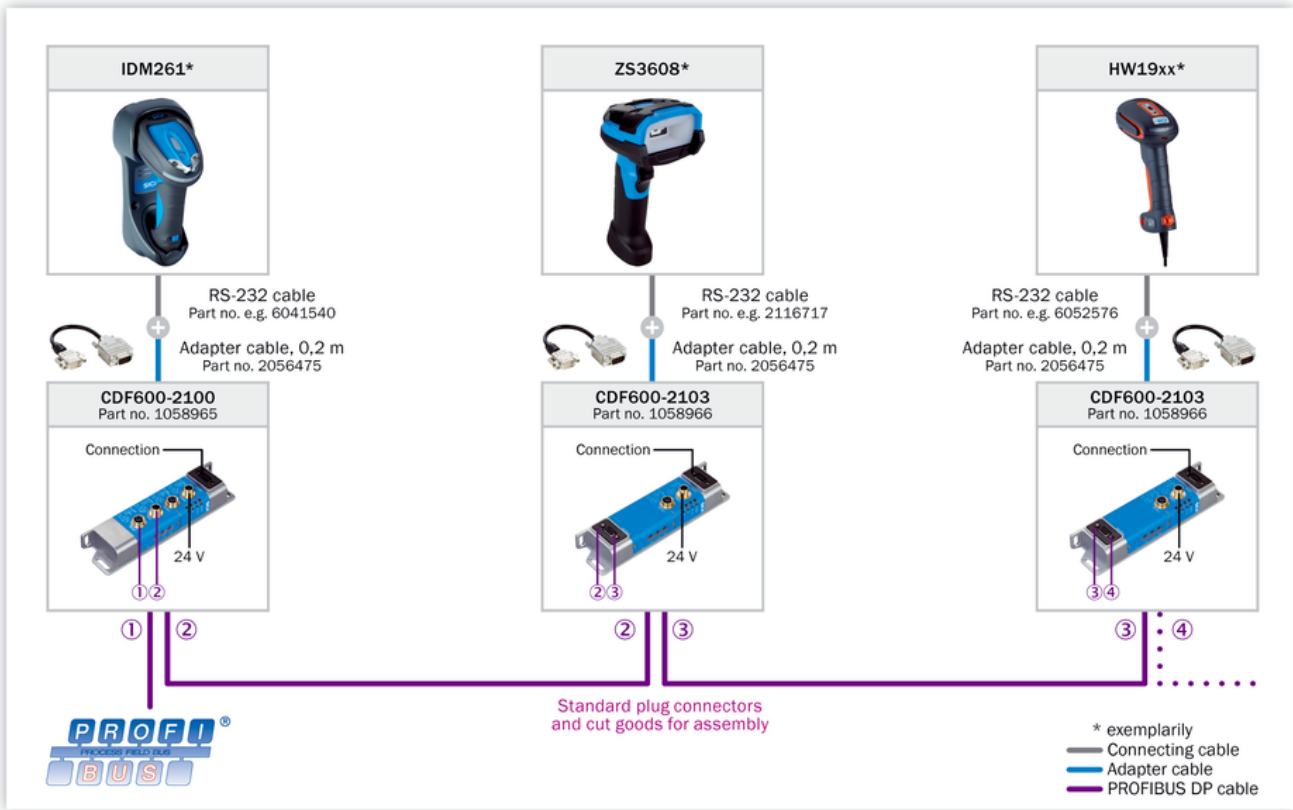

Connection diagram Ethernet TCP/IP

Ethernet TCP/IP

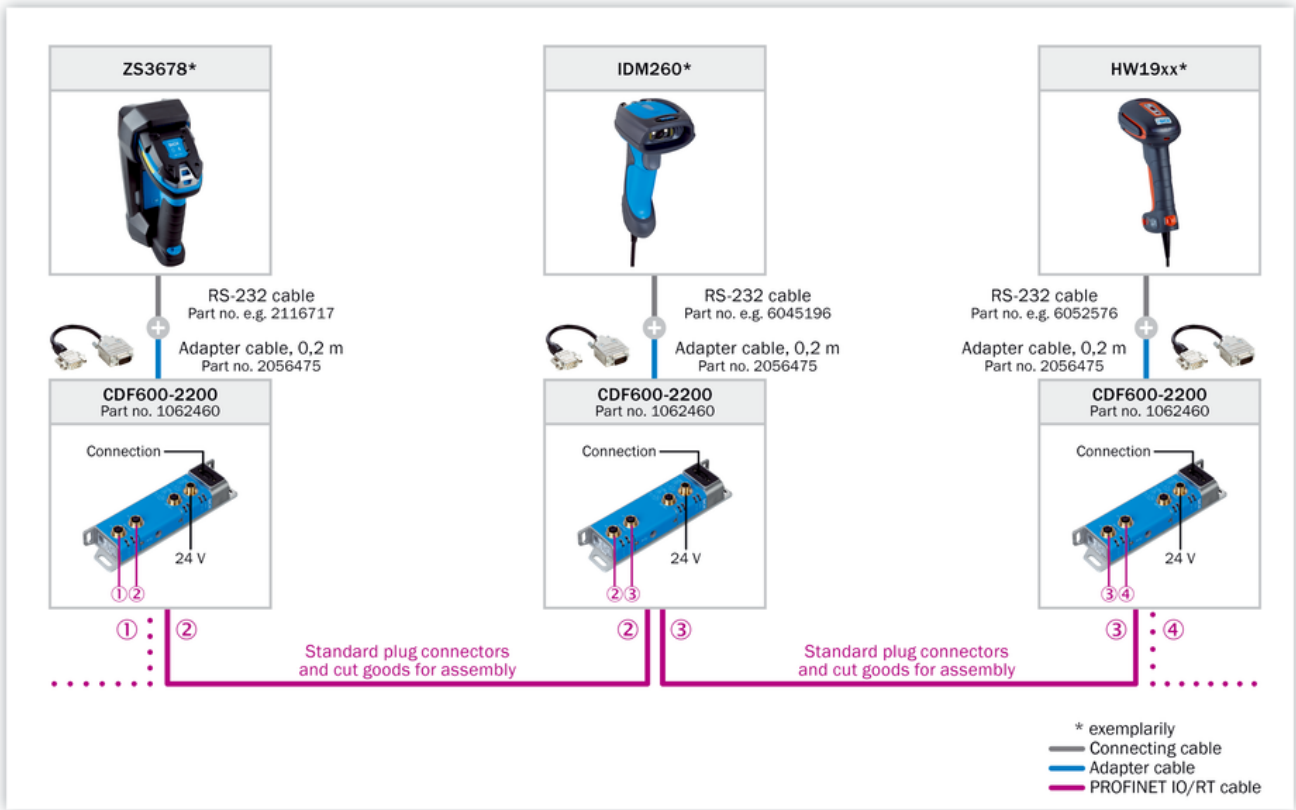

Connection diagram EtherCAT®

EtherCAT®



Connection diagram AUX looping

Looping-in via AUX

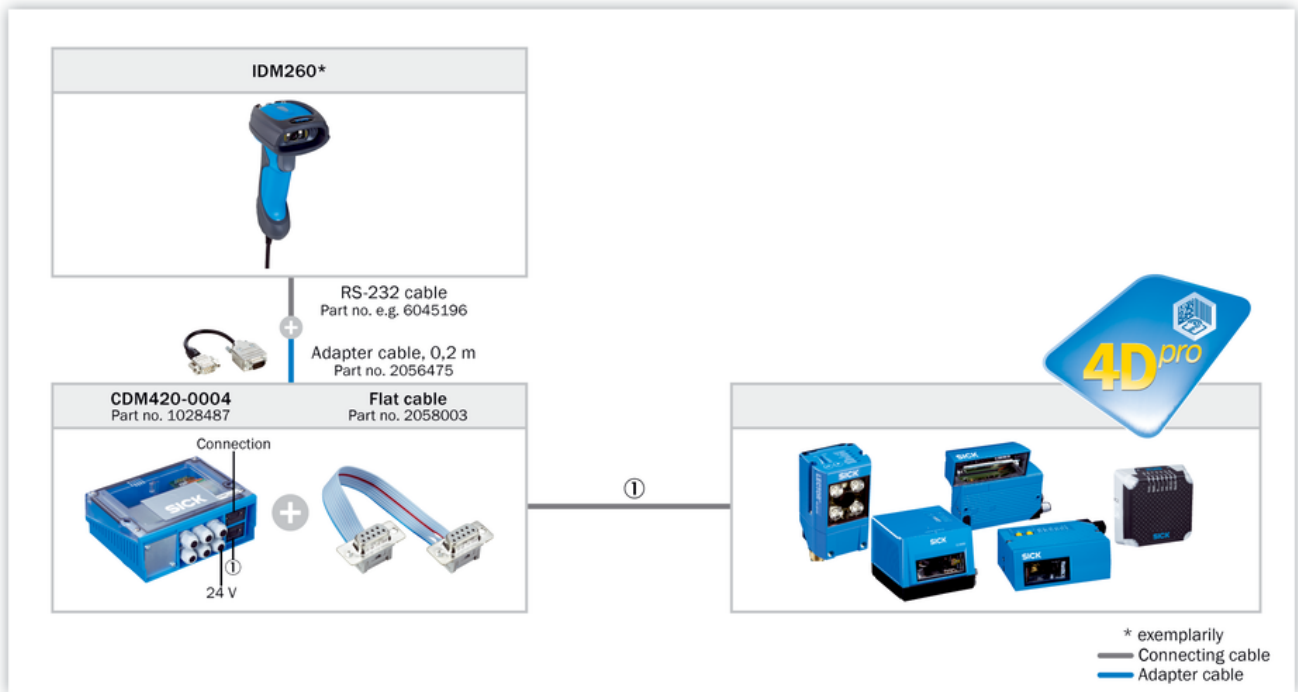

Selection Guide



\*) For EtherNet/IP third party gateway is required from e.g. Comtrol or HMS (requires local sourcing).

## SICK AT A GLANCE

SICK is one of the leading manufacturers of intelligent sensors and sensor solutions for industrial applications. A unique range of products and services creates the perfect basis for controlling processes securely and efficiently, protecting individuals from accidents and preventing damage to the environment.

We have extensive experience in a wide range of industries and understand their processes and requirements. With intelligent sensors, we can deliver exactly what our customers need. In application centers in Europe, Asia and North America, system solutions are tested and optimized in accordance with customer specifications. All this makes us a reliable supplier and development partner.

Comprehensive services complete our offering: SICK LifeTime Services provide support throughout the machine life cycle and ensure safety and productivity.

For us, that is “Sensor Intelligence.”

## WORLDWIDE PRESENCE:

Contacts and other locations –[www.sick.com](http://www.sick.com)