



# IDM260-311S USB Kit

IDM

MOBILE HANDHELD SCANNERS

**SICK**  
Sensor Intelligence.



### Ordering information

Type	part no.
IDM260-311S USB Kit	6068393

**Included in delivery:** IDM260-311S (1), Connection cable (1)

Other models and accessories → [www.sick.com/IDM](http://www.sick.com/IDM)

### Detailed technical data

#### Features

<b>Application</b>	Industrial application
<b>Scanner design</b>	Cable connection variant
<b>Sensor resolution</b>	1,280 px x 800 px
<b>Light source</b>	LED, Visible, Red, 660 nm
<b>Alignment aid</b>	Laser, Red, 630 nm
<b>Laser class</b>	1 (EN/IEC 60825-1:2014)
<b>Reading distance</b>	30 mm ... 400 mm
<b>Code resolution</b>	≥ 0.07 mm <sup>1)</sup> ≥ 0.13 mm <sup>2)</sup>

<sup>1)</sup> Valid for Code 39.

<sup>2)</sup> Valid for Data Matrix code.

#### Mechanics/electronics

<b>Supply voltage</b>	5 V DC, ± 10 %
<b>Current consumption</b>	Operation (vibration deactivated): 395 mA Operation (vibration activated): 420 mA Standby: 220 mA
<b>Housing color</b>	Blue, gray
<b>Enclosure rating</b>	IP65
<b>Weight</b>	208 g, without cable
<b>Dimensions (L x W x H)</b>	104 mm x 76.3 mm x 176 mm
<b>MTBF</b>	100,000 h

#### Performance

<b>Readable code structures</b>	1D codes, 2D codes, Stacked
<b>Bar code types</b>	Code 39, Code 39 Trioptic, Code 32, Code 93, Code 11, Codabar, Code 128, GS1-128 / EAN 128, UPC / EAN / JAN (with addition), MSI/Plessey, UK/Plessey, IATA, Interleaved 2 of 5, Standard and Industrial 2 of 5, Matrix 2 of 5, Telepen, GS1 DataBar, Australian Post, China Post, German Post, US Planet, US Postnet, British Post, Intelligent Mail, Japan Post, Korean Post, Dutch KIX Post
<b>2D code types</b>	Data Matrix, QR code, MicroQR-Code, Aztec, MaxiCode

<b>Stacked code types</b>	PDF417, MicroPDF417, Code 49, Code 16K, Composite, Codablock F
---------------------------	--

### Interfaces

<b>USB</b>	✓
Function	Keyboard wedge, COM-Port emulation
<b>Optical indicators</b>	2 LEDs (operational status, good read)
<b>Acoustic indicators</b>	Beeper, can be switched off
<b>Vibration</b>	Yes
<b>Configuration software</b>	IDM Setup Tool

### Ambient data

<b>Shock resistance</b>	50 drops from 2 m height on concrete
<b>Ambient operating temperature</b>	-20 °C ... +50 °C
<b>Storage temperature</b>	-40 °C ... +70 °C
<b>Relative humidity</b>	95 %, Non-condensing
<b>Ambient light immunity</b>	100,000 lx

### Classifications

<b>ECLASS 5.0</b>	27280101
<b>ECLASS 5.1.4</b>	27280101
<b>ECLASS 6.0</b>	27280101
<b>ECLASS 6.2</b>	27280101
<b>ECLASS 7.0</b>	27280101
<b>ECLASS 8.0</b>	27280101
<b>ECLASS 8.1</b>	27280101
<b>ECLASS 9.0</b>	27280101
<b>ECLASS 10.0</b>	27280101
<b>ECLASS 11.0</b>	27280101
<b>ECLASS 12.0</b>	27280101
<b>ETIM 5.0</b>	EC002550
<b>ETIM 6.0</b>	EC002550
<b>ETIM 7.0</b>	EC002550
<b>ETIM 8.0</b>	EC002550
<b>UNSPSC 16.0901</b>	43211701

Connection diagram PROFINET IO/RT

PROFINET IO/RT

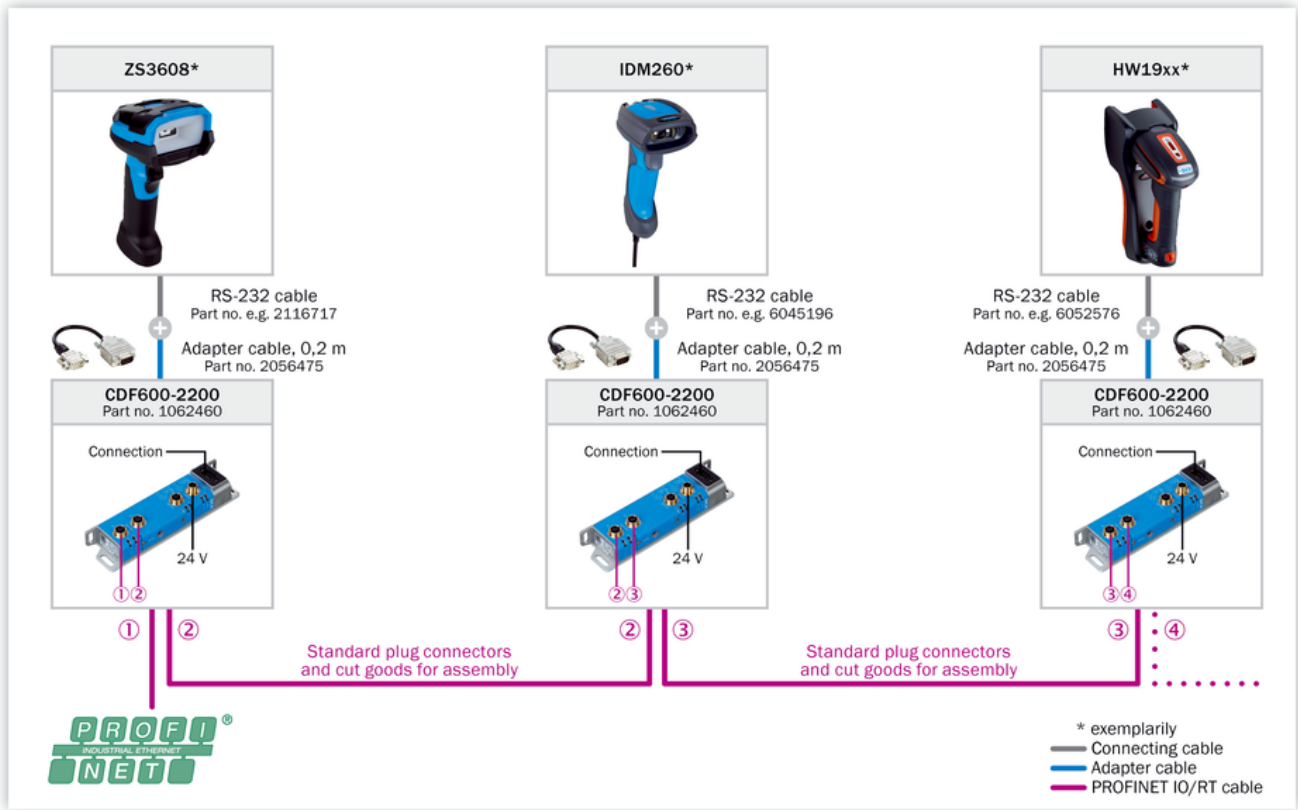

Connection diagram PROFIBUS DP

PROFIBUS DP

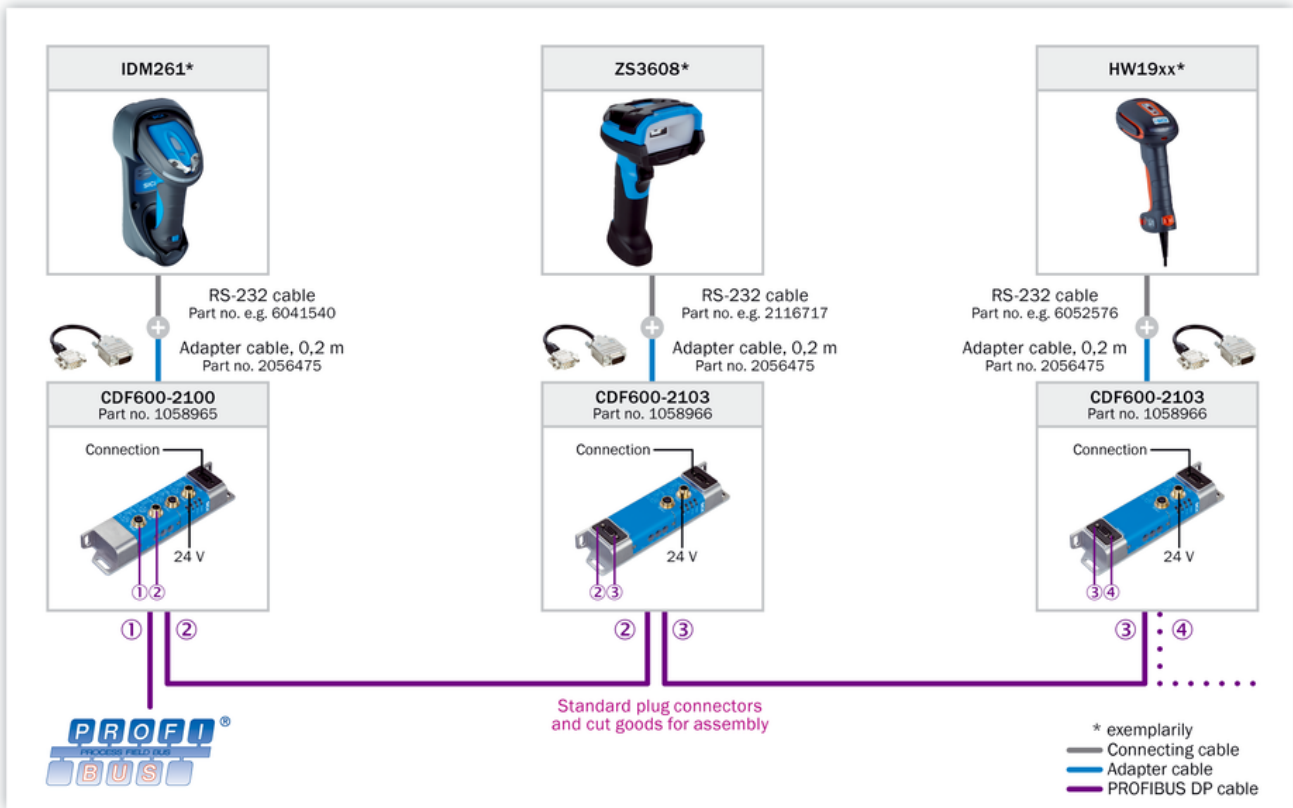

Connection diagram Ethernet TCP/IP

Ethernet TCP/IP

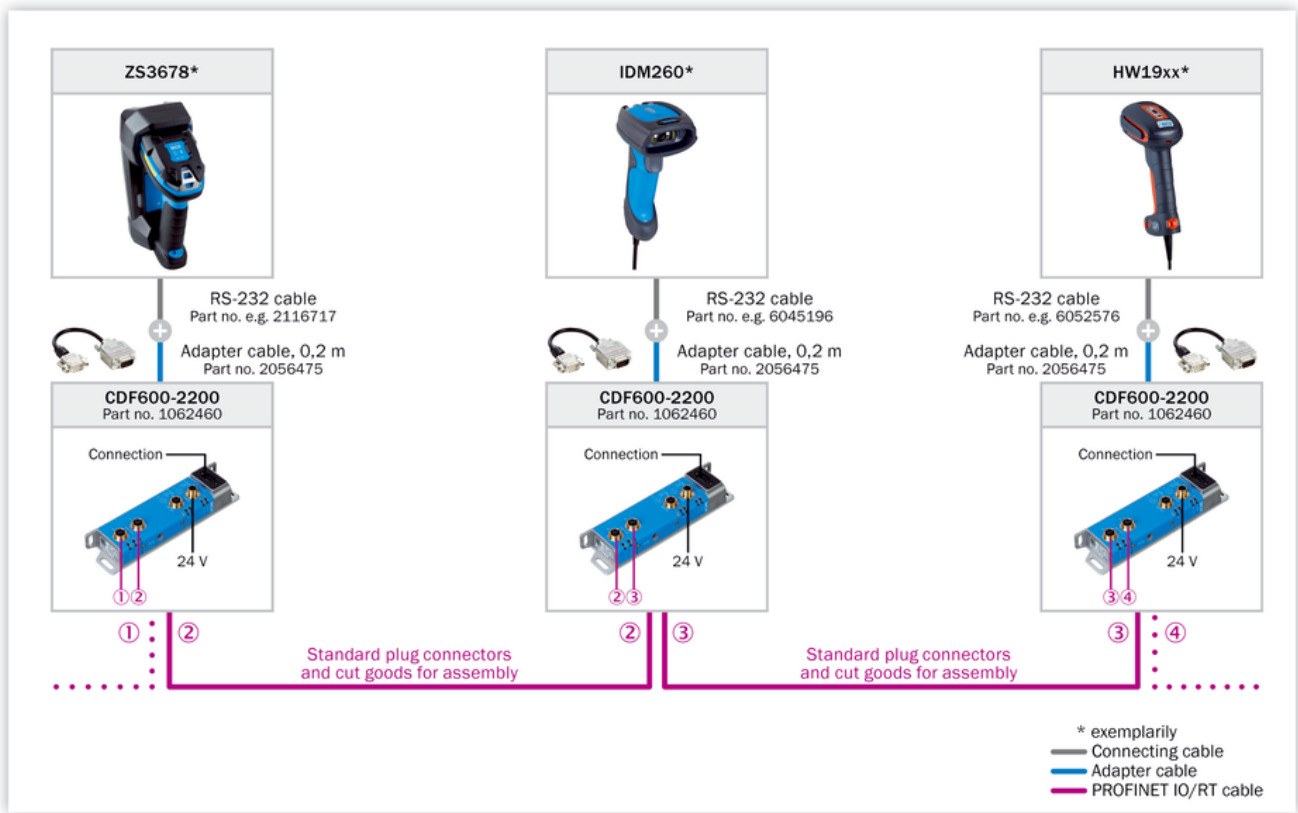

Connection diagram EtherCAT®

EtherCAT®



Connection diagram AUX looping

Looping-in via AUX

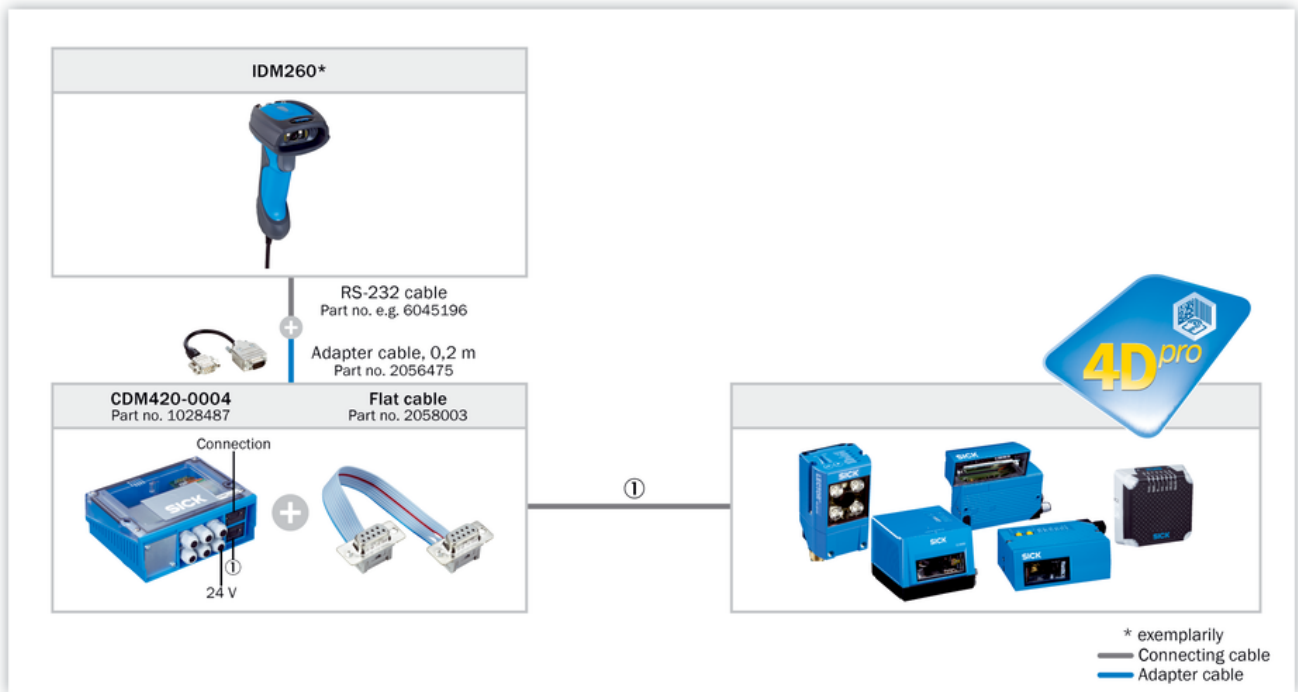



Selection Guide



\*) For EtherNet/IP third party gateway is required from e.g. Comtrol or HMS (requires local sourcing).

### Recommended accessories

Other models and accessories → [www.sick.com/IDM](http://www.sick.com/IDM)

	Brief description	Type	part no.
Mounting systems			
	<ul style="list-style-type: none"><li>• <b>Description:</b> Desk holder</li></ul>	Table mount	6045192
	<ul style="list-style-type: none"><li>• <b>Description:</b> Tripod mount</li></ul>	Stand mount	6045193

## SICK AT A GLANCE

SICK is one of the leading manufacturers of intelligent sensors and sensor solutions for industrial applications. A unique range of products and services creates the perfect basis for controlling processes securely and efficiently, protecting individuals from accidents and preventing damage to the environment.

We have extensive experience in a wide range of industries and understand their processes and requirements. With intelligent sensors, we can deliver exactly what our customers need. In application centers in Europe, Asia and North America, system solutions are tested and optimized in accordance with customer specifications. All this makes us a reliable supplier and development partner.

Comprehensive services complete our offering: SICK LifeTime Services provide support throughout the machine life cycle and ensure safety and productivity.

For us, that is “Sensor Intelligence.”

## WORLDWIDE PRESENCE:

Contacts and other locations –[www.sick.com](http://www.sick.com)