



HW1981IFR-3SER-5 KIT

HW19

MOBILE HANDHELD SCANNERS

SICK
Sensor Intelligence.



Ordering information

Type	part no.
HW1981IFR-3SER-5 KIT	6059463

Included in delivery: Connection cable (male connector-female connector) (1), HW1981IFR-3 (1), Base station (1)

Other models and accessories → www.sick.com/HW19

Detailed technical data

Features

Application	Industrial application
Version	Full Range Focus
Scanner design	Wireless variant
Sensor resolution	1,280 px x 800 px
Light source	LED, Visible, Red, 624 nm, ± 18 nm
Alignment aid	Laser, Red, 650 nm
Reading distance	150 mm ... 16,000 mm
Code resolution	≥ 0.05 mm ¹⁾ ≥ 2 mm ²⁾

¹⁾ Close range.

²⁾ Distance range.

Mechanics/electronics

Supply voltage	3.7 V DC ¹⁾
Current consumption	Charging (5 V DC): 1 A Standby: 120 mA
Housing material	Plastic (UL 94 V-0)
Housing color	Orange, gray
Enclosure rating	IP51 IP65
Weight	420 g, incl. rechargeable battery
Dimensions (L x W x H)	133 mm x 75 mm x 195 mm

¹⁾ Rechargeable battery operation.

Performance

Readable code structures	1D codes, 2D codes, Stacked
Bar code types	Code 39, Code 39 Trioptic, Code 32, Code 93, Code 11, Codabar, Code 128, GS1-128 / EAN 128, UPC / EAN / JAN (with addition), MSI/Plessey, UK/Plessey, IATA, Interleaved 2 of 5, Standard and Industrial 2 of 5, Matrix 2 of 5, Telepen, GS1 DataBar, Australian Post, China Post, German Post, US Planet, US Postnet, British Post, Intelligent Mail, Japan Post, Korean Post, Dutch KIX Post

2D code types	Data Matrix, QR code, MicroQR-Code, Aztec, MaxiCode
Stacked code types	PDF417, MicroPDF417, Code 49, Code 16K, Composite, Codablock F
Code alignment	Omni-directional
Battery power	Min. 7,200 scans (1 scan every 4 s over 8 hours)
Code buffer	5,000 Codes (EAN, for scanning in batch mode), 100,000 Codes (EAN, for out of range scanning)

Interfaces

Ethernet	✓ , TCP/IP
Type of fieldbus integration	Optional, over external connection module CDF600-2
Function	COM-Port emulation
PROFINET	✓
Type of fieldbus integration	Optional over external fieldbus module CDF600-2
Function	PROFINET Single Port, PROFINET Dual Port
EtherCAT®	✓
Type of fieldbus integration	Optional over external fieldbus module CDF600
Serial	✓ , RS-232 TTL
Remark	RS-232 (± 12 V)
PROFIBUS DP	✓
Type of fieldbus integration	Optional over external fieldbus module CDF600-2
Bluetooth	✓
Remark	Bluetooth™ V2.1 EDR, 2.4 ... 2.4835 GHz
Function	Wireless operating range up to 100 m (free view), batch function for expansion of the wireless radius, up to seven scanners communicate with one base station
Optical indicators	2 LEDs (good read, charge of battery , radio connection status)
Acoustic indicators	Beeper, can be switched off
Vibration	Yes
Configuration software	EZConfig Tool

Ambient data

Shock resistance	50 drop tests onto concrete from a height of 2 m at -30 °C
Ambient operating temperature	-20 °C ... +50 °C
Storage temperature	-40 °C ... +70 °C
Relative humidity	95 %, Non-condensing
Ambient light immunity	100,000 lx
Bar code print contrast (PCS)	≥ 40 %

General notes

Items supplied	The rechargeable battery is included with delivery
-----------------------	--

Certificates

UN38.3 Test Summary Report	✓
-----------------------------------	---

Classifications

ECLASS 5.0	27280101
ECLASS 5.1.4	27280101

ECLASS 6.0	27280101
ECLASS 6.2	27280101
ECLASS 7.0	27280101
ECLASS 8.0	27280101
ECLASS 8.1	27280101
ECLASS 9.0	27280101
ECLASS 10.0	27280101
ECLASS 11.0	27280101
ECLASS 12.0	27280101
ETIM 5.0	EC002550
ETIM 6.0	EC002550
ETIM 7.0	EC002550
ETIM 8.0	EC002550
UNSPSC 16.0901	43211701

Connection diagram PROFINET IO/RT

PROFINET IO/RT

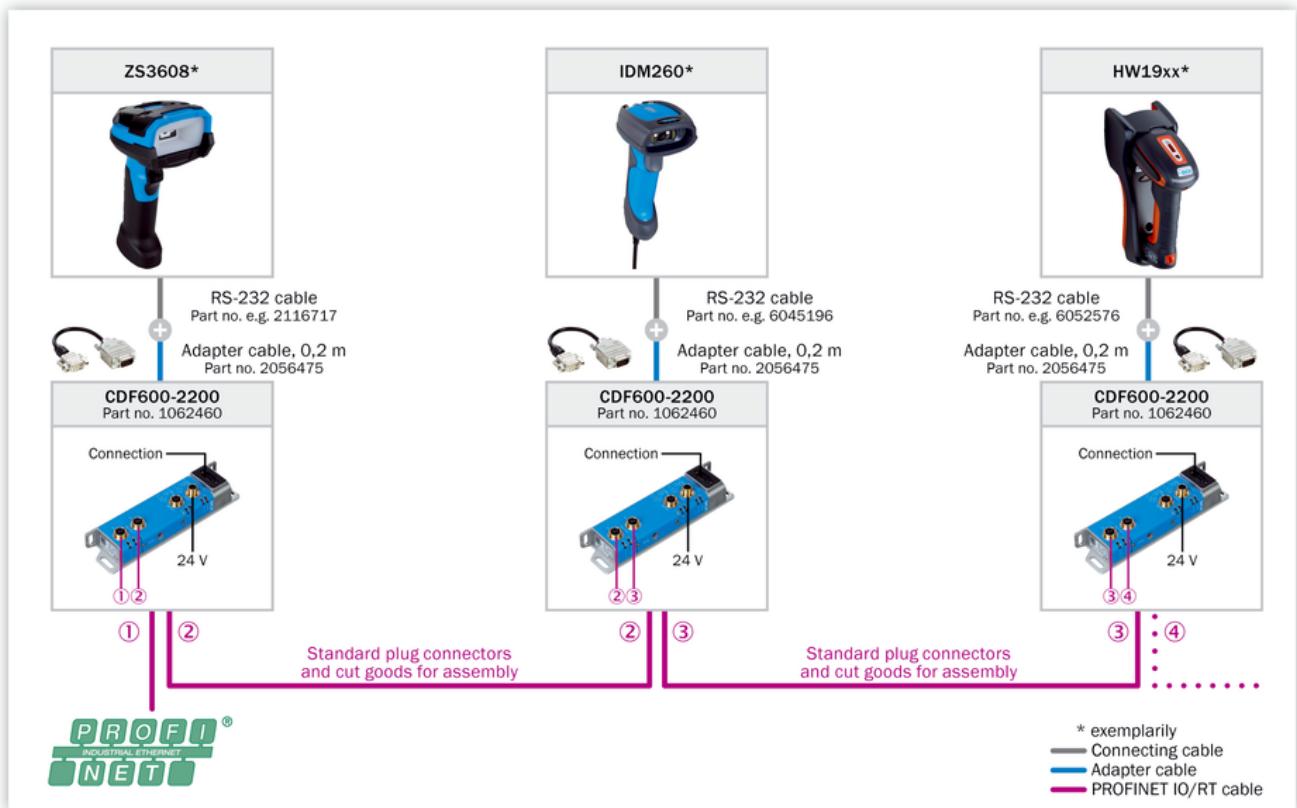

Connection diagram PROFIBUS DP

PROFIBUS DP

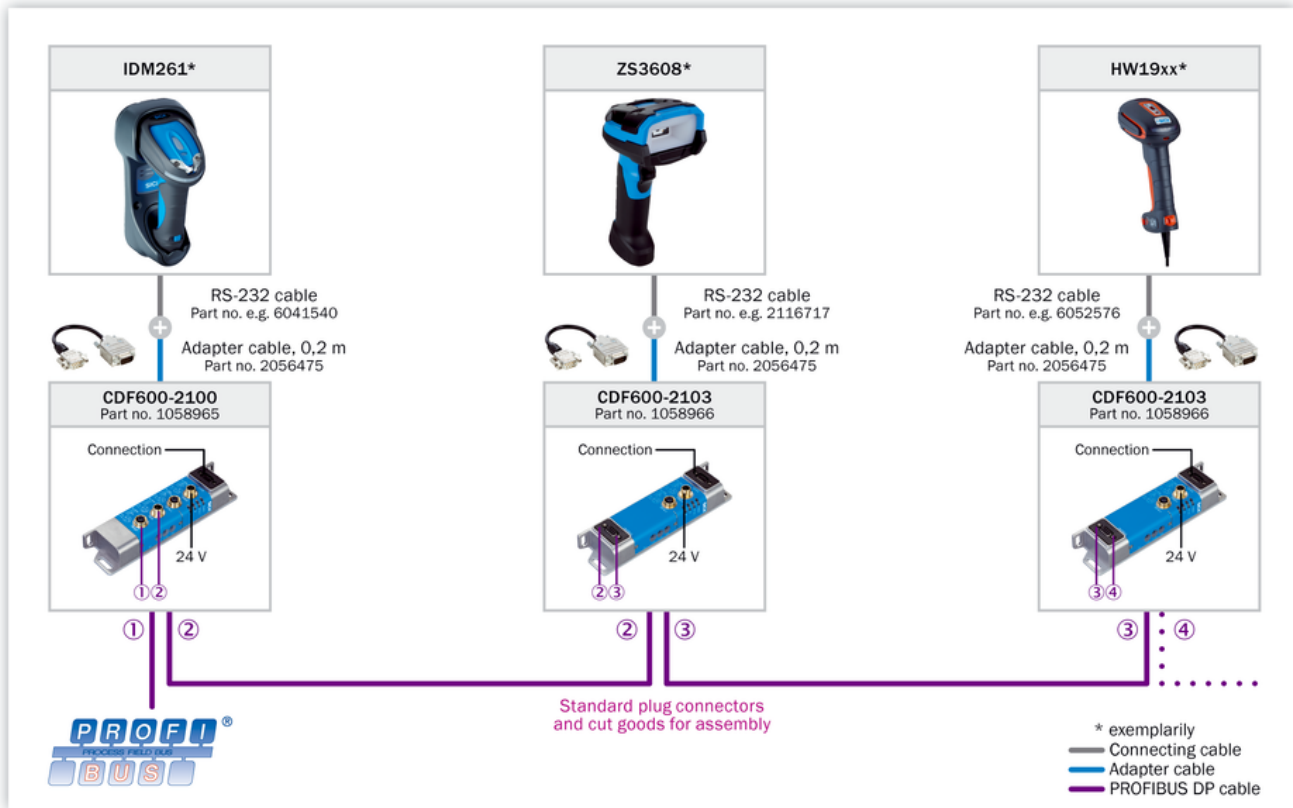

Connection diagram EtherCAT®

EtherCAT®

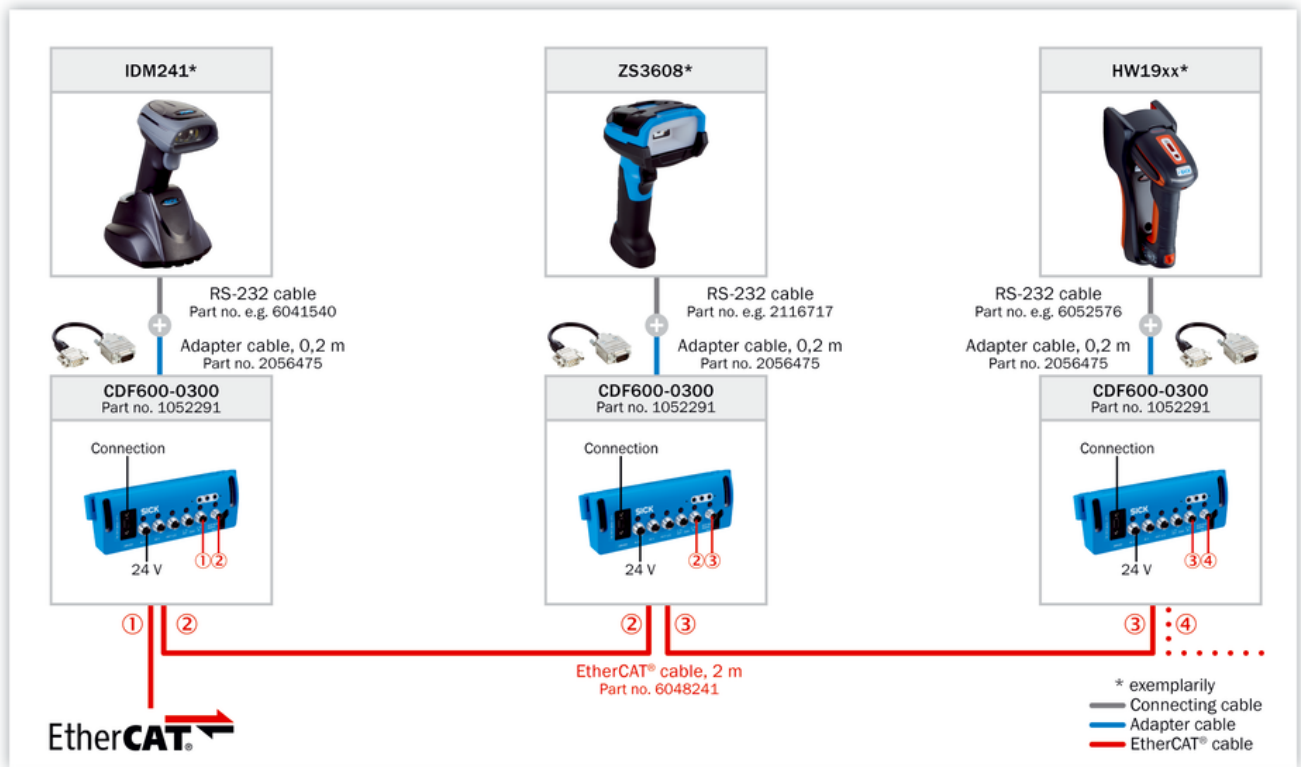

Connection diagram AUX looping

Looping-in via AUX

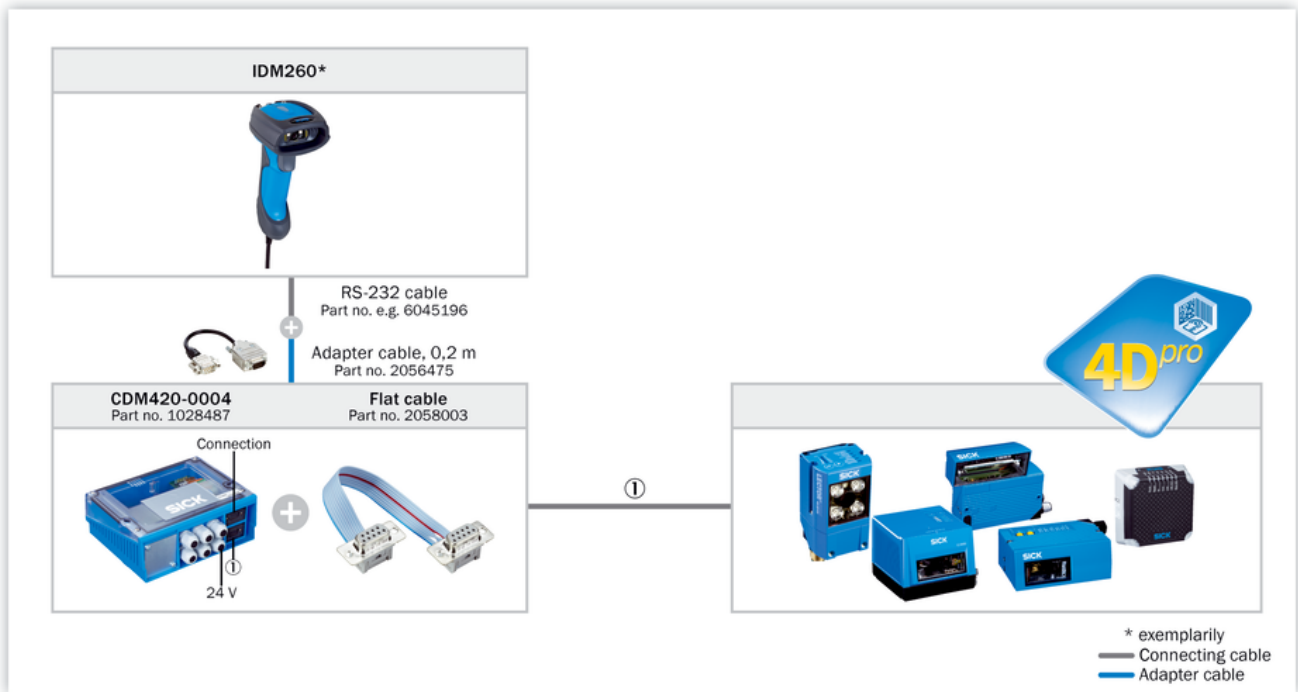





Selection Guide



*) For EtherNet/IP third party gateway is required from e.g. Control or HMS (requires local sourcing).

Recommended accessories

Other models and accessories → www.sick.com/HW19

	Brief description	Type	part no.
connectors and cables			
	<ul style="list-style-type: none"> Connection type head A: Male connector, D-Sub, 9-pin Connection type head B: Male connector, D-Sub, 15-pin Items supplied: Incl. 24V/5V DC converter Cable: 0.3 m Note: For handheld scanners to CDB620/CDM420/CDF600/CDF600-2, adapter AUX port 	YMH-DAC-C30XXXMDSA9	2056475
integration modules and adapters			
	<ul style="list-style-type: none"> Description: Connection kit for connecting a hand-held scanner to a PROFINET (Siemens) interface 	Hand-held scanner PROFINET kit	1101488
Power supply units and power supply cables			
	<ul style="list-style-type: none"> Input voltage: 90 V AC ... 255 V AC Output voltage: 5.2 V DC Output current: 1 A Description: Power supply unit with NA male connector for charging station, 1 A, 5.2 V DC, 90 V AC ... 255 V AC at 50 Hz ... 60 Hz (Honeywell PS-05-1000W-A) 	Power supply unit	6052582
	<ul style="list-style-type: none"> Input voltage: 90 V AC ... 255 V AC Output voltage: 5.2 V DC Output current: 1 A Description: Power supply unit with EU male connector for charging station, 1 A, 5.2 V DC, 90 V AC ... 255 V AC at 50 Hz ... 60 Hz (Honeywell PS-05-1000W-C) 	Power supply unit	6064641
	<ul style="list-style-type: none"> Input voltage: 90 V AC ... 255 V AC Output voltage: 5.2 V DC Output current: 1 A Description: Power supply unit with UK male connector for charging station, 1 A, 5.2 V DC, 90 V AC ... 255 V AC at 50 Hz ... 60 Hz (Honeywell PS-05-1000W-G) 	Power supply unit	6064642

SICK AT A GLANCE

SICK is one of the leading manufacturers of intelligent sensors and sensor solutions for industrial applications. A unique range of products and services creates the perfect basis for controlling processes securely and efficiently, protecting individuals from accidents and preventing damage to the environment.

We have extensive experience in a wide range of industries and understand their processes and requirements. With intelligent sensors, we can deliver exactly what our customers need. In application centers in Europe, Asia and North America, system solutions are tested and optimized in accordance with customer specifications. All this makes us a reliable supplier and development partner.

Comprehensive services complete our offering: SICK LifeTime Services provide support throughout the machine life cycle and ensure safety and productivity.

For us, that is “Sensor Intelligence.”

WORLDWIDE PRESENCE:

Contacts and other locations –www.sick.com