



# IDM141-310S Basic Kit

IDM

MOBILE HANDHELD SCANNERS

**SICK**  
Sensor Intelligence.



### Ordering information

Type	part no.
IDM141-310S Basic Kit	6054792

**Included in delivery:** Base station (1), Power supply unit (1)

Other models and accessories → [www.sick.com/IDM](http://www.sick.com/IDM)



### Detailed technical data

#### Features

<b>Application</b>	Standard application
<b>Version</b>	Standard Range
<b>Scanner design</b>	Wireless variant
<b>Light source</b>	LED, Visible, Red, 630 nm
<b>Reading distance</b>	20 mm ... 850 mm <sup>1)</sup>
<b>Scanning frequency</b>	≤ 500 Hz
<b>Code resolution</b>	≥ 0.076 mm

<sup>1)</sup> For details see reading field diagram.

#### Mechanics/electronics

<b>Supply voltage</b>	3.7 V DC ... 5 V <sup>1)</sup>
<b>Current consumption</b>	Operation: 180 mA Standby: 80 mA
<b>Housing color</b>	Black/gray
<b>Enclosure rating</b>	IP41
<b>Weight</b>	+ 230 g, incl. rechargeable battery
<b>Dimensions (L x W x H)</b>	97.8 mm x 70.5 mm x 156.2 mm

<sup>1)</sup> Rechargeable battery operation.

#### Performance

<b>Readable code structures</b>	1D codes, Stacked
<b>Bar code types</b>	Codabar, Code 39, Code 32, UPC-A, UPC-E, Standard and Industrial 2 of 5, Interleaved & Matrix 2 of 5, Code 128, UCC/EAN-128, Code 11, Code 93, German ITF Postal Code, Mainland China Postal Code, Telepen, MSI/Plessey, UK/Plessey, Limited/Expanded GS1 DataBar, Code 39 Trioptic, IATA, UPC / EAN / JAN (with addition)
<b>Stacked code types</b>	PDF417, MicroPDF417, Composite, Codablock F
<b>Battery power</b>	Over 60,000 scans with full battery
<b>Code buffer</b>	80,000 Codes (EAN)

## Interfaces

<b>Ethernet</b>		✓ , TCP/IP
	Type of fieldbus integration	Optional, over external connection module CDF600-2
<b>PROFINET</b>		✓
	Type of fieldbus integration	Optional over external fieldbus module CDF600-2
	Function	PROFINET Single Port, PROFINET Dual Port
<b>EtherCAT®</b>		✓
	Type of fieldbus integration	Optional over external fieldbus module CDF600
<b>Serial</b>		✓ , RS-232 TTL
<b>PROFIBUS DP</b>		✓
	Type of fieldbus integration	Optional over external fieldbus module CDF600-2
<b>USB</b>		✓
	Function	Keyboard wedge, COM-Port emulation
<b>PS/2</b>		✓
	Function	Keyboard wedge
<b>Bluetooth</b>		✓
	Remark	Bluetooth™ V4.0, 2.402 ... 2.4830 GHz
	Function	Wireless operating range up to 100 m (free view), batch function for expansion of the wireless radius, up to seven scanners communicate with one base station
<b>Optical indicators</b>		2 LEDs (good read, charge of battery , radio connection status)
<b>Acoustic indicators</b>		Beeper, can be switched off
<b>Vibration</b>		No
<b>Configuration software</b>		IDM Setup Tool

## Ambient data

<b>Shock resistance</b>	25 drops from 1.8 m height on concrete
<b>Ambient operating temperature</b>	-10 °C ... +50 °C
<b>Storage temperature</b>	-40 °C ... +70 °C
<b>Permissible relative humidity</b>	± 95 %, Non-condensing
<b>Ambient light immunity</b>	100,000 lx

## General notes

<b>Items supplied</b>	The rechargeable battery is included with delivery
<b>Note</b>	For setting-up operation an connection cable is additionally required. Not free of paint wetting impairment substances.

## Certificates

<b>Bluetooth</b>	✓
------------------	---

## Classifications

<b>ECLASS 5.0</b>	27280101
<b>ECLASS 5.1.4</b>	27280101
<b>ECLASS 6.0</b>	27280101
<b>ECLASS 6.2</b>	27280101
<b>ECLASS 7.0</b>	27280101
<b>ECLASS 8.0</b>	27280101

<b>ECLASS 8.1</b>	27280101
<b>ECLASS 9.0</b>	27280101
<b>ECLASS 10.0</b>	27280101
<b>ECLASS 11.0</b>	27280101
<b>ECLASS 12.0</b>	27280101
<b>ETIM 5.0</b>	EC002550
<b>ETIM 6.0</b>	EC002550
<b>ETIM 7.0</b>	EC002550
<b>ETIM 8.0</b>	EC002550
<b>UNSPSC 16.0901</b>	43211701

### Reading field diagram IDM14x-3xxS Standard Range IDM16x-3xxS Standard Range

Code resolution in mm (mil)

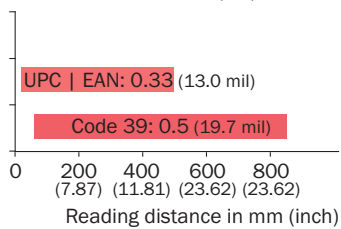

### Connection diagram AUX looping

#### Looping-in via AUX

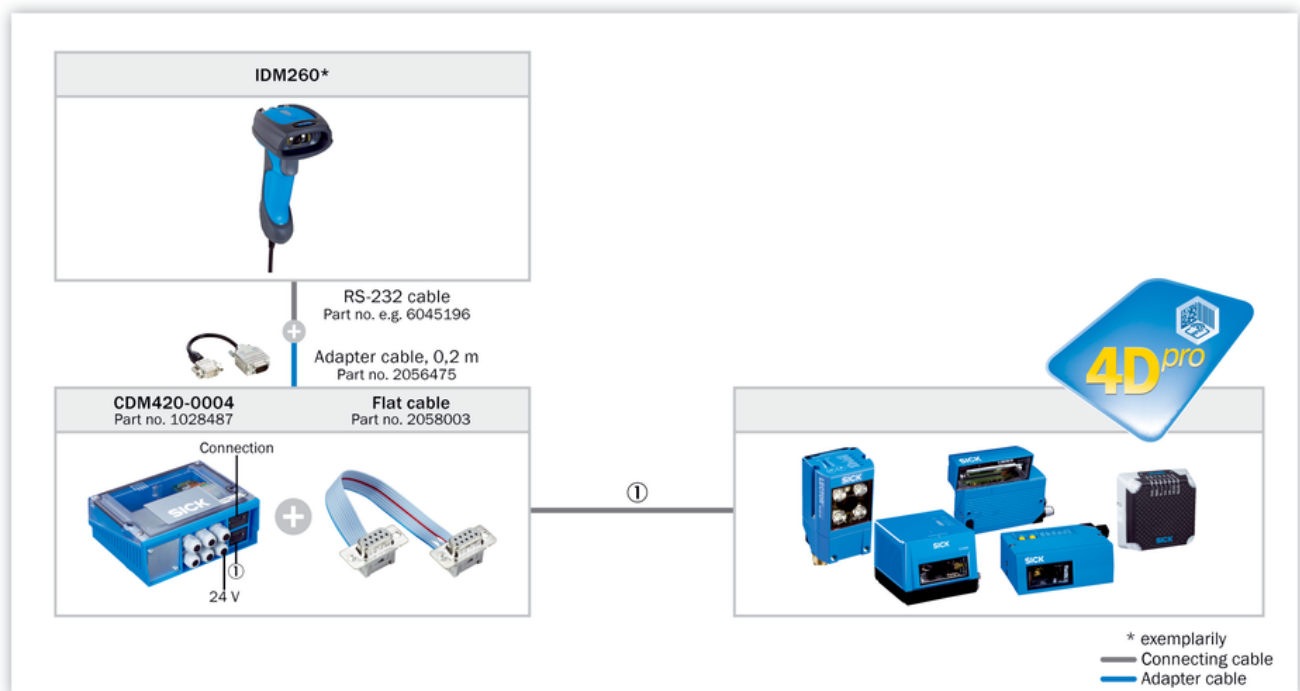

Connection diagram EtherCAT®

EtherCAT®

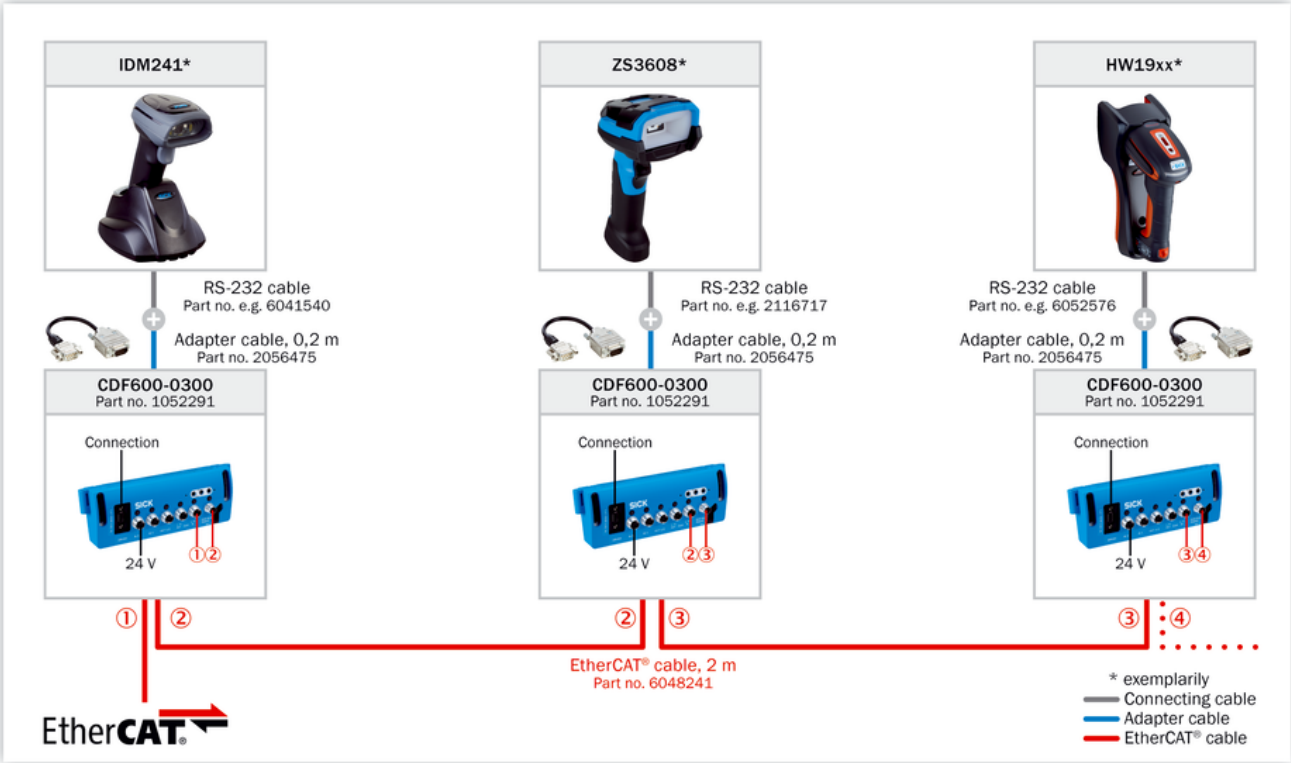

### Connection diagram PROFIBUS DP

#### PROFIBUS DP

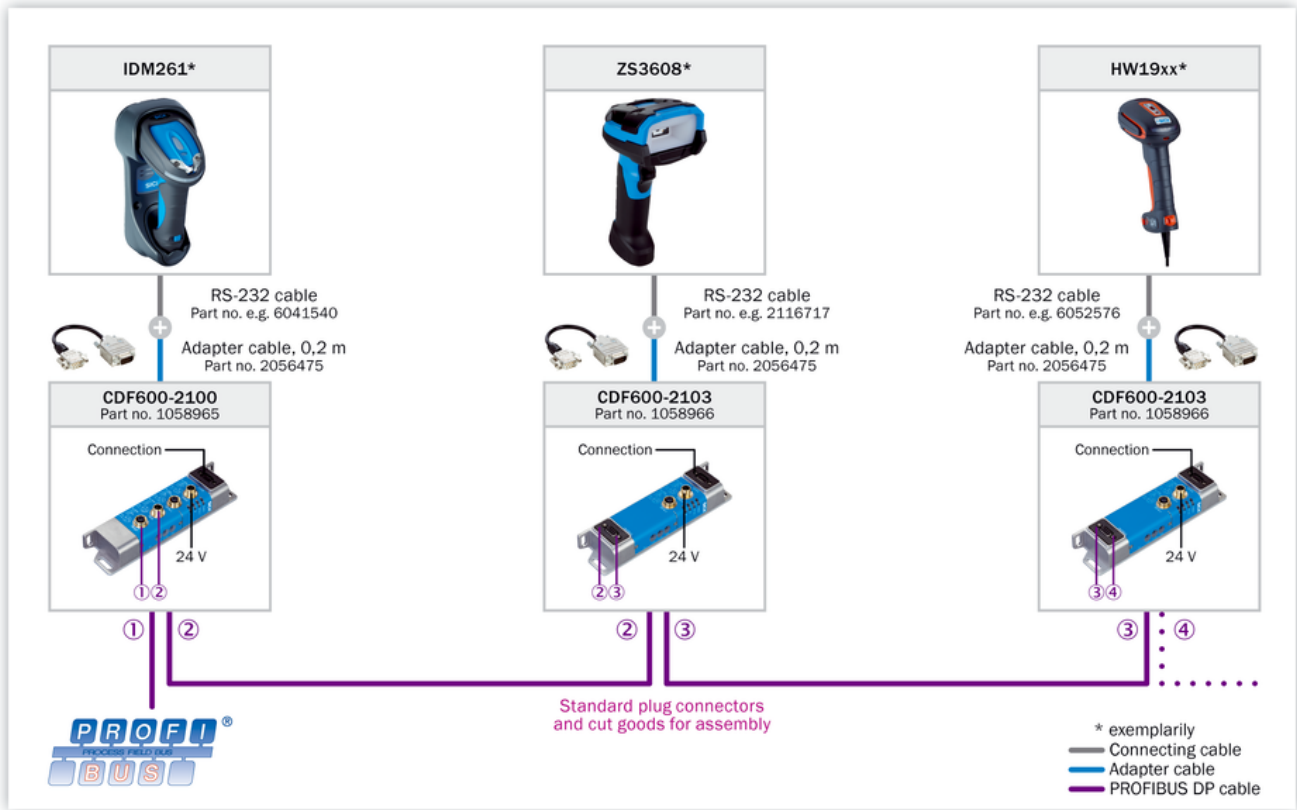

Connection diagram PROFINET IO/RT

PROFINET IO/RT

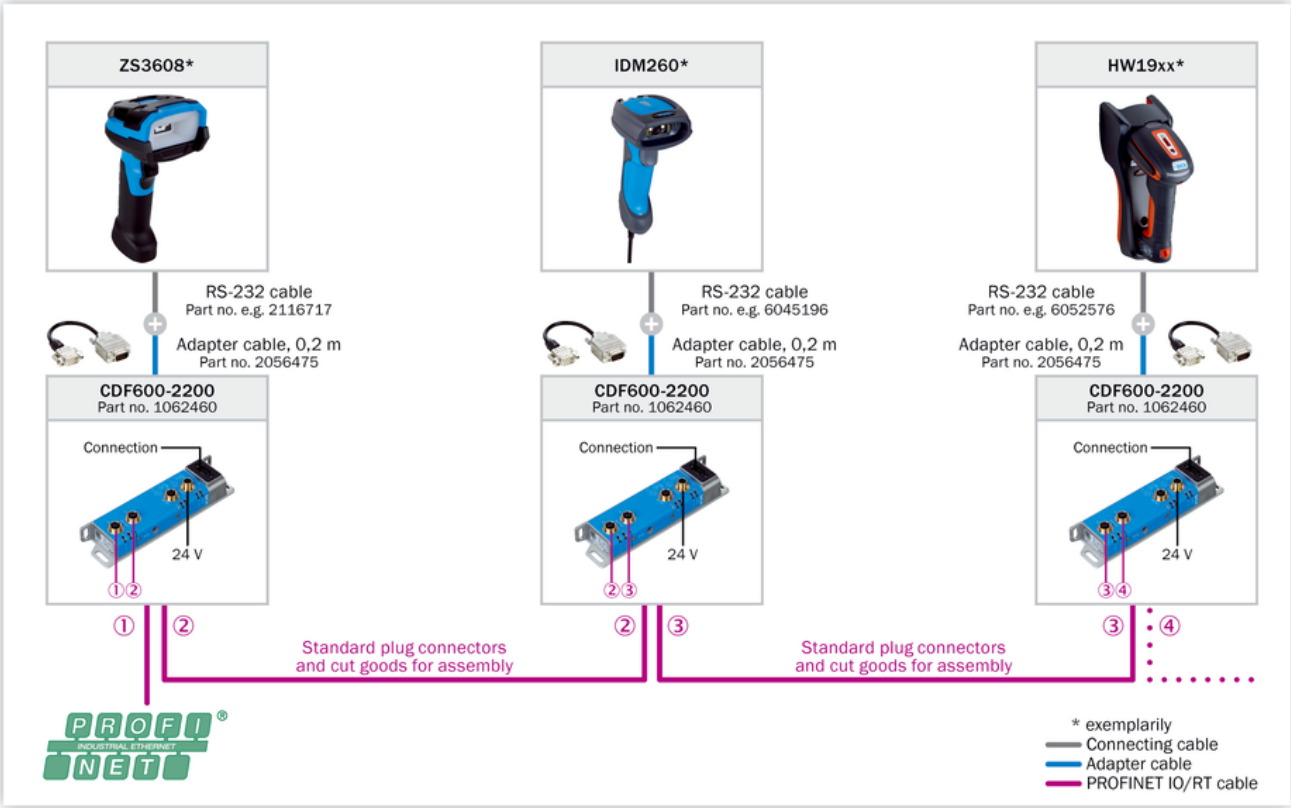

### Connection diagram Ethernet TCP/IP

#### Ethernet TCP/IP

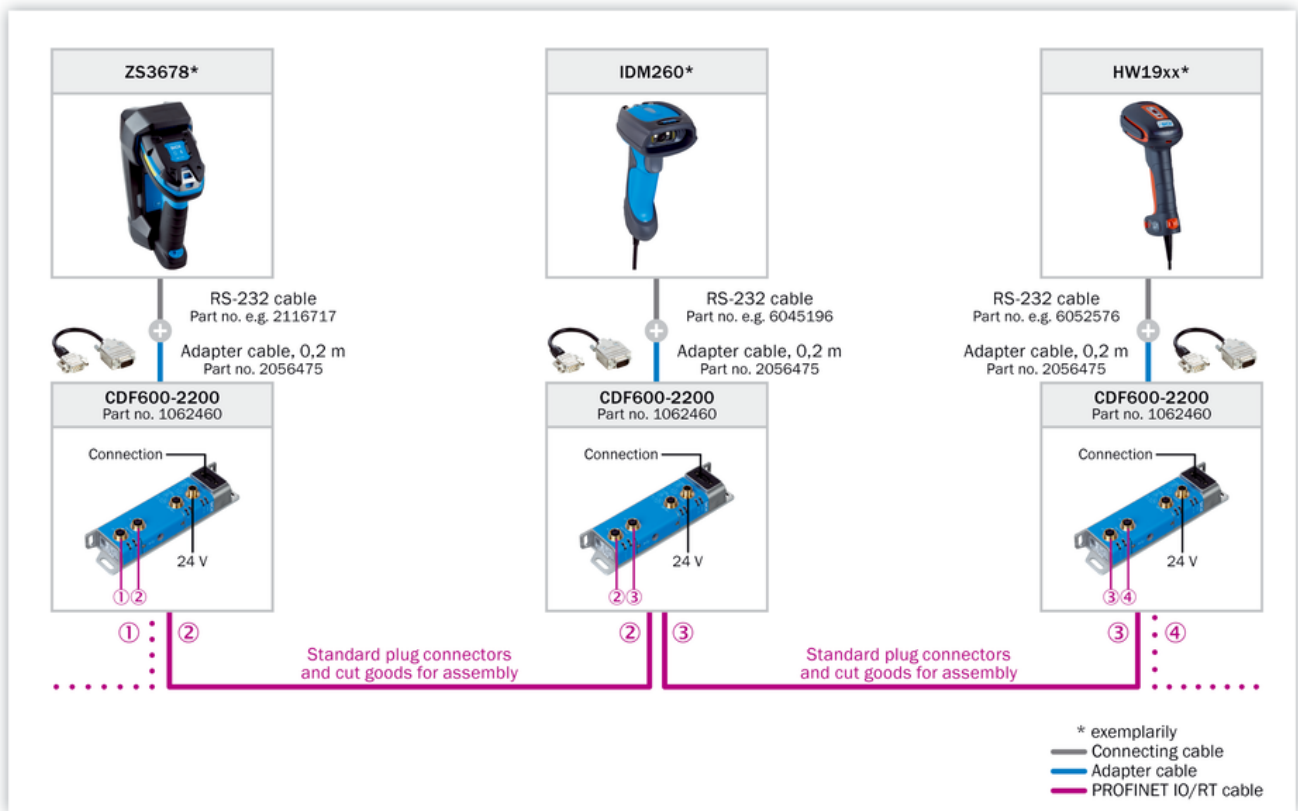



Selection Guide



\*) For EtherNet/IP third party gateway is required from e.g. Comtrol or HMS (requires local sourcing).

### Recommended accessories

Other models and accessories → [www.sick.com/IDM](http://www.sick.com/IDM)

	Brief description	Type	part no.
connectors and cables			
	<ul style="list-style-type: none"> <li><b>Description:</b> PS/2, unshielded</li> <li><b>Connection type head A:</b> Female connector, Mini-DIN, Male connector, Mini-DIN</li> <li><b>Connection type head B:</b> Male connector, RJ45</li> <li><b>Signal type:</b> PS/2</li> <li><b>Cable:</b> 2 m, straightened cable</li> </ul>	Connection cable	6036726
	<ul style="list-style-type: none"> <li><b>Connection type head A:</b> Male connector, D-Sub, 9-pin</li> <li><b>Connection type head B:</b> Male connector, D-Sub, 15-pin</li> <li><b>Items supplied:</b> Incl. 24V/5V DC converter</li> <li><b>Cable:</b> 0.3 m</li> <li><b>Note:</b> For handheld scanners to CDB620/CDM420/CDF600/CDF600-2, adapter AUX port</li> </ul>	YMH-DAC-C30XXMDSA9	2056475
integration modules and adapters			
	<ul style="list-style-type: none"> <li><b>Description:</b> Connection kit for connecting a hand-held scanner to a PROFINET (Siemens) interface</li> </ul>	Hand-held scanner PROFINET kit	1101488

## SICK AT A GLANCE

SICK is one of the leading manufacturers of intelligent sensors and sensor solutions for industrial applications. A unique range of products and services creates the perfect basis for controlling processes securely and efficiently, protecting individuals from accidents and preventing damage to the environment.

We have extensive experience in a wide range of industries and understand their processes and requirements. With intelligent sensors, we can deliver exactly what our customers need. In application centers in Europe, Asia and North America, system solutions are tested and optimized in accordance with customer specifications. All this makes us a reliable supplier and development partner.

Comprehensive services complete our offering: SICK LifeTime Services provide support throughout the machine life cycle and ensure safety and productivity.

For us, that is “Sensor Intelligence.”

## WORLDWIDE PRESENCE:

Contacts and other locations –[www.sick.com](http://www.sick.com)