



IDM161-310S

IDM

MOBILE HANDHELD SCANNERS

SICK
Sensor Intelligence.



Ordering information

| Type | part no. |
|-------------|----------|
| IDM161-310S | 6054559 |

Other models and accessories → www.sick.com/IDM



Detailed technical data

Features

| | |
|---------------------------|--------------------------------|
| Application | Industrial application |
| Version | Standard Range |
| Scanner design | Wireless variant |
| Light source | LED, Visible, Red, 630 nm |
| Reading distance | 20 mm ... 850 mm ¹⁾ |
| Scanning frequency | ≤ 500 Hz |
| Code resolution | ≥ 0.076 mm |

¹⁾ For details see reading field diagram.

Mechanics/electronics

| | |
|-------------------------------|-------------------------------------|
| Supply voltage | 3.7 V DC, ± 10 % ¹⁾ |
| Current consumption | Operation: 180 mA Standby: 80 mA |
| Housing color | Blue, gray |
| Enclosure rating | IP65 |
| Weight | 220 g, incl. rechargeable battery |
| Dimensions (L x W x H) | 104 mm x 76.3 mm x 176 mm |

¹⁾ Rechargeable battery operation.

Performance

| | |
|---------------------------------|--|
| Readable code structures | 1D codes, Stacked |
| Bar code types | Codabar, Code 39, Code 32, UPC-A, UPC-E, Standard and Industrial 2 of 5, Interleaved & Matrix 2 of 5, Code 128, UCC/EAN-128, Code 11, Code 93, German ITF Postal Code, Mainland China Postal Code, Telepen, MSI/Plessey, UK/Plessey, Limited/Expanded GS1 DataBar, Code 39 Trioptic, IATA, UPC / EAN / JAN (with addition) |
| Stacked code types | PDF417, MicroPDF417, Composite, Codablock F |
| Battery power | Over 60,000 scans with full battery |
| Code buffer | 80,000 Codes (EAN) |

Interfaces

| | | |
|-------------------------------|------------------------------|---|
| Ethernet | | ✓ , TCP/IP |
| | Type of fieldbus integration | Optional, over external connection module CDF600-2 |
| PROFINET | | ✓ |
| | Type of fieldbus integration | Optional over external fieldbus module CDF600-2 |
| | Function | PROFINET Single Port, PROFINET Dual Port |
| EtherCAT® | | ✓ |
| | Type of fieldbus integration | Optional over external fieldbus module CDF600 |
| Serial | | ✓ , RS-232 TTL |
| PROFIBUS DP | | ✓ |
| | Type of fieldbus integration | Optional over external fieldbus module CDF600-2 |
| USB | | ✓ |
| | Function | Keyboard wedge, COM-Port emulation |
| PS/2 | | ✓ |
| | Function | Keyboard wedge |
| Bluetooth | | ✓ |
| | Remark | Bluetooth™ V4.0, 2.402 ... 2.4830 GHz |
| | Function | Wireless operating range up to 100 m (free view), batch function for expansion of the wireless radius, up to seven scanners communicate with one base station |
| Optical indicators | | 2 LEDs (good read, charge of battery , radio connection status) |
| Acoustic indicators | | Beeper, can be switched off |
| Vibration | | Yes |
| Configuration software | | IDM Setup Tool |

Ambient data

| | |
|--------------------------------------|--------------------------------------|
| Shock resistance | 50 drops from 2 m height on concrete |
| Ambient operating temperature | -20 °C ... +50 °C |
| Storage temperature | -40 °C ... +70 °C |
| Permissible relative humidity | ± 95 %, Non-condensing |
| Ambient light immunity | 100,000 lx |

General notes

| | |
|-----------------------|--|
| Items supplied | The rechargeable battery is included with delivery |
| Note | Not free of paint wetting impairment substances. |

Certificates

| | |
|------------------|---|
| Bluetooth | ✓ |
|------------------|---|

Classifications

| | |
|---------------------|----------|
| ECLASS 5.0 | 27280101 |
| ECLASS 5.1.4 | 27280101 |
| ECLASS 6.0 | 27280101 |
| ECLASS 6.2 | 27280101 |
| ECLASS 7.0 | 27280101 |
| ECLASS 8.0 | 27280101 |

| | |
|-----------------------|----------|
| ECLASS 8.1 | 27280101 |
| ECLASS 9.0 | 27280101 |
| ECLASS 10.0 | 27280101 |
| ECLASS 11.0 | 27280101 |
| ECLASS 12.0 | 27280101 |
| ETIM 5.0 | EC002550 |
| ETIM 6.0 | EC002550 |
| ETIM 7.0 | EC002550 |
| ETIM 8.0 | EC002550 |
| UNSPSC 16.0901 | 43211701 |

Reading field diagram IDM14x-3xxS Standard Range IDM16x-3xxS Standard Range

Code resolution in mm (mil)

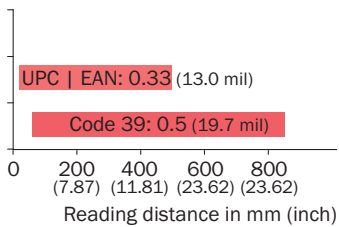

Connection diagram AUX looping

Looping-in via AUX

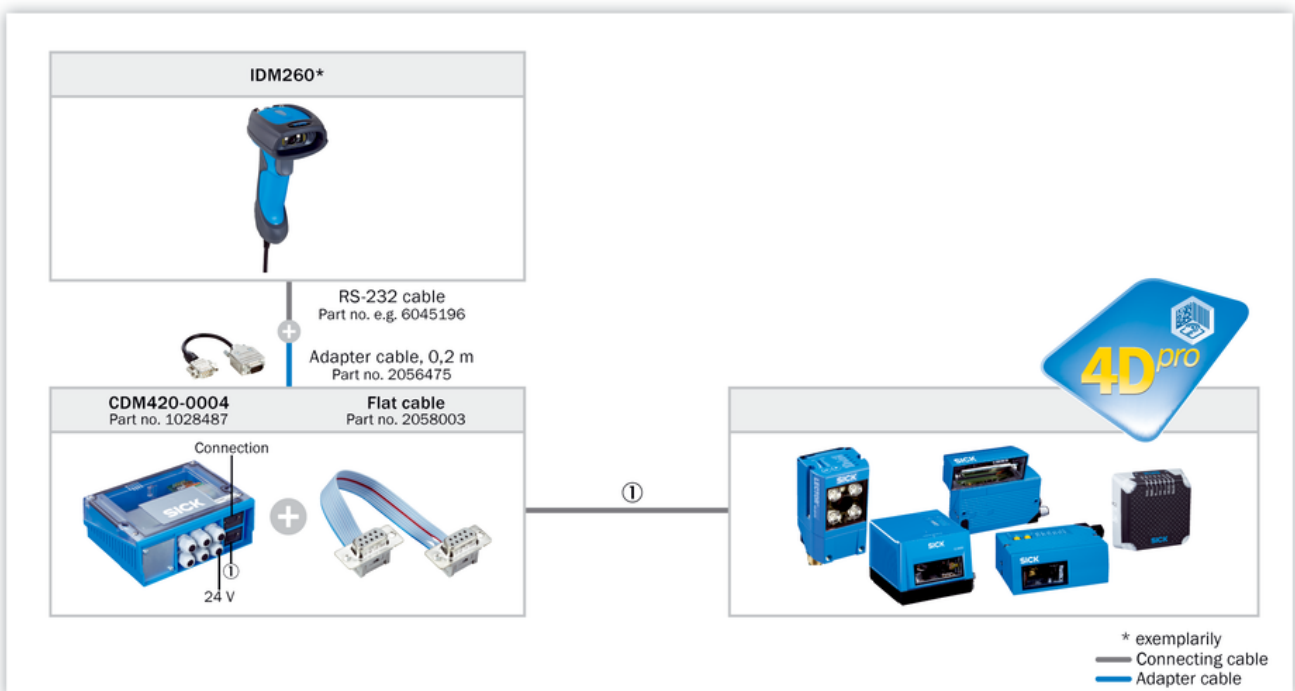

Connection diagram EtherCAT®

EtherCAT®



Connection diagram PROFIBUS DP

PROFIBUS DP

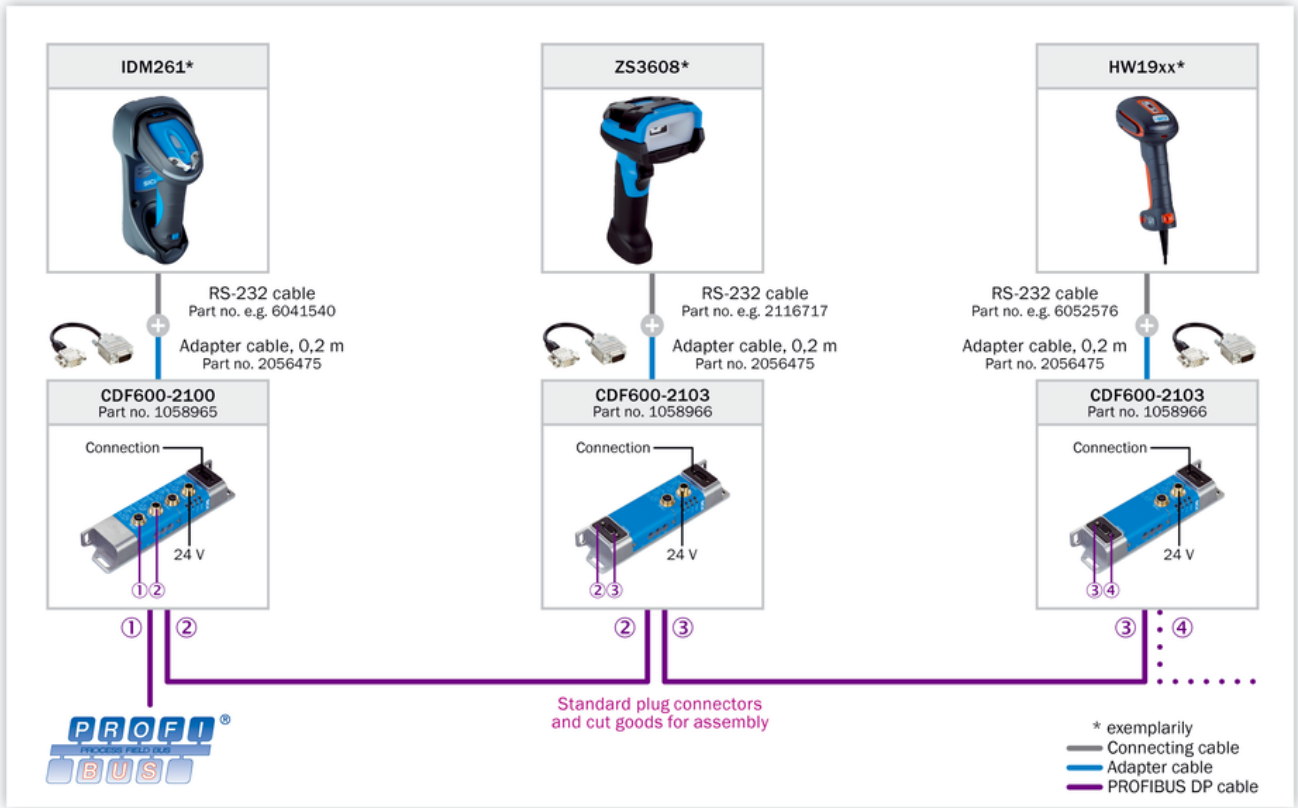

Connection diagram PROFINET IO/RT

PROFINET IO/RT

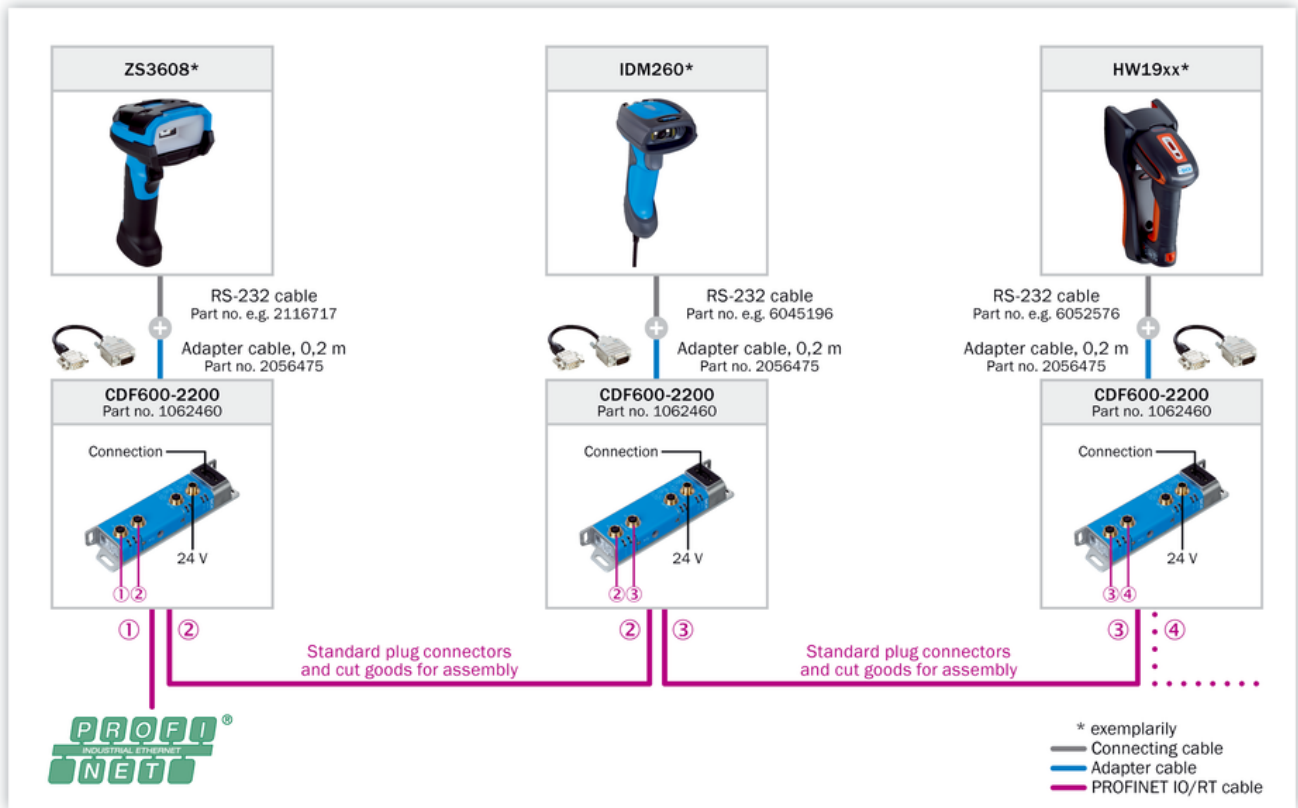

Connection diagram Ethernet TCP/IP

Ethernet TCP/IP

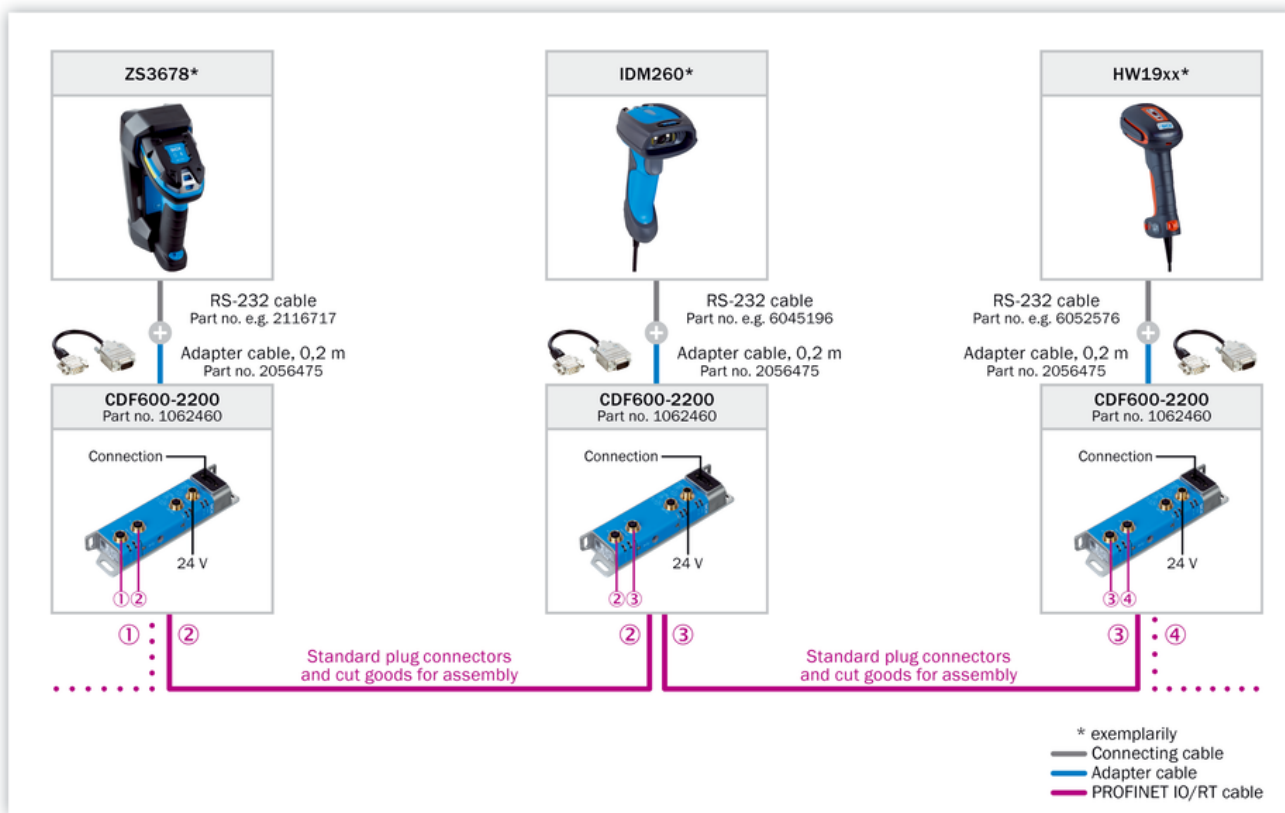

Selection Guide



*) For EtherNet/IP third party gateway is required from e.g. Comtrol or HMS (requires local sourcing).

Recommended accessories

Other models and accessories → www.sick.com/IDM

| | Brief description | Type | part no. |
|---|---|--------------------------------|----------|
| Power supply units and power supply cables | | | |
|  | <ul style="list-style-type: none"> • Input voltage: 100 V AC ... 240 V AC • Output voltage: 5 V DC • Output current: 2 A • Description: Power supply unit, input 100 ... 240 V AC, output 5 V DC/2 A (required when using the RS-232-TTL cable, does not satisfy the medical standard EN 60601 / IEC 60601) | Power supply unit | 6036722 |
| rechargeable batteries and base stations | | | |
|  | <ul style="list-style-type: none"> • Enclosure rating: IP40 • Description: Wireless base station, supply voltage 5 V DC, current consumption max. 680 mA, interface: RS-232 TTL, USB and PS / 2 | Base station | 6053629 |
| connectors and cables | | | |
|  | <ul style="list-style-type: none"> • Connection type head A: Male connector, D-Sub, 9-pin • Connection type head B: Male connector, D-Sub, 15-pin • Items supplied: Incl. 24V/5V DC converter • Cable: 0,3 m • Note: For handheld scanners to CDB620/CDM420/CDF600/CDF600-2, adapter AUX port | YMH-DAC-C30XXXMDSA9 | 2056475 |
| integration modules and adapters | | | |
|  | <ul style="list-style-type: none"> • Description: Connection kit for connecting a hand-held scanner to a PROFINET (Siemens) interface | Hand-held scanner PROFINET kit | 1101488 |
| Mounting systems | | | |
|  | <ul style="list-style-type: none"> • Description: Tripod mount | Stand mount | 6045193 |
|  | <ul style="list-style-type: none"> • Description: Desk holder | Table mount | 6045192 |

SICK AT A GLANCE

SICK is one of the leading manufacturers of intelligent sensors and sensor solutions for industrial applications. A unique range of products and services creates the perfect basis for controlling processes securely and efficiently, protecting individuals from accidents and preventing damage to the environment.

We have extensive experience in a wide range of industries and understand their processes and requirements. With intelligent sensors, we can deliver exactly what our customers need. In application centers in Europe, Asia and North America, system solutions are tested and optimized in accordance with customer specifications. All this makes us a reliable supplier and development partner.

Comprehensive services complete our offering: SICK LifeTime Services provide support throughout the machine life cycle and ensure safety and productivity.

For us, that is “Sensor Intelligence.”

WORLDWIDE PRESENCE:

Contacts and other locations –www.sick.com