



IDM160-310S

IDM

MOBILE HANDHELD SCANNERS

SICK
Sensor Intelligence.



Ordering information

Type	part no.
IDM160-310S	6054547

Other models and accessories → www.sick.com/IDM

Detailed technical data

Features

Application	Industrial application
Version	Standard Range
Scanner design	Cable connection variant
Light source	LED, Visible, Red, 630 nm
Reading distance	20 mm ... 850 mm ¹⁾
Scanning frequency	≤ 500 Hz
Code resolution	≥ 0.076 mm

¹⁾ For details see reading field diagram.

Mechanics/electronics

Supply voltage	5 V DC, ± 10 %
Current consumption	Operation (vibration activated): 230 mA Operation (vibration deactivated): 180 mA Standby: 80 mA
Housing color	Blue, gray
Enclosure rating	IP65
Weight	208 g, without cable
Dimensions (L x W x H)	104 mm x 76.3 mm x 176 mm

Performance

Readable code structures	1D codes, Stacked
Bar code types	Codabar, Code 39, Code 32, UPC-A, UPC-E, Standard and Industrial 2 of 5, Interleaved & Matrix 2 of 5, Code 128, UCC/EAN-128, Code 11, Code 93, German ITF Postal Code, Mainland China Postal Code, Telepen, MSI/Plessey, UK/Plessey, Limited/Expanded GS1 DataBar, Code 39 Trioptic, IATA, UPC / EAN / JAN (with addition)
Stacked code types	PDF417, MicroPDF417, Composite, Codablock F

Interfaces

Ethernet	✓, TCP/IP
Type of fieldbus integration	Optional, over external connection module CDF600-2
PROFINET	✓

	Type of fieldbus integration	Optional over external fieldbus module CDF600-2
	Function	PROFINET Single Port, PROFINET Dual Port
EtherCAT®		✓
	Type of fieldbus integration	Optional over external fieldbus module CDF600
Serial		✓ , RS-232 TTL
PROFIBUS DP		✓
	Type of fieldbus integration	Optional over external fieldbus module CDF600-2
USB		✓
	Function	Keyboard wedge, COM-Port emulation
PS/2		✓
	Function	Keyboard wedge
Optical indicators		2 LEDs (operational status, good read)
Acoustic indicators		Beeper, can be switched off
Vibration		Yes
Configuration software		IDM Setup Tool

Ambient data

Shock resistance	50 drops from 2 m height on concrete
Ambient operating temperature	-10 °C ... +50 °C
Storage temperature	-40 °C ... +70 °C
Permissible relative humidity	± 95 %, Non-condensing
Ambient light immunity	100,000 lx

General notes

Note	A connecting cable and possibly a power supply unit are still required for commissioning.
-------------	---

Classifications

ECLASS 5.0	27280101
ECLASS 5.1.4	27280101
ECLASS 6.0	27280101
ECLASS 6.2	27280101
ECLASS 7.0	27280101
ECLASS 8.0	27280101
ECLASS 8.1	27280101
ECLASS 9.0	27280101
ECLASS 10.0	27280101
ECLASS 11.0	27280101
ECLASS 12.0	27280101
ETIM 5.0	EC002550
ETIM 6.0	EC002550
ETIM 7.0	EC002550
ETIM 8.0	EC002550
UNSPSC 16.0901	43211701

Reading field diagram IDM14x-3xxS Standard Range IDM16x-3xxS Standard Range

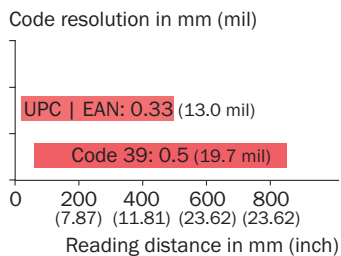

Connection diagram AUX looping

Looping-in via AUX

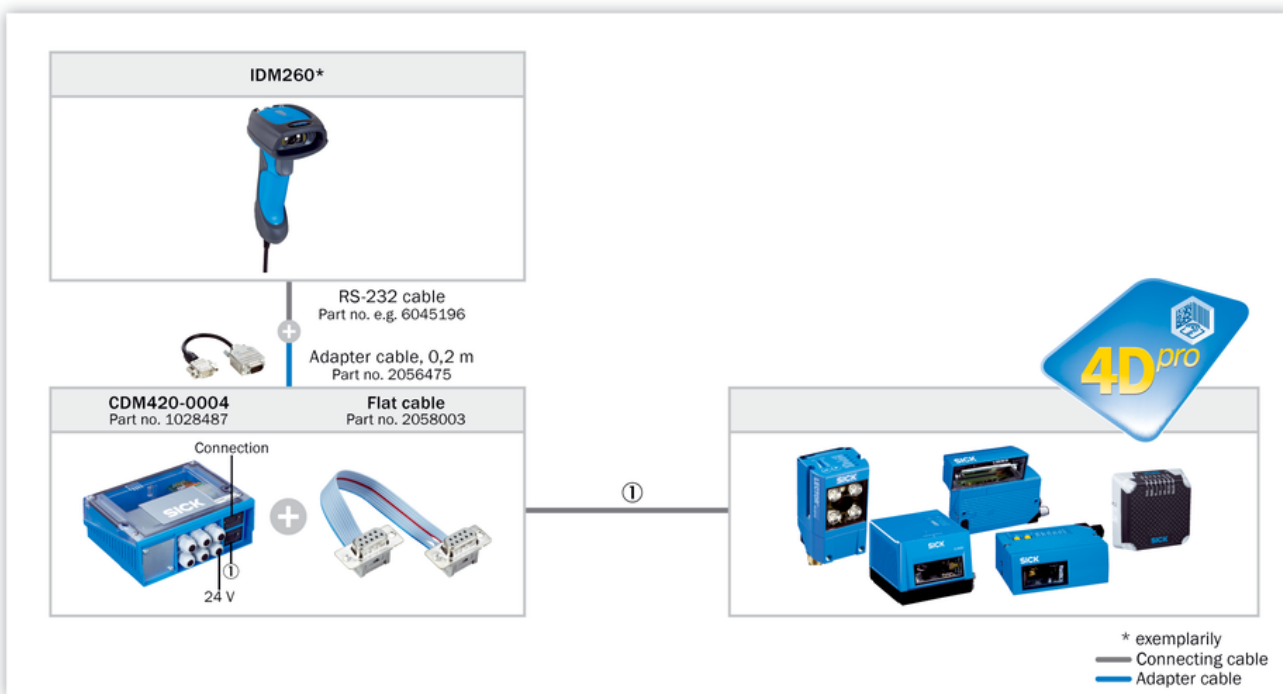

Connection diagram EtherCAT®

EtherCAT®



Connection diagram PROFIBUS DP

PROFIBUS DP

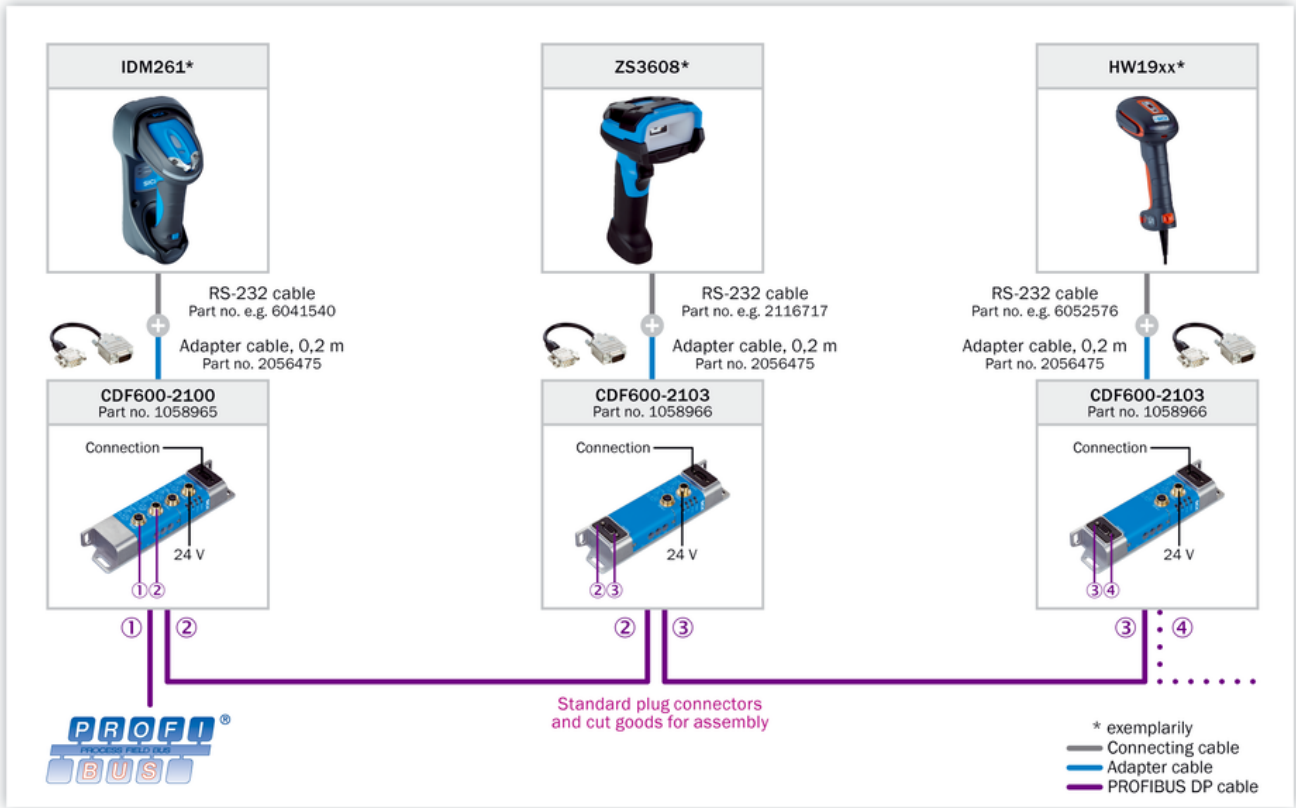

Connection diagram PROFINET IO/RT

PROFINET IO/RT



Connection diagram Ethernet TCP/IP

Ethernet TCP/IP

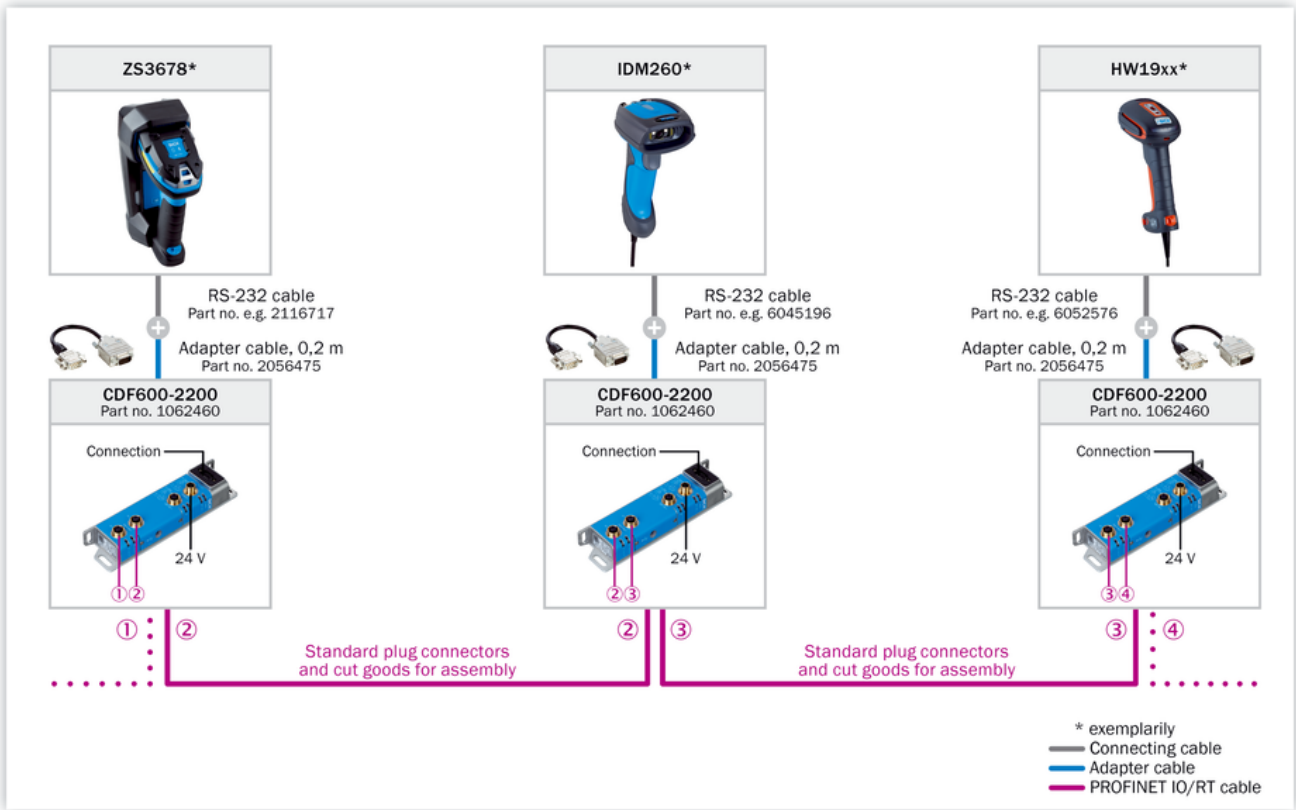

Selection Guide



*) For EtherNet/IP third party gateway is required from e.g. Comtrol or HMS (requires local sourcing).

Recommended accessories

Other models and accessories → www.sick.com/IDM

	Brief description	Type	part no.
Power supply units and power supply cables			
	<ul style="list-style-type: none"> • Input voltage: 100 V AC ... 240 V AC • Output voltage: 5 V DC • Output current: 2 A • Description: Power supply unit, input 100 ... 240 V AC, output 5 V DC/2 A (required when using the RS-232-TTL cable, does not satisfy the medical standard EN 60601 / IEC 60601) 	Power supply unit	6036722
Mounting systems			
	<ul style="list-style-type: none"> • Description: Tripod mount 	Stand mount	6045193
	<ul style="list-style-type: none"> • Description: Desk holder 	Table mount	6045192
integration modules and adapters			
	<ul style="list-style-type: none"> • Description: Connection kit for connecting a hand-held scanner to a PROFINET (Siemens) interface 	Hand-held scanner PROFINET kit	1101488
connectors and cables			
	<ul style="list-style-type: none"> • Description: USB, unshielded • Connection type head A: Male connector, USB-A • Connection type head B: Male connector, RJ45 • Signal type: USB • Cable: 1.8 m, straightened cable • Note: For keyboard wedge or USB Com Port Emulation 	Connection cable	6045195
	<ul style="list-style-type: none"> • Connection type head A: Male connector, D-Sub, 9-pin • Connection type head B: Male connector, D-Sub, 15-pin • Items supplied: Incl. 24V/5V DC converter • Cable: 0.3 m • Note: For handheld scanners to CDB620/CDM420/CDF600/CDF600-2, adapter AUX port 	YMH-DAC-C30XXXMSA9	2056475

SICK AT A GLANCE

SICK is one of the leading manufacturers of intelligent sensors and sensor solutions for industrial applications. A unique range of products and services creates the perfect basis for controlling processes securely and efficiently, protecting individuals from accidents and preventing damage to the environment.

We have extensive experience in a wide range of industries and understand their processes and requirements. With intelligent sensors, we can deliver exactly what our customers need. In application centers in Europe, Asia and North America, system solutions are tested and optimized in accordance with customer specifications. All this makes us a reliable supplier and development partner.

Comprehensive services complete our offering: SICK LifeTime Services provide support throughout the machine life cycle and ensure safety and productivity.

For us, that is “Sensor Intelligence.”

WORLDWIDE PRESENCE:

Contacts and other locations –www.sick.com