



IDM241-100H

IDM

MOBILE HANDHELD SCANNERS

SICK
Sensor Intelligence.



Ordering information

Type	part no.
IDM241-100H	6053051

Other models and accessories → www.sick.com/IDM



Detailed technical data

Features

Task	Identifying - 1D code
Version	High Density
Application	Standard application
Scanner design	Wireless variant
Light source	Internal lighting, LED, Visible, Red, 630 nm Adjustment aid, LED, Visible, Red, 630 nm
Reading distance	30 mm ... 160 mm ¹⁾
Scanning frequency	60 Hz
Code resolution	≥ 0.07 mm ²⁾ ≥ 0.13 mm ³⁾

¹⁾ For details see reading field diagram.

²⁾ Valid for Code 39.

³⁾ Valid for Data Matrix code.

Mechanics/electronics

Supply voltage	5 V DC, ± 5 %
Current consumption	Operation: 300 mA Standby: 180 mA
Housing color	Black, Gray
Enclosure rating	IP41
Weight	230 g, without cable
Dimensions (L x W x H)	95 mm x 70.5 mm x 161.7 mm

Performance

Readable code structures	1D codes, 2D codes, Stacked
Bar code types	Codabar, Code 39, Interleaved 2 of 5, Code 93, Code 128, UPC / GTIN / EAN, RSS, Australian Post, China Post, German Post, US Planet, US Postnet, British Post, Intelligent Mail, Japan Post, Korean Post, Dutch KIX Post
2D code types	Data Matrix, QR code, MicroQR-Code, Aztec, MaxiCode

Stacked code types	PDF417, MicroPDF417, Code 49, Code 16K, Composite, Codablock F
Battery power	Over 60,000 scans with full battery
Code buffer	5,000 Codes (EAN, for scanning in batch mode), 100,000 Codes (EAN, for out of range scanning)

Interfaces

Ethernet	✓
Type of fieldbus integration	Optional, over external connection module CDF600-2
PROFINET	✓
Type of fieldbus integration	Optional over external fieldbus module CDF600-2
Function	PROFINET Single Port, PROFINET Dual Port
EtherCAT®	✓
Type of fieldbus integration	Optional over external fieldbus module CDF600
Serial	✓ , RS-232 TTL
PROFIBUS DP	✓
Type of fieldbus integration	Optional over external fieldbus module CDF600-2
DeviceNet™	✓
Type of fieldbus integration	Optional, over external connection module CDM + CMF
USB	✓
Function	Keyboard wedge, COM-Port emulation
PS/2	✓
Function	Keyboard wedge
Bluetooth	✓
Remark	Bluetooth™ V4.0, 2.402 ... 2.4830 GHz
Function	Wireless operating range up to 100 m (free view), batch function for expansion of the wireless radius, up to seven scanners communicate with one base station
Optical indicators	2 LEDs (good read, charge of battery , radio connection status)
Acoustic indicators	Beeper, can be switched off
Vibration	No
Configuration software	IDM Setup Tool

Ambient data

Shock resistance	25 drops from 1.8 m height on concrete
Ambient operating temperature	-10 °C ... +50 °C
Storage temperature	-40 °C ... +70 °C
Permissible relative humidity	95 %, Non-condensing
Ambient light immunity	100,000 lx

General notes

Items supplied	The rechargeable battery is included with delivery
-----------------------	--

Certificates

Bluetooth	✓
------------------	---

Classifications

ECLASS 5.0	27280101
-------------------	----------

ECLASS 5.1.4	27280101
ECLASS 6.0	27280101
ECLASS 6.2	27280101
ECLASS 7.0	27280101
ECLASS 8.0	27280101
ECLASS 8.1	27280101
ECLASS 9.0	27280101
ECLASS 10.0	27280101
ECLASS 11.0	27280101
ECLASS 12.0	27280101
ETIM 5.0	EC002550
ETIM 6.0	EC002550
ETIM 7.0	EC002550
ETIM 8.0	EC002550
UNSPSC 16.0901	43211701

Reading field diagram IDM2xx-xxxH High Density

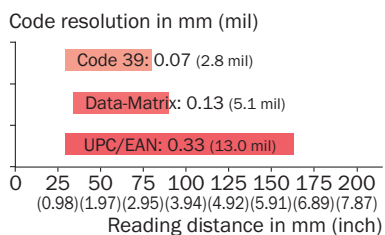

Connection diagram PROFINET IO/RT

PROFINET IO/RT

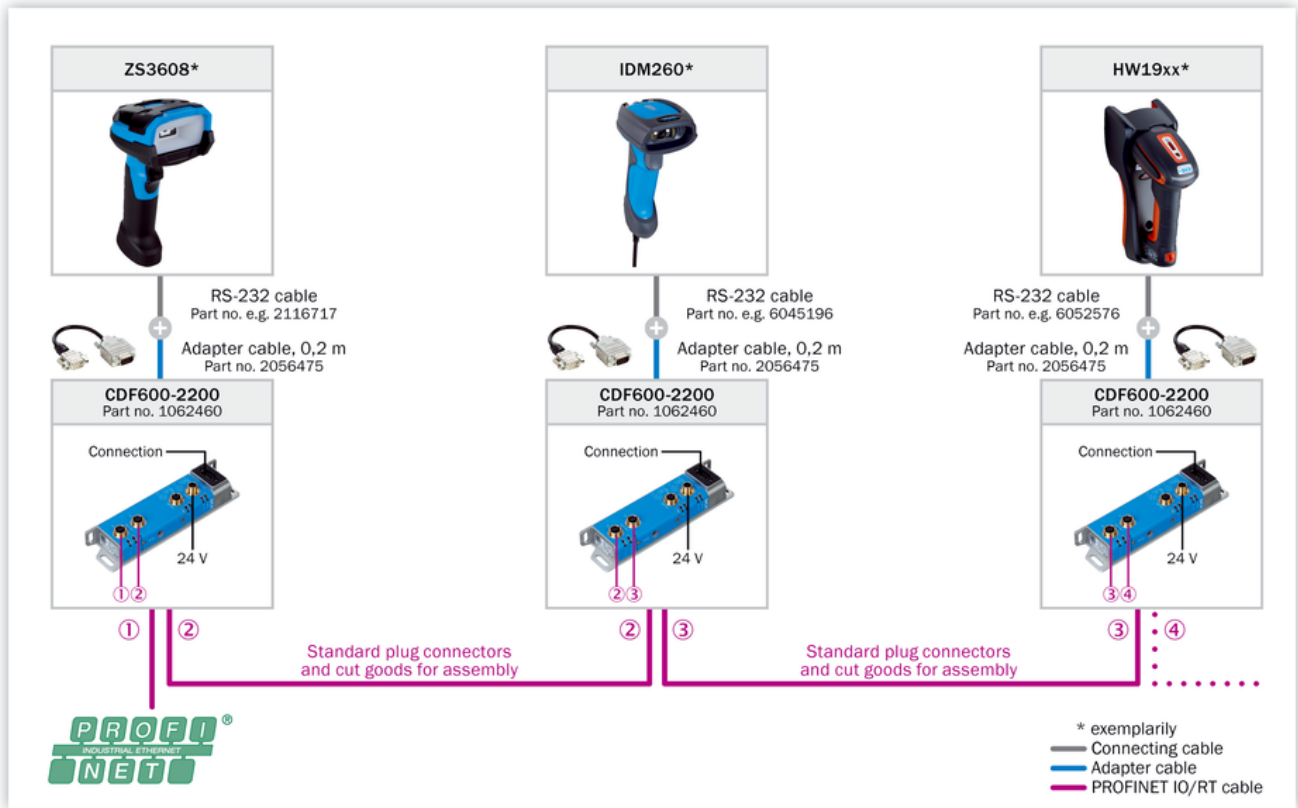

Connection diagram PROFIBUS DP

PROFIBUS DP

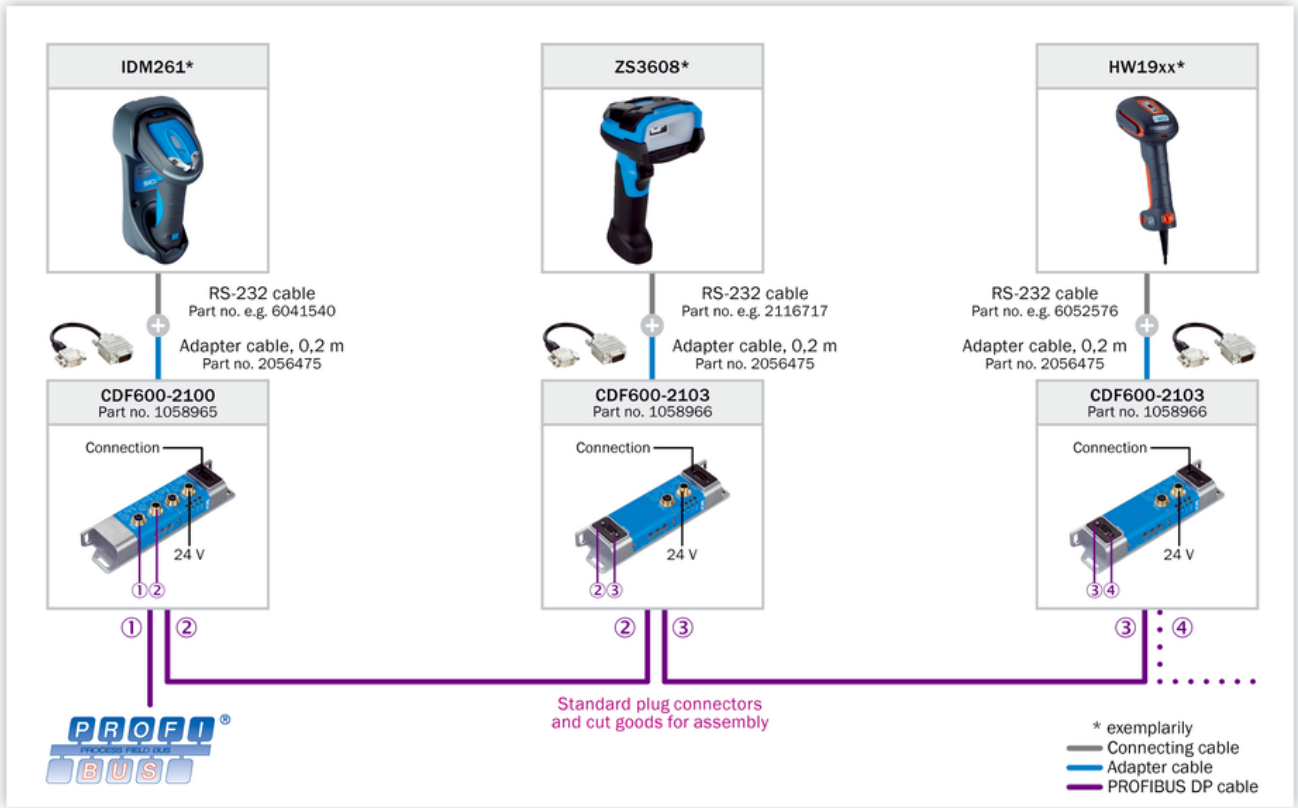

Connection diagram Ethernet TCP/IP

Ethernet TCP/IP

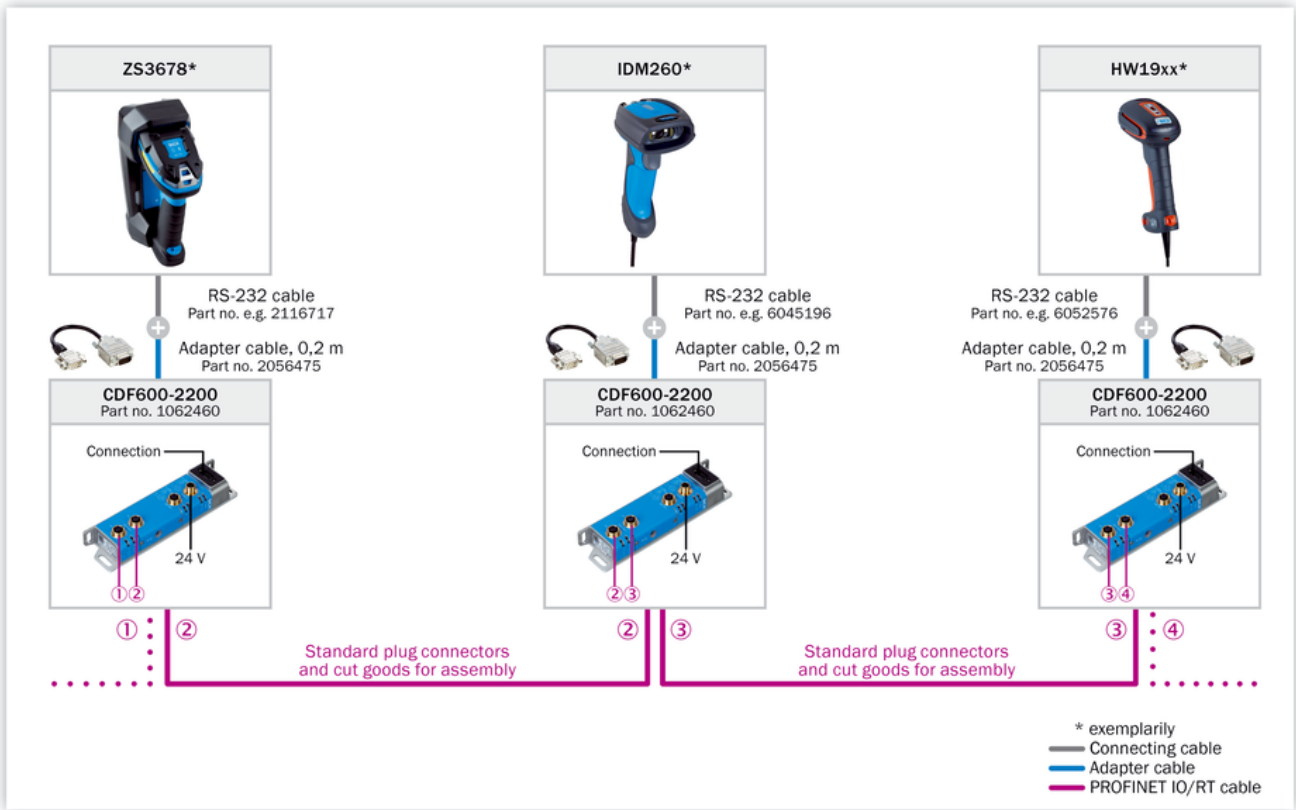

Connection diagram EtherCAT®

EtherCAT®

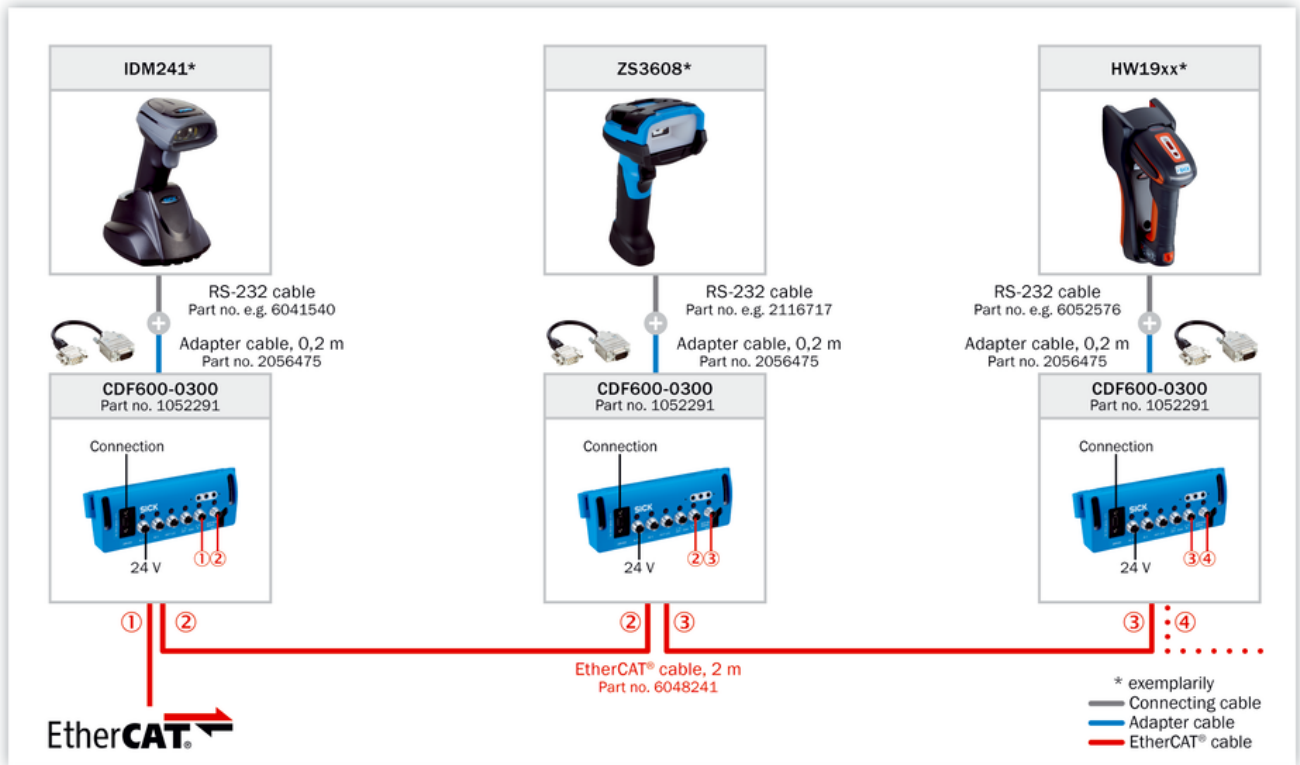

Connection diagram AUX looping

Looping-in via AUX

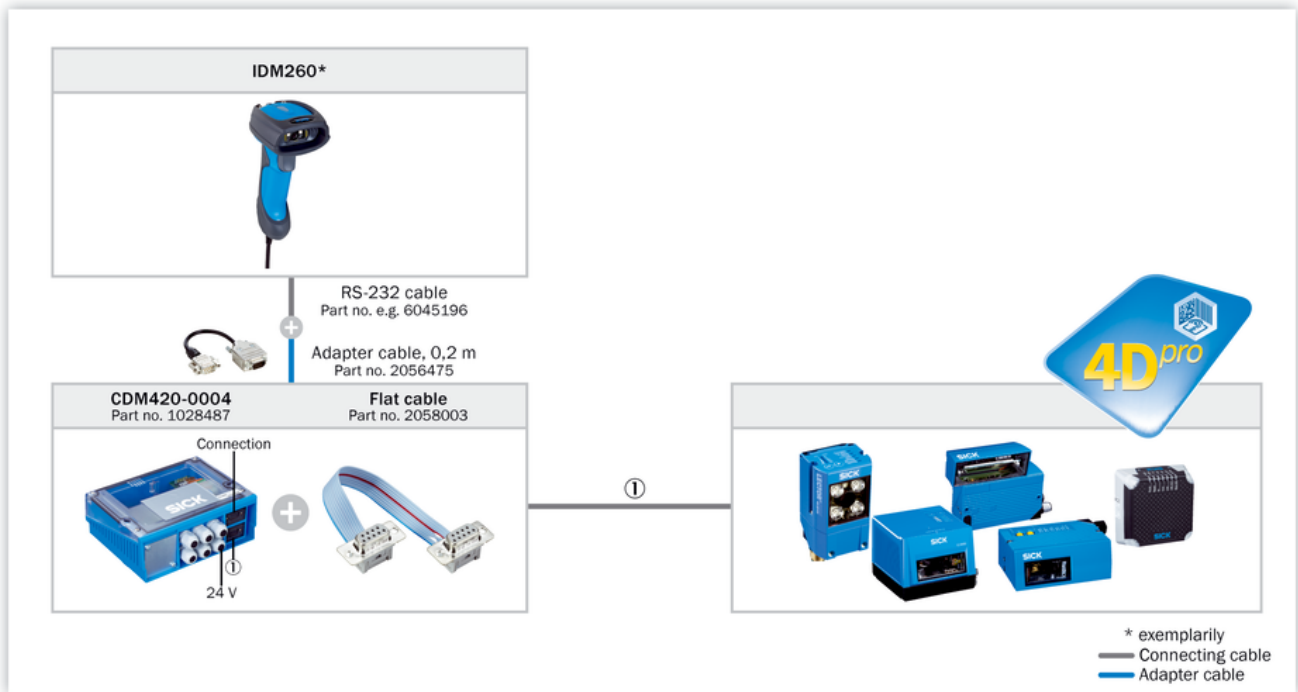





Selection Guide



*) For EtherNet/IP third party gateway is required from e.g. Control or HMS (requires local sourcing).

Recommended accessories

Other models and accessories → www.sick.com/IDM

	Brief description	Type	part no.
Power supply units and power supply cables			
	<ul style="list-style-type: none"> Input voltage: 100 V AC ... 240 V AC Output voltage: 5 V DC Output current: 2 A Description: Power supply, input AC 100 ... 240 V, output DC 5 V/2 A (necessary when using RS-232 TTL cable, does not fulfill medical standard EN 60601/ IEC 60601) 	Power supply unit	6036722
rechargeable batteries and base stations			
	<ul style="list-style-type: none"> Enclosure rating: IP30 Description: Radio base station; operation voltage 5 V DC, power max. 680 mA 	Base station	6053628
	<ul style="list-style-type: none"> Enclosure rating: IP30 Description: Charging station without Bluetooth functionality; operating voltage 5 V DC, operating power max. 650 mA 	Charger station	6041266
connectors and cables			
	<ul style="list-style-type: none"> Connection type head A: Female connector, Mini-DIN, Male connector, Mini-DIN Connection type head B: Male connector, RJ45 Signal type: PS/2 Cable: 2 m, straightened cable Description: PS/2, unshielded 	Connection cable	6036726

SICK AT A GLANCE

SICK is one of the leading manufacturers of intelligent sensors and sensor solutions for industrial applications. A unique range of products and services creates the perfect basis for controlling processes securely and efficiently, protecting individuals from accidents and preventing damage to the environment.

We have extensive experience in a wide range of industries and understand their processes and requirements. With intelligent sensors, we can deliver exactly what our customers need. In application centers in Europe, Asia and North America, system solutions are tested and optimized in accordance with customer specifications. All this makes us a reliable supplier and development partner.

Comprehensive services complete our offering: SICK LifeTime Services provide support throughout the machine life cycle and ensure safety and productivity.

For us, that is “Sensor Intelligence.”

WORLDWIDE PRESENCE:

Contacts and other locations –www.sick.com