



IDM12x-301B

IDM

MOBILE HANDHELD SCANNERS

SICK
Sensor Intelligence.



Ordering information

| Type | part no. |
|-------------|----------|
| IDM12x-301B | 6050059 |

Other models and accessories → www.sick.com/IDM



Detailed technical data

Features

| | |
|---------------------------|-------------------------------|
| Application | Standard application |
| Version | Standard Range |
| Scanner design | Cable connection variant |
| Light source | LED, Visible, Red, 630 nm |
| Reading distance | 0 mm ... 400 mm ¹⁾ |
| Scanning frequency | ≤ 300 Hz |
| Code resolution | 0.1 mm |

¹⁾ For details see reading field diagram.

Mechanics/electronics

| | |
|-------------------------------|-------------------------------------|
| Supply voltage | 5 V DC, ± 5 % |
| Current consumption | Operation: 170 mA Standby: 75 mA |
| Housing color | Black |
| Enclosure rating | IP41 |
| Weight | 106 g |
| Dimensions (L x W x H) | 165 mm x 64.7 mm x 38.7 mm |

Performance

| | |
|---------------------------------|---|
| Readable code structures | 1D codes |
| Bar code types | Code 39, Code 32, HIBC, Code 93, Code 11, Codabar, Code 128, UCC/EAN-128, UPC-A, UPC-E, MSI/Plessey, UK/Plessey, IATA, Standard and Industrial 2 of 5, Matrix 2 of 5, Interleaved 2 of 5, Mainland China Postal Code, German ITF Postal Code, Telepen, Limited/Expanded GS1 Data-Bar, Code 39 Trioptic, IATA, UPC / EAN / JAN (with addition) |

Interfaces

| | |
|------------------------------|--|
| Ethernet | ✓, TCP/IP |
| Type of fieldbus integration | Optional, over external connection module CDF600-2 |
| PROFINET | ✓ |
| Type of fieldbus integration | Optional over external fieldbus module CDF600-2 |
| Function | PROFINET Single Port, PROFINET Dual Port |
| EtherCAT® | ✓ |

| | | |
|-------------------------------|------------------------------|---|
| | Type of fieldbus integration | Optional over external fieldbus module CDF600 |
| Serial | | ✓ , RS-232 TTL |
| PROFIBUS DP | | ✓ |
| | Type of fieldbus integration | Optional over external fieldbus module CDF600-2 |
| USB | | ✓ |
| | Function | Keyboard wedge, USB serial |
| PS/2 | | ✓ |
| | Function | Keyboard wedge |
| Optical indicators | | 1 LED (good read) |
| Acoustic indicators | | Beeper, can be switched off |
| Vibration | | No |
| Configuration software | | IDM Setup Tool |

Ambient data

| | |
|--------------------------------------|--|
| Shock resistance | 25 drops from 1.5 m height on concrete |
| Ambient operating temperature | -10 °C ... +50 °C |
| Storage temperature | -40 °C ... +70 °C |
| Permissible relative humidity | ± 95 %, Non-condensing |
| Ambient light immunity | 80,000 lx |

General notes

| | |
|-------------|---|
| Note | A connecting cable and possibly a power supply unit are still required for commissioning. |
|-------------|---|

Certificates

| | |
|-------------------------------------|---|
| EU declaration of conformity | ✓ |
| China RoHS | ✓ |

Classifications

| | |
|-----------------------|----------|
| ECLASS 5.0 | 27280101 |
| ECLASS 5.1.4 | 27280101 |
| ECLASS 6.0 | 27280101 |
| ECLASS 6.2 | 27280101 |
| ECLASS 7.0 | 27280101 |
| ECLASS 8.0 | 27280101 |
| ECLASS 8.1 | 27280101 |
| ECLASS 9.0 | 27280101 |
| ECLASS 10.0 | 27280101 |
| ECLASS 11.0 | 27280101 |
| ECLASS 12.0 | 27280101 |
| ETIM 5.0 | EC002550 |
| ETIM 6.0 | EC002550 |
| ETIM 7.0 | EC002550 |
| ETIM 8.0 | EC002550 |
| UNSPSC 16.0901 | 43211701 |

Reading field diagram IDM120-3 Standard Range

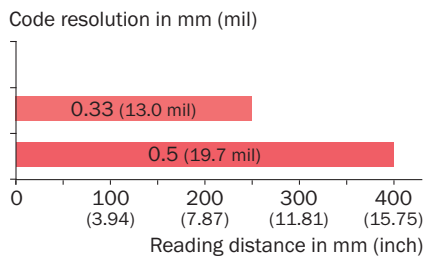

Connection diagram AUX looping

Looping-in via AUX

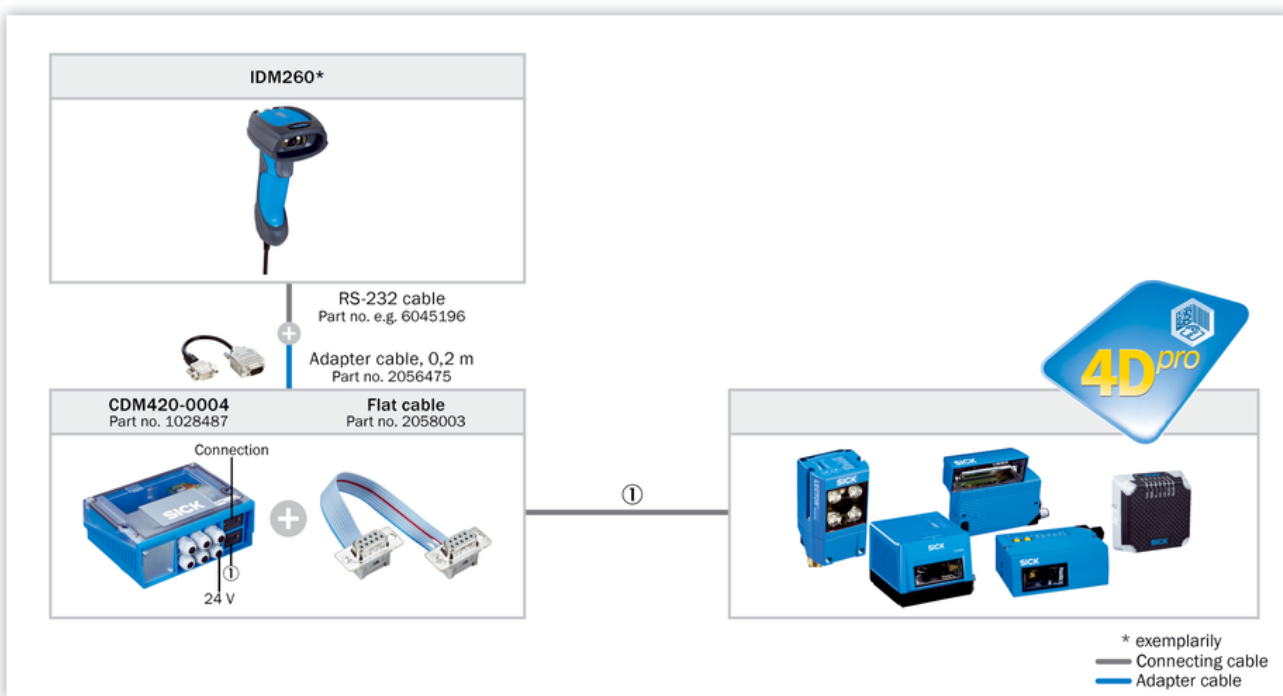

Connection diagram EtherCAT®

EtherCAT®



Connection diagram PROFIBUS DP

PROFIBUS DP

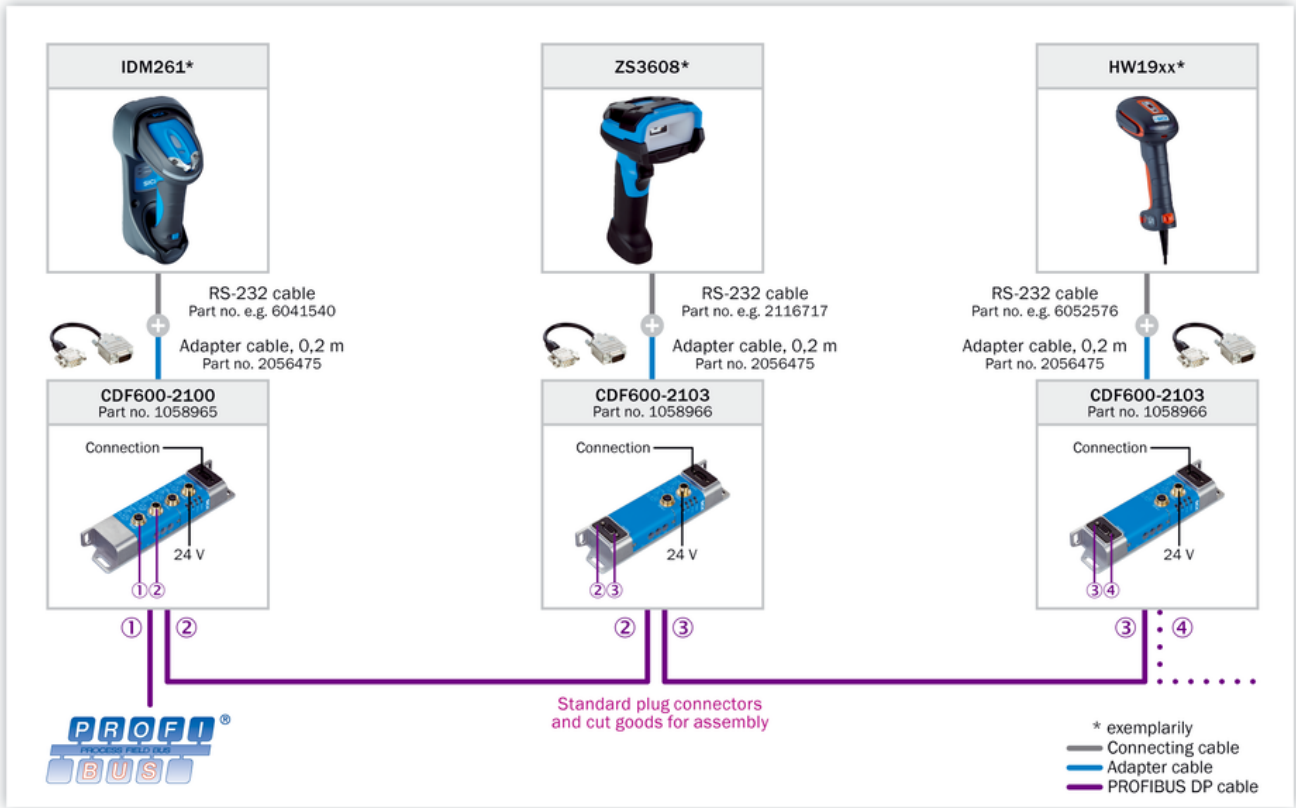

Connection diagram PROFINET IO/RT

PROFINET IO/RT



Connection diagram Ethernet TCP/IP

Ethernet TCP/IP

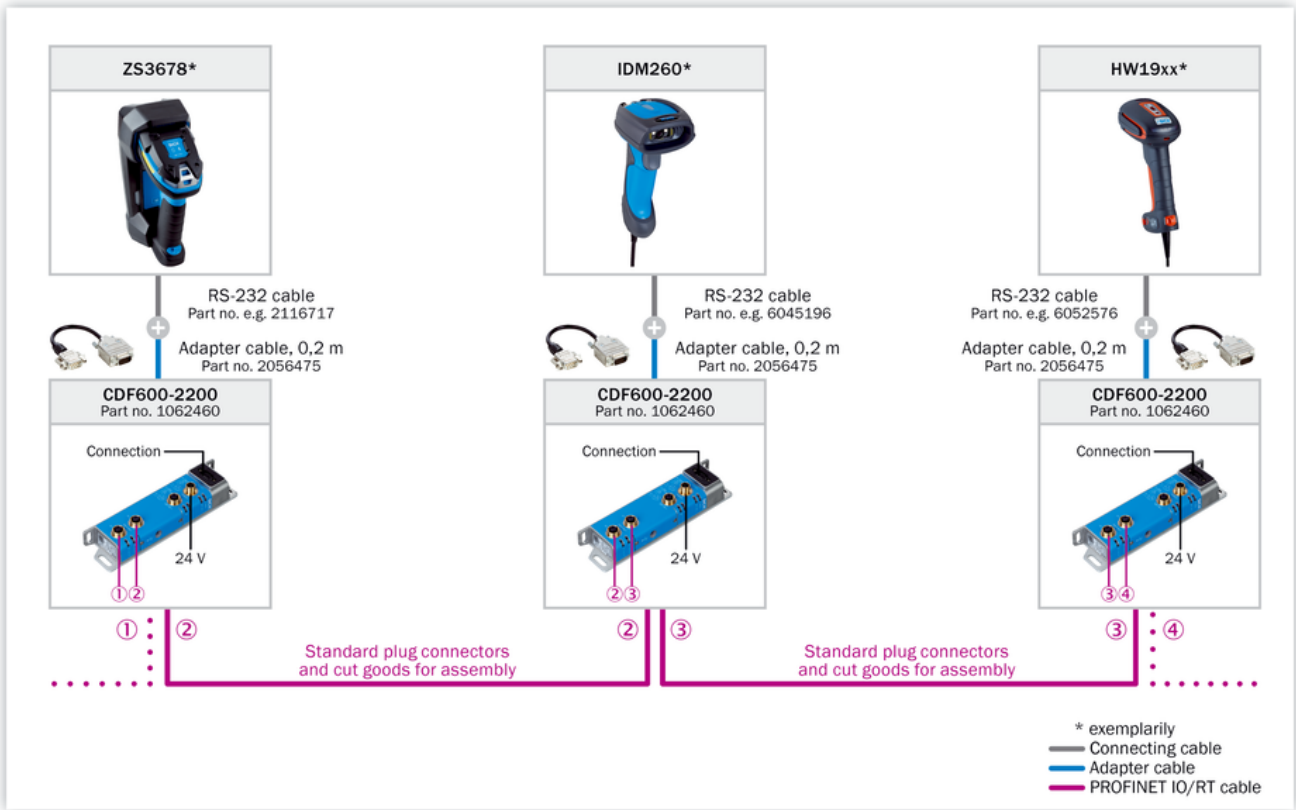



Selection Guide



*) For EtherNet/IP third party gateway is required from e.g. Comtrol or HMS (requires local sourcing).

Recommended accessories

Other models and accessories → www.sick.com/IDM

| | Brief description | Type | part no. |
|---|---|------------------|----------|
| connectors and cables | | | |
|  | <ul style="list-style-type: none"> • Description: PS/2, unshielded • Connection type head A: Female connector, Mini-DIN, Male connector, Mini-DIN • Connection type head B: Male connector, RJ45 • Signal type: PS/2 • Cable: 2 m, straightened cable | Connection cable | 6036726 |
| Mounting systems | | | |
|  | <ul style="list-style-type: none"> • Description: Tripod mount | Stand mount | 6036724 |

SICK AT A GLANCE

SICK is one of the leading manufacturers of intelligent sensors and sensor solutions for industrial applications. A unique range of products and services creates the perfect basis for controlling processes securely and efficiently, protecting individuals from accidents and preventing damage to the environment.

We have extensive experience in a wide range of industries and understand their processes and requirements. With intelligent sensors, we can deliver exactly what our customers need. In application centers in Europe, Asia and North America, system solutions are tested and optimized in accordance with customer specifications. All this makes us a reliable supplier and development partner.

Comprehensive services complete our offering: SICK LifeTime Services provide support throughout the machine life cycle and ensure safety and productivity.

For us, that is “Sensor Intelligence.”

WORLDWIDE PRESENCE:

Contacts and other locations –www.sick.com