



WL130L-32

W130

PHOTOELECTRIC SENSORS

SICK
Sensor Intelligence.



Illustration may differ



Ordering information

Type	part no.
WL130L-32	6029862

Included in delivery: P41F (1)

Other models and accessories → www.sick.com/W130

Detailed technical data

Features

Functional principle	Photoelectric retro-reflective sensor
Dimensions (W x H x D)	13.4 mm x 26.5 mm x 34.6 mm
Housing design (light emission)	Rectangular
Sensing range max.	0 m ... 10 m
Sensing range	0 m ... 7 m
Type of light	Visible red light
Light source	Laser ¹⁾
Light spot size (distance)	Ø 2 mm (2 m)
Laser class	2, IEC 60 825-1/C.D.R.H.
XXX	26 mm x 0.5 mm (200 mm)
Adjustment	None

¹⁾ Average service life: 50,000 h at T_U = +25 °C.

Mechanics/electronics

Connection type	Cable with male connector, 2 m ^{1) 2)}
Cable material	PVC/PBT
Protection class	III
Weight	35 g
Polarisation filter	✓
Housing material	Plastic, PC

¹⁾ Connection between sensor head and evaluation unit with system-specific connector.

²⁾ Do not bend below 0 °C.

Optics material	Plastic, PMMA
Enclosure rating	IP67
Items supplied	P41F reflector
Ambient operating temperature	-10 °C ... +55 °C
Ambient temperature, storage	-25 °C ... +70 °C
UL File No.	242361 (0720256-00)

¹⁾ Connection between sensor head and evaluation unit with system-specific connector.

²⁾ Do not bend below 0 °C.

Certificates

EU declaration of conformity	✓
UK declaration of conformity	✓
ACMA declaration of conformity	✓
Moroccan declaration of conformity	✓
China RoHS	✓
cRUus certificate	✓
Laser safety (IEC 60825-1) certificate	✓

Classifications

ECLASS 5.0	27270902
ECLASS 5.1.4	27270902
ECLASS 6.0	27270902
ECLASS 6.2	27270902
ECLASS 7.0	27270902
ECLASS 8.0	27270902
ECLASS 8.1	27270902
ECLASS 9.0	27270902
ECLASS 10.0	27270902
ECLASS 11.0	27270902
ECLASS 12.0	27270902
ETIM 5.0	EC002717
ETIM 6.0	EC002717
ETIM 7.0	EC002717
ETIM 8.0	EC002717
UNSPSC 16.0901	39121528

Connection type

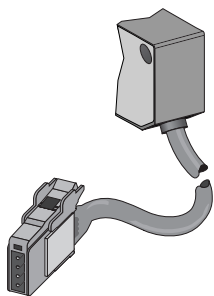

Characteristic curve

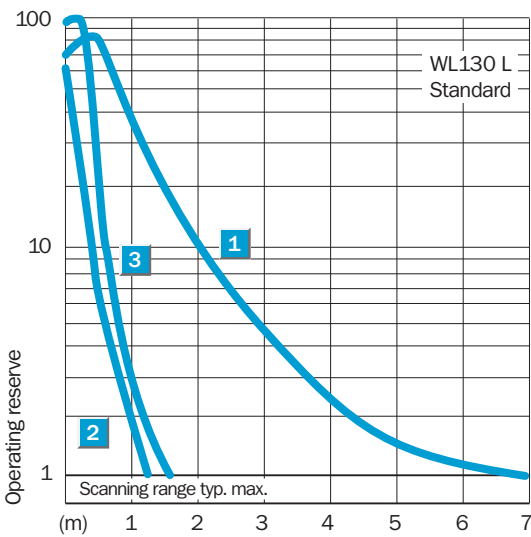

Characteristic curve

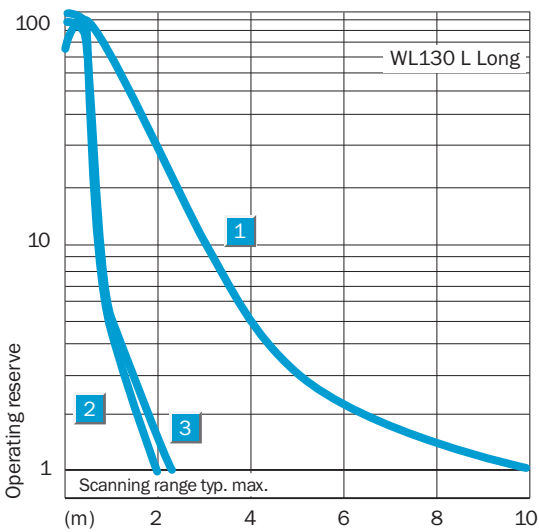

Characteristic curve

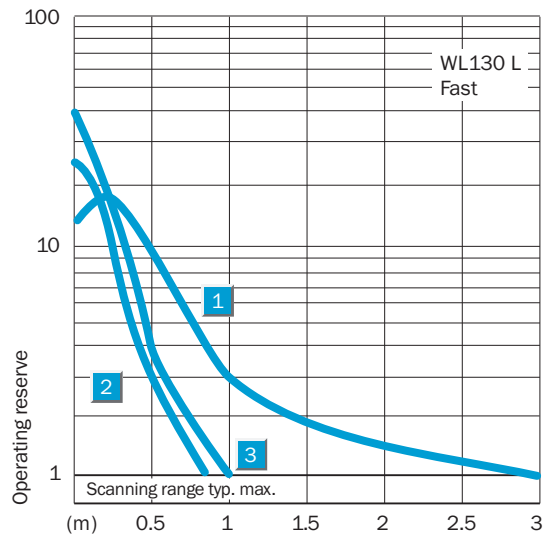

Light spot size

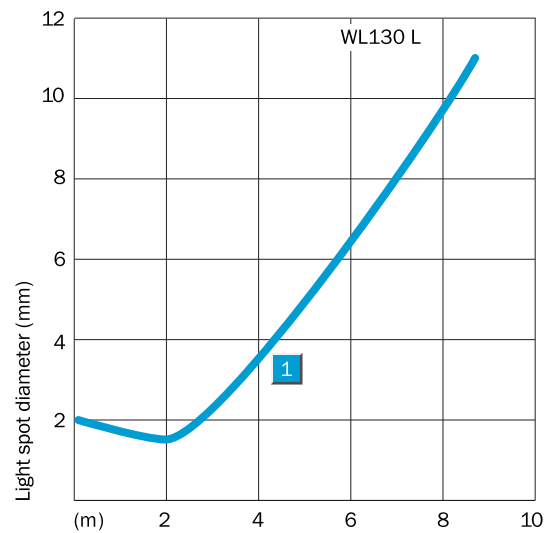

Sensing range diagram

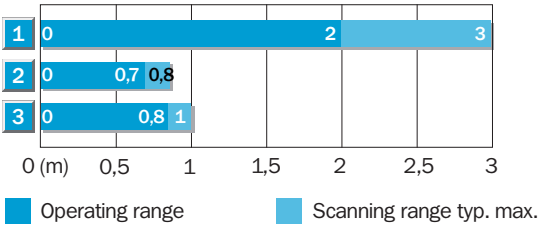

Reflector type	Operating range
1 P41F (without tip adapter lens)	0 ... 2 m
2 P41F (with area tip adapter lens)	0 ... 0.7 m
3 P41F (with line tip adapter lens)	0 ... 0,8 m

Sensing range diagram

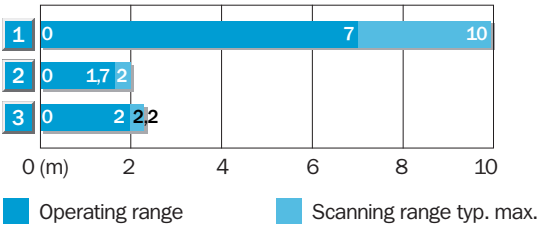

Reflector type	Operating range
1 P41F (without tip adapter lens)	0 ... 7 m
2 P41F (with area tip adapter lens)	0 ... 1.7 m
3 P41F (with line tip adapter lens)	0 ... 2 m

Sensing range diagram

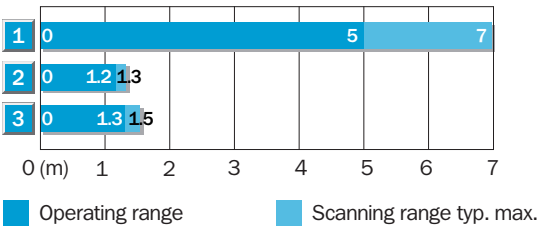

Reflector type	Operating range
1 P41F (without tip adapter lens)	0 ... 5 m
2 P41F (with area tip adapter lens)	0 ... 1.2 m
3 P41F (with line tip adapter lens)	0 ... 1.5 m

Dimensional drawing

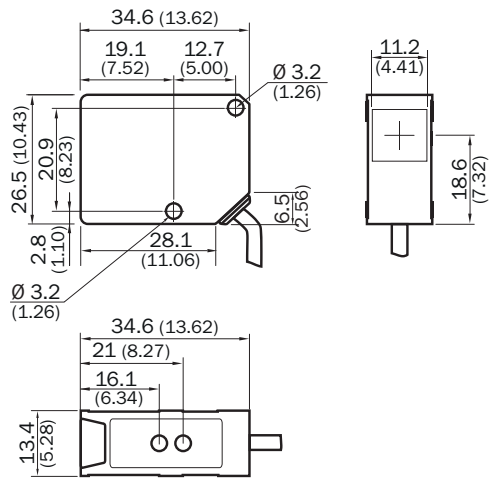

Dimensions in mm (inch)

- ① mounting hole Ø 3.2 mm
- ② Optical axis
- ③ LED indicator green: Supply voltage active
- ④ LED indicator orange: switching output active

Recommended accessories

Other models and accessories → www.sick.com/W130

	Brief description	Type	part no.
Mounting systems			
	<ul style="list-style-type: none"> Description: Universal mounting bracket for reflectors Dimensions (W x H x L): 85 mm x 90 mm x 35 mm Material: Steel Details: Steel, zinc coated Suitable for: C110A, P250, PL20, PL30A, PL40A, PL80A 	BEF-WN-REFX	2064574

SICK AT A GLANCE

SICK is one of the leading manufacturers of intelligent sensors and sensor solutions for industrial applications. A unique range of products and services creates the perfect basis for controlling processes securely and efficiently, protecting individuals from accidents and preventing damage to the environment.

We have extensive experience in a wide range of industries and understand their processes and requirements. With intelligent sensors, we can deliver exactly what our customers need. In application centers in Europe, Asia and North America, system solutions are tested and optimized in accordance with customer specifications. All this makes us a reliable supplier and development partner.

Comprehensive services complete our offering: SICK LifeTime Services provide support throughout the machine life cycle and ensure safety and productivity.

For us, that is “Sensor Intelligence.”

WORLDWIDE PRESENCE:

Contacts and other locations –www.sick.com