

WL260-0230S01
W260

PHOTOELECTRIC SENSORS

SICK
Sensor Intelligence.



Illustration may differ

Ordering information

Type	part no.
WL260-0230S01	6010102

Included in delivery: BEF-W260 (1)

Other models and accessories → www.sick.com/W260

Detailed technical data

Features

Functional principle	Photoelectric retro-reflective sensor
Functional principle detail	Dual lens
Dimensions (W x H x D)	25 mm x 78 mm x 63 mm
Housing design (light emission)	Rectangular
Sensing range max.	0.01 m ... 15 m ¹⁾
Sensing range	0.01 m ... 10 m ²⁾ 0.01 m ... 13 m ¹⁾
Focus	Approx. 1.7°
Type of light	Visible red light
Light source	LED ³⁾
Light spot size (distance)	Ø 300 mm (10 m)
Angle of dispersion	Approx. 1.7°
Adjustment	Potentiometer, 270°
Special features	Two relays with two contacts in serial, test point

¹⁾ Reflector PL80A.

²⁾ Reflector P250.

³⁾ Average service life: 100,000 h at T_U = +25 °C.

Mechanics/electronics

Supply voltage	20 V AC/DC ... 30 V AC/DC ¹⁾
Current consumption	70 mA ²⁾
Switching output	Relay ³⁾

¹⁾ Limit values.

²⁾ Without load.

³⁾ Provide suitable spark suppression for inductive or capacitive loads.

⁴⁾ With light/dark ratio 1:1.

⁵⁾ A = V_S connections reverse-polarity protected.

⁶⁾ C = interference suppression.

⁷⁾ Rated voltage: 250 V AC/DC.

Output function	NO
Switching mode	Light switching ³⁾
Switching current (switching voltage)	2 A
Response time	≤ 20 ms
Switching frequency	25 Hz ⁴⁾
Connection type	Cable gland
Circuit protection	A ⁵⁾ C ⁶⁾
Protection class	II ⁷⁾
Weight	120 g
Polarisation filter	✓
Special device	✓
Housing material	Plastic, ABS
Optics material	Plastic, PMMA
Enclosure rating	IP66
Items supplied	Mounting bracket BEF-W260
Ambient operating temperature	-20 °C ... +55 °C
Ambient temperature, storage	-30 °C ... +70 °C
UL File No.	EN50081-1, 242356

1) Limit values.

2) Without load.

3) Provide suitable spark suppression for inductive or capacitive loads.

4) With light/dark ratio 1:1.

5) A = V_S connections reverse-polarity protected.

6) C = interference suppression.

7) Rated voltage: 250 V AC/DC.

Classifications

ECLASS 5.0	27270902
ECLASS 5.1.4	27270902
ECLASS 6.0	27270902
ECLASS 6.2	27270902
ECLASS 7.0	27270902
ECLASS 8.0	27270902
ECLASS 8.1	27270902
ECLASS 9.0	27270902
ECLASS 10.0	27270902
ECLASS 11.0	27270902
ECLASS 12.0	27270902
ETIM 5.0	EC002717
ETIM 6.0	EC002717
ETIM 7.0	EC002717
ETIM 8.0	EC002717

UNSPSC 16.0901	39121528
----------------	----------

Connection type

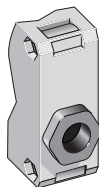

Characteristic curve

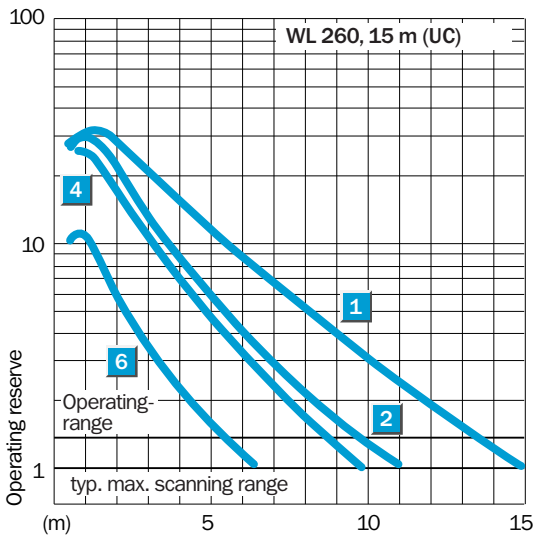

Sensing range diagram

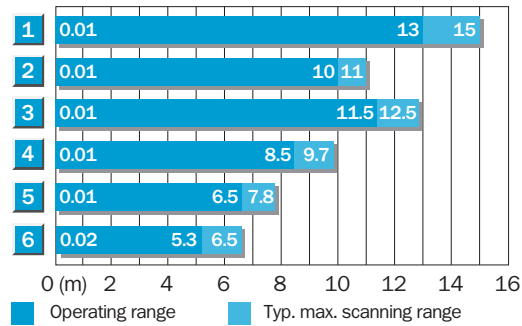

	Reflector type	Operating range
1	PL 80 A	0.01 ... 13.0 m
2	P 250	0.01 ... 10.0 m
3	PL 50 A or PL 40 A	0.01 ... 11.5 m
4	PL 30 A or PL 31 A	0.01 ... 8.5 m
5	PL 20 A	0.01 ... 6.5 m
6	Reflective tape Diamond Grade	0.02 ... 5.3 m

Adjustments

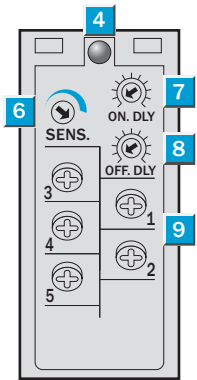

- ④ LED signal strength indicator, red
- ⑥ sensitivity control
- ⑦ Time control ON delay t_{ON}
- ⑧ Time control OFF delay t_{OFF}
- ⑨ Terminals

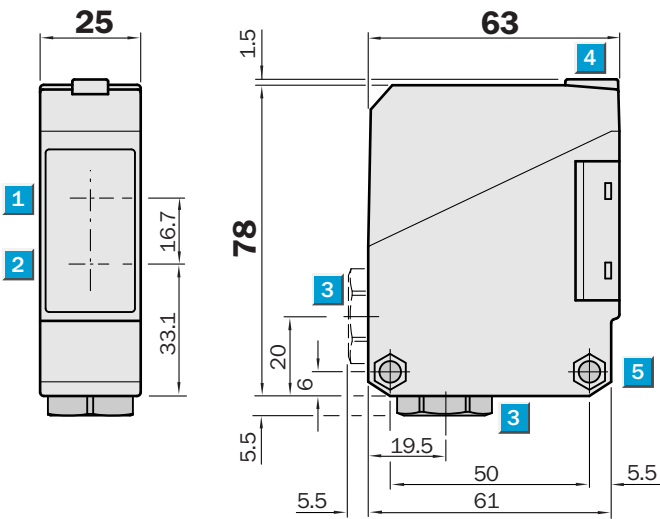

Dimensional drawing



Dimensions in mm (inch)

Recommended accessories

Other models and accessories → www.sick.com/W260

	Brief description	Type	part no.
Mounting systems			
	<ul style="list-style-type: none">• Description: Mounting bracket• Material: Steel• Details: Steel, zinc coated• Items supplied: Without mounting hardware	BEF-W260	5304819
	<ul style="list-style-type: none">• Description: Universal mounting bracket for reflectors• Dimensions (W x H x L): 85 mm x 90 mm x 35 mm• Material: Steel• Details: Steel, zinc coated• Suitable for: C110A, P250, PL20, PL30A, PL40A, PL80A	BEF-WN-REFX	2064574
reflectors and optics			
	<ul style="list-style-type: none">• Description: Rectangular, screw connection• Dimensions: 51 mm 61 mm• Ambient operating temperature: -30 °C ... +65 °C	P250	5304812

SICK AT A GLANCE

SICK is one of the leading manufacturers of intelligent sensors and sensor solutions for industrial applications. A unique range of products and services creates the perfect basis for controlling processes securely and efficiently, protecting individuals from accidents and preventing damage to the environment.

We have extensive experience in a wide range of industries and understand their processes and requirements. With intelligent sensors, we can deliver exactly what our customers need. In application centers in Europe, Asia and North America, system solutions are tested and optimized in accordance with customer specifications. All this makes us a reliable supplier and development partner.

Comprehensive services complete our offering: SICK LifeTime Services provide support throughout the machine life cycle and ensure safety and productivity.

For us, that is “Sensor Intelligence.”

WORLDWIDE PRESENCE:

Contacts and other locations –www.sick.com