



# FLX0-GPNT100

Flexi Compact

**SAFETY CONTROLLERS**

**SICK**  
Sensor Intelligence.



Ordering information

Type	part no.
FLX0-GPNT100	1085356

Other models and accessories → [www.sick.com/Flexi\\_Compact](http://www.sick.com/Flexi_Compact)



Detailed technical data

Features

Module	Gateway
Description	The gateway module enables a safety controller to send data to a network for control and diagnostic purposes, and to receive data from the network.
Security Level	SL-C 1 (IEC 62443-4-2)
Fieldbus	PROFINET TCP/IP sockets
Configuration method	Via software (Safety Designer)
Items supplied	Gateway Operating instructions for download

Functions

Integration into a PROFINET network as a field device	✓
Communication of multiple applications with the safety controller via TCP/IP sockets	✓
Configuration of the safety controller via TCP/IP	✓

Interfaces

Configuration and diagnostics	
TCP/IP configuration interface	✓
Configuration via TFT display	✓
Fieldbus	PROFINET TCP/IP sockets
Fieldbus interface	2 x female connector, RJ45
Note	The module is equipped with an integrated switch. The switch enables the module to be connected to another Ethernet component (e.g., to a computer) without having to interrupt the connection of the fieldbus network.

<b>Display elements</b>	TFT display
-------------------------	-------------

## Electronics

<b>Protection class</b>	III (EN 61140)
<b>Interference resistance</b>	EN 61000-6-2
<b>Interference emission</b>	EN 61000-6-4
<b>Voltage supply</b>	The voltage supply of the extension modules is maintained via the backplane bus
<b>Power loss</b>	≤ 3.3 W
<b>Current consumption at nominal voltage</b>	135 mA

## Mechanics

<b>Dimensions (W x H x D)</b>	18 mm x 124.7 mm x 85.5 mm
<b>Contamination rating</b>	2 (IEC 61010-1)
<b>Control device type</b>	Open device (IEC 61010-2-201)
<b>Weight</b>	108 g (± 5 %)
<b>Mounting</b>	Mounting on a 35 mm × 7.5 mm mounting rail in accordance with IEC 60715

## Ambient data

<b>Enclosure rating</b>	IP20 (EN 60529)
<b>Ambient operating temperature</b>	−25 °C ... +55 °C <sup>1)</sup>
<b>Storage temperature</b>	−25 °C ... +70 °C
<b>Air humidity</b>	≤ 95 %, Non-condensing
<b>Vibration resistance</b>	1 g, 5 Hz ... 200 Hz (EN 60068-2-6)
<b>Shock resistance</b>	15 g, 11 ms (EN 60068-2-27)

<sup>1)</sup> At altitudes up to 2,000 m above sea level For higher areas of application up to max. 4,000 m above sea level, see the operating instructions.

## Certificates

<b>EU declaration of conformity</b>	✓
<b>UK declaration of conformity</b>	✓
<b>ACMA declaration of conformity</b>	✓
<b>China RoHS</b>	✓
<b>cULus certificate</b>	✓
<b>S Mark certificate</b>	✓
<b>Information according to Art. 3 of Data Act (Regulation EU 2023/2854)</b>	✓
<b>Cybersecurity certificate</b>	✓

## Classifications

<b>ECLASS 5.0</b>	27243001
<b>ECLASS 5.1.4</b>	27243101
<b>ECLASS 6.0</b>	27243101
<b>ECLASS 6.2</b>	27243101
<b>ECLASS 7.0</b>	27243101
<b>ECLASS 8.0</b>	27243101
<b>ECLASS 8.1</b>	27243101

<b>ECLASS 9.0</b>	27243101
<b>ECLASS 10.0</b>	27243101
<b>ECLASS 11.0</b>	27243101
<b>ECLASS 12.0</b>	27243101
<b>ETIM 5.0</b>	EC001449
<b>ETIM 6.0</b>	EC001449
<b>ETIM 7.0</b>	EC001449
<b>ETIM 8.0</b>	EC001449
<b>UNSPSC 16.0901</b>	32151705

Dimensional drawing GETC1, GPNT1 gateways

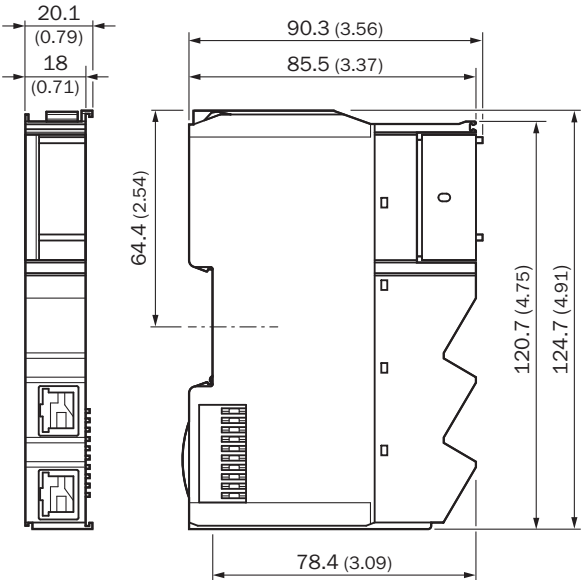

Dimensions in mm (inch)

## Recommended accessories

Other models and accessories → [www.sick.com/Flexi\\_Compact](http://www.sick.com/Flexi_Compact)

	Brief description	Type	part no.
Safety relays			
	<ul style="list-style-type: none"> <li>• <b>Applications:</b> Output expansion module for OSSDs</li> <li>• <b>Compatible sensor types:</b> Safety sensors with OSSDs</li> <li>• <b>Connection type:</b> Front connector with spring terminals</li> <li>• <b>Restart interlock:</b> no</li> <li>• <b>External device monitoring (EDM):</b> Via path</li> <li>• <b>Outputs:</b> 4 enabling current paths (safe), 1 feedback current path (for use as external device monitoring, not safe), 1 signaling current path (not safe)</li> <li>• <b>Housing width:</b> 28 mm</li> </ul>	RLY3-OSSD400	1099971
	<ul style="list-style-type: none"> <li>• <b>Applications:</b> Output expansion module for OSSDs</li> <li>• <b>Compatible sensor types:</b> Safety sensors with OSSDs</li> <li>• <b>Connection type:</b> Front connector with spring terminals</li> <li>• <b>Restart interlock:</b> no</li> <li>• <b>External device monitoring (EDM):</b> Via path</li> <li>• <b>Outputs:</b> 2 enabling current paths (safe), 1 feedback current path (for use as external device monitoring, not safe)</li> <li>• <b>Housing width:</b> 18 mm</li> </ul>	RLY3-OSSD100	1085343

## SICK AT A GLANCE

SICK is one of the leading manufacturers of intelligent sensors and sensor solutions for industrial applications. A unique range of products and services creates the perfect basis for controlling processes securely and efficiently, protecting individuals from accidents and preventing damage to the environment.

We have extensive experience in a wide range of industries and understand their processes and requirements. With intelligent sensors, we can deliver exactly what our customers need. In application centers in Europe, Asia and North America, system solutions are tested and optimized in accordance with customer specifications. All this makes us a reliable supplier and development partner.

Comprehensive services complete our offering: SICK LifeTime Services provide support throughout the machine life cycle and ensure safety and productivity.

For us, that is “Sensor Intelligence.”

## WORLDWIDE PRESENCE:

Contacts and other locations –[www.sick.com](http://www.sick.com)