



# IDM160-310S

IDM

MOBILE HANDHELD SCANNERS

**SICK**  
Sensor Intelligence.



## Ordering information

Type	part no.
IDM160-310S	6054547

Other models and accessories → [www.sick.com/IDM](http://www.sick.com/IDM)

## Detailed technical data

### Features

<b>Application</b>	Industrial application
<b>Version</b>	Standard Range
<b>Scanner design</b>	Cable connection variant
<b>Light source</b>	LED, Visible, Red, 630 nm
<b>Reading distance</b>	20 mm ... 850 mm <sup>1)</sup>
<b>Scanning frequency</b>	≤ 500 Hz
<b>Code resolution</b>	≥ 0.076 mm

<sup>1)</sup> For details see reading field diagram.

### Mechanics/electronics

<b>Supply voltage</b>	5 V DC, ± 10 %
<b>Current consumption</b>	Operation (vibration activated): 230 mA Operation (vibration deactivated): 180 mA Standby: 80 mA
<b>Housing color</b>	Blue, gray
<b>Enclosure rating</b>	IP65
<b>Weight</b>	208 g, without cable
<b>Dimensions (L x W x H)</b>	104 mm x 76.3 mm x 176 mm

### Performance

<b>Readable code structures</b>	1D codes, Stacked
<b>Bar code types</b>	Codabar, Code 39, Code 32, UPC-A, UPC-E, Standard and Industrial 2 of 5, Interleaved & Matrix 2 of 5, Code 128, UCC/EAN-128, Code 11, Code 93, German ITF Postal Code, Mainland China Postal Code, Telepen, MSI/Plessey, UK/Plessey, Limited/Expanded GS1 DataBar, Code 39 Trioptic, IATA, UPC / EAN / JAN (with addition)
<b>Stacked code types</b>	PDF417, MicroPDF417, Composite, Codablock F

### Interfaces

<b>Ethernet</b>	✓, TCP/IP
Type of fieldbus integration	Optional, over external connection module CDF600-2
<b>PROFINET</b>	✓

	Type of fieldbus integration	Optional over external fieldbus module CDF600-2
	Function	PROFINET Single Port, PROFINET Dual Port
<b>EtherCAT®</b>		✓
	Type of fieldbus integration	Optional over external fieldbus module CDF600
<b>Serial</b>		✓ , RS-232 TTL
<b>PROFIBUS DP</b>		✓
	Type of fieldbus integration	Optional over external fieldbus module CDF600-2
<b>USB</b>		✓
	Function	Keyboard wedge, COM-Port emulation
<b>PS/2</b>		✓
	Function	Keyboard wedge
<b>Optical indicators</b>		2 LEDs (operational status, good read)
<b>Acoustic indicators</b>		Beeper, can be switched off
<b>Vibration</b>		Yes
<b>Configuration software</b>		IDM Setup Tool

#### Ambient data

<b>Shock resistance</b>	50 drops from 2 m height on concrete
<b>Ambient operating temperature</b>	-10 °C ... +50 °C
<b>Storage temperature</b>	-40 °C ... +70 °C
<b>Permissible relative humidity</b>	± 95 %, Non-condensing
<b>Ambient light immunity</b>	100,000 lx

#### General notes

<b>Note</b>	A connecting cable and possibly a power supply unit are still required for commissioning.
-------------	-------------------------------------------------------------------------------------------

#### Classifications

<b>ECLASS 5.0</b>	27280101
<b>ECLASS 5.1.4</b>	27280101
<b>ECLASS 6.0</b>	27280101
<b>ECLASS 6.2</b>	27280101
<b>ECLASS 7.0</b>	27280101
<b>ECLASS 8.0</b>	27280101
<b>ECLASS 8.1</b>	27280101
<b>ECLASS 9.0</b>	27280101
<b>ECLASS 10.0</b>	27280101
<b>ECLASS 11.0</b>	27280101
<b>ECLASS 12.0</b>	27280101
<b>ETIM 5.0</b>	EC002550
<b>ETIM 6.0</b>	EC002550
<b>ETIM 7.0</b>	EC002550
<b>ETIM 8.0</b>	EC002550
<b>UNSPSC 16.0901</b>	43211701

Reading field diagram IDM14x-3xxS Standard Range IDM16x-3xxS Standard Range

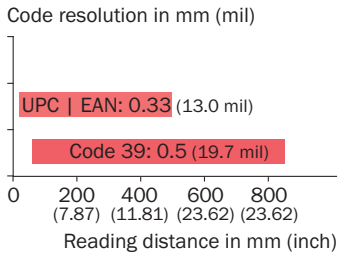

Connection diagram AUX looping

Looping-in via AUX

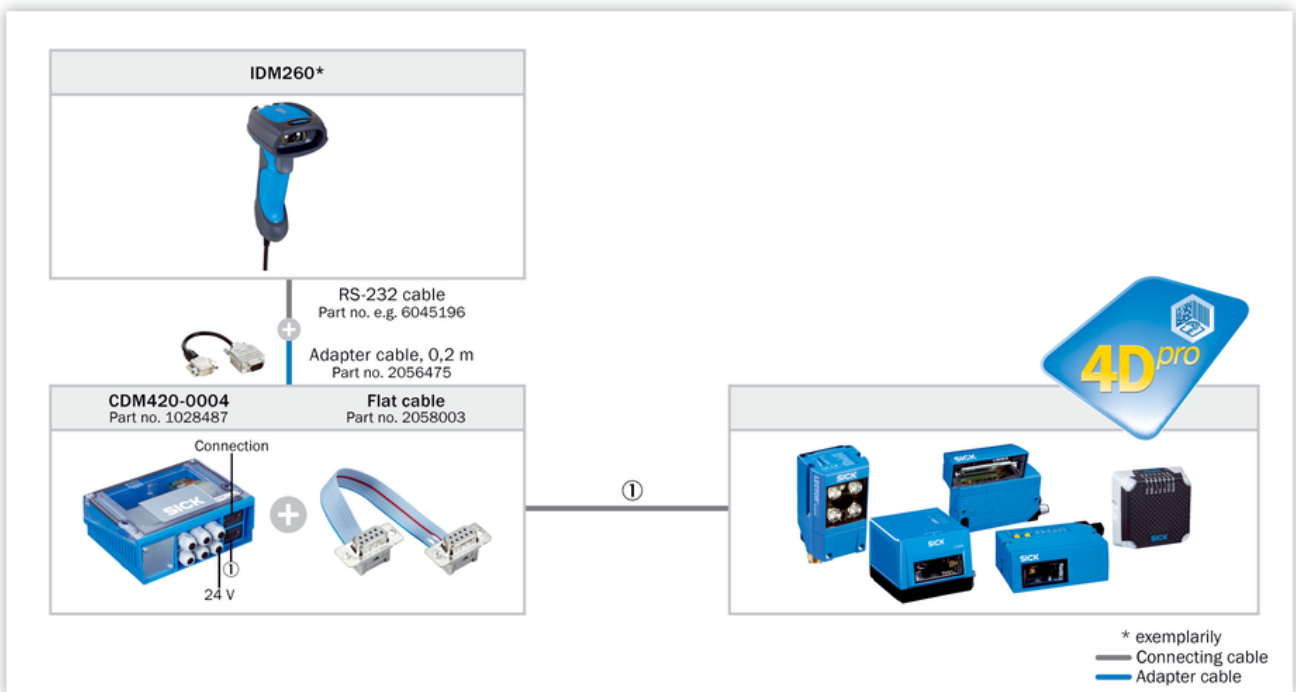

Connection diagram EtherCAT®

EtherCAT®

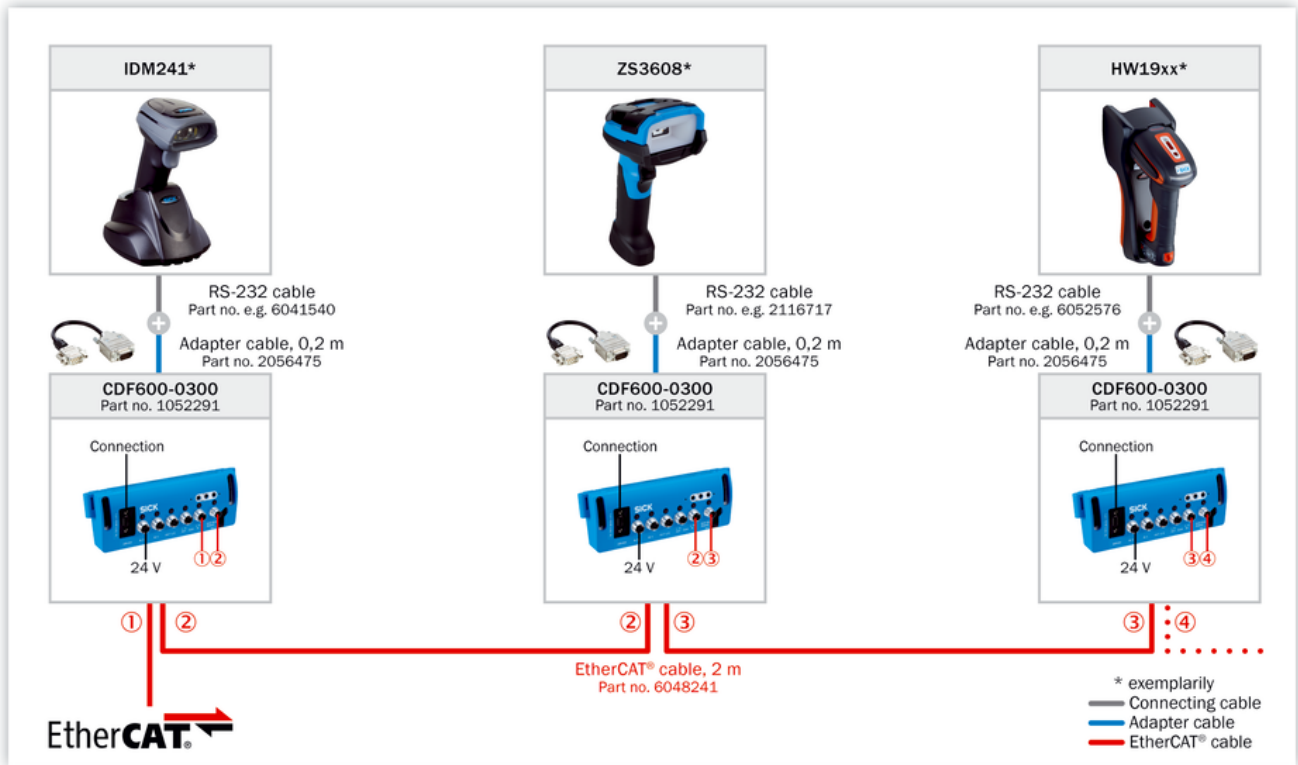

Connection diagram PROFIBUS DP

PROFIBUS DP



Connection diagram PROFINET IO/RT

PROFINET IO/RT

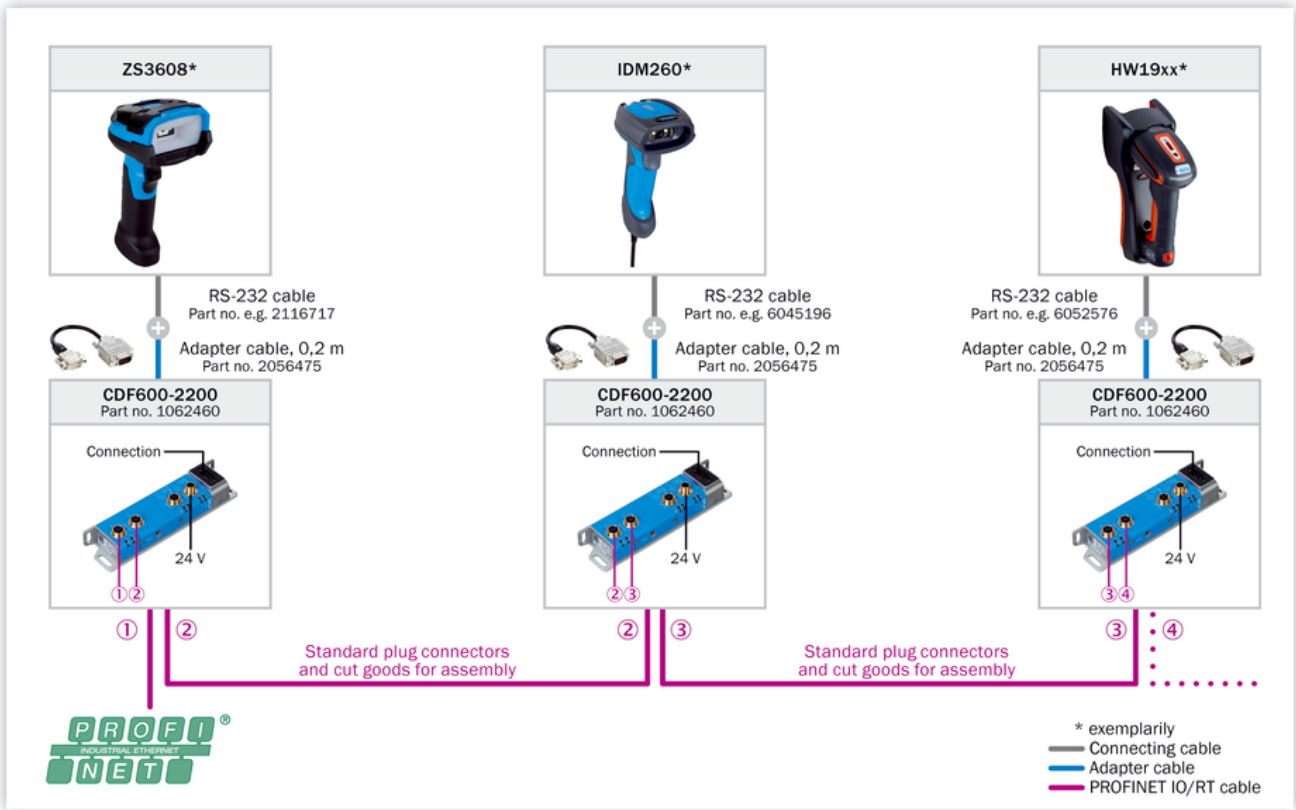

Connection diagram Ethernet TCP/IP

Ethernet TCP/IP

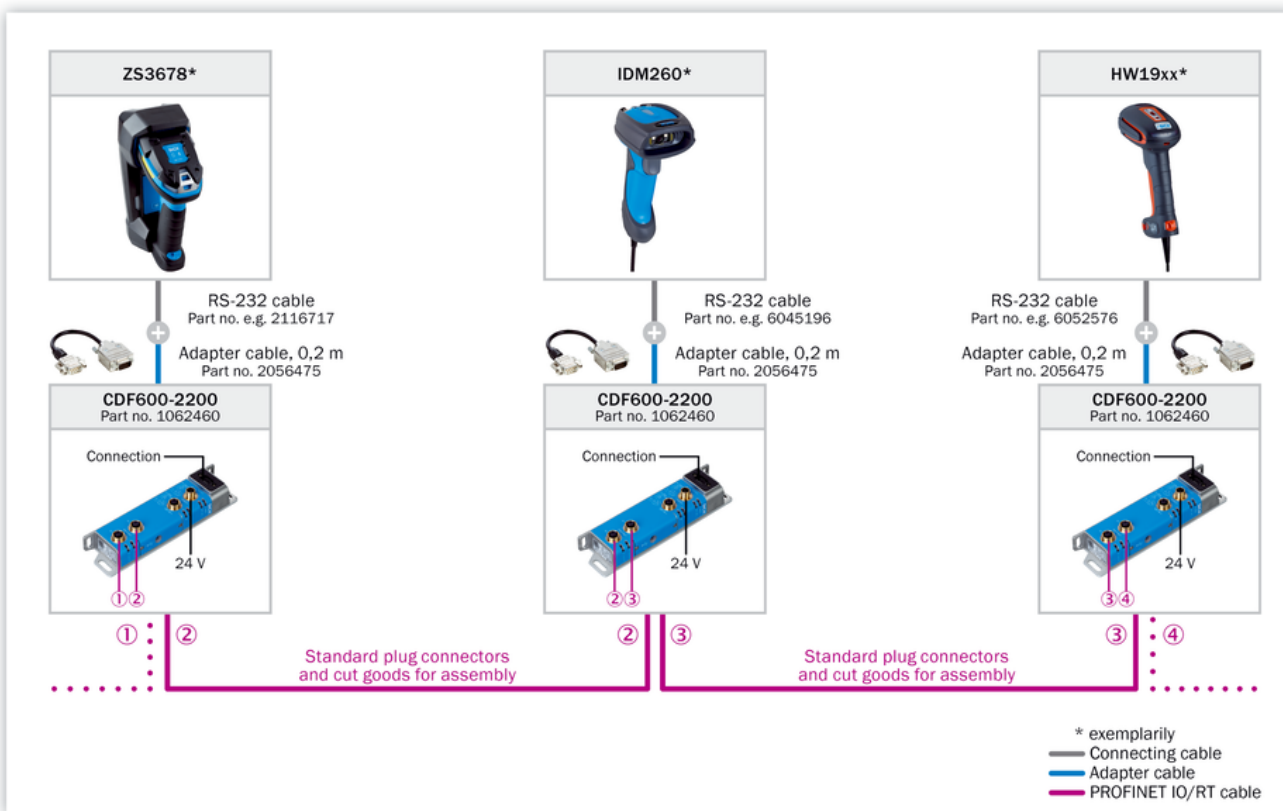

Selection Guide



\*) For EtherNet/IP third party gateway is required from e.g. Comtrol or HMS (requires local sourcing).

## Recommended accessories

Other models and accessories → [www.sick.com/IDM](http://www.sick.com/IDM)

	Brief description	Type	part no.
<b>Power supply units and power supply cables</b>			
	<ul style="list-style-type: none"> <li>• <b>Input voltage:</b> 100 V AC ... 240 V AC</li> <li>• <b>Output voltage:</b> 5 V DC</li> <li>• <b>Output current:</b> 2 A</li> <li>• <b>Description:</b> Power supply unit, input 100 ... 240 V AC, output 5 V DC/2 A (required when using the RS-232-TTL cable, does not satisfy the medical standard EN 60601 / IEC 60601)</li> </ul>	Power supply unit	6036722
<b>Mounting systems</b>			
	<ul style="list-style-type: none"> <li>• <b>Description:</b> Tripod mount</li> </ul>	Stand mount	6045193
	<ul style="list-style-type: none"> <li>• <b>Description:</b> Desk holder</li> </ul>	Table mount	6045192
<b>integration modules and adapters</b>			
	<ul style="list-style-type: none"> <li>• <b>Description:</b> Connection kit for connecting a hand-held scanner to a PROFINET (Siemens) interface</li> </ul>	Hand-held scanner PROFINET kit	1101488
<b>connectors and cables</b>			
	<ul style="list-style-type: none"> <li>• <b>Description:</b> USB, unshielded</li> <li>• <b>Connection type head A:</b> Male connector, USB-A</li> <li>• <b>Connection type head B:</b> Male connector, RJ45</li> <li>• <b>Signal type:</b> USB</li> <li>• <b>Cable:</b> 1.8 m, straightened cable</li> <li>• <b>Note:</b> For keyboard wedge or USB Com Port Emulation</li> </ul>	Connection cable	6045195
	<ul style="list-style-type: none"> <li>• <b>Connection type head A:</b> Male connector, D-Sub, 9-pin</li> <li>• <b>Connection type head B:</b> Male connector, D-Sub, 15-pin</li> <li>• <b>Items supplied:</b> Incl. 24V/5V DC converter</li> <li>• <b>Cable:</b> 0.3 m</li> <li>• <b>Note:</b> For handheld scanners to CDB620/CDM420/CDF600/CDF600-2, adapter AUX port</li> </ul>	YMH-DAC-C30XXXMSA9	2056475

## SICK AT A GLANCE

SICK is one of the leading manufacturers of intelligent sensors and sensor solutions for industrial applications. A unique range of products and services creates the perfect basis for controlling processes securely and efficiently, protecting individuals from accidents and preventing damage to the environment.

We have extensive experience in a wide range of industries and understand their processes and requirements. With intelligent sensors, we can deliver exactly what our customers need. In application centers in Europe, Asia and North America, system solutions are tested and optimized in accordance with customer specifications. All this makes us a reliable supplier and development partner.

Comprehensive services complete our offering: SICK LifeTime Services provide support throughout the machine life cycle and ensure safety and productivity.

For us, that is “Sensor Intelligence.”

## WORLDWIDE PRESENCE:

Contacts and other locations –[www.sick.com](http://www.sick.com)